



NETWORK CD RECEIVER

NC-50DAB

Instruction Manual

Pioneer

Before Start	
What's in the box	2
Part Names	
Front Panel	3
Rear Panel	4
Remote Controller	5
Display	6
Install	
Connect the Speakers	7
Connecting the antennas and power cord, etc.	8
Initial Setup	
Power On & Initial Setup	9
Playback	
Playing CDs	12
USB Storage Device/HDD	14
Internet Radio	16
Spotify	17
Listening to the FM Radio	18
Listening to DAB Digital Radio	20
BLUETOOTH®	21
AirPlay®	23
Playing audio from a turntable	24
Playing audio from other external device	25
Music Server	27
Entering text, adjusting sound quality, etc.	29
Advanced Setup	
Advanced Settings.....	30
Firmware Update	
Firmware Update	34
Others	
Troubleshooting	36
General Specifications	39
License and Trademark Information	41



What's in the box

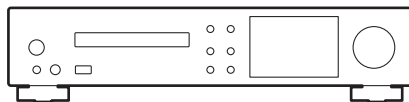

Main unit (1)

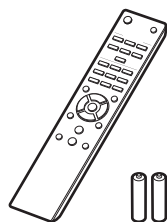

Remote controller (RC-946S) (1), Batteries (AAA/R03) (2)

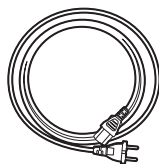

Power cord (1)

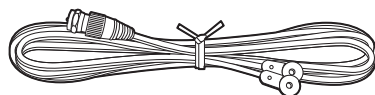

DAB/FM wire antenna (1)



- The power cord must be connected only after all other cable connections are completed.
- Connect speakers with 4 Ω to 16 Ω impedance.
- We will not accept responsibility for damage arising from the connection of equipment manufactured by other companies.
- Functionality may be introduced by firmware updates and service providers may cease services, meaning that some network services and content may become unavailable in the future.
- Specifications and appearance are subject to change without prior notice.



Front Panel

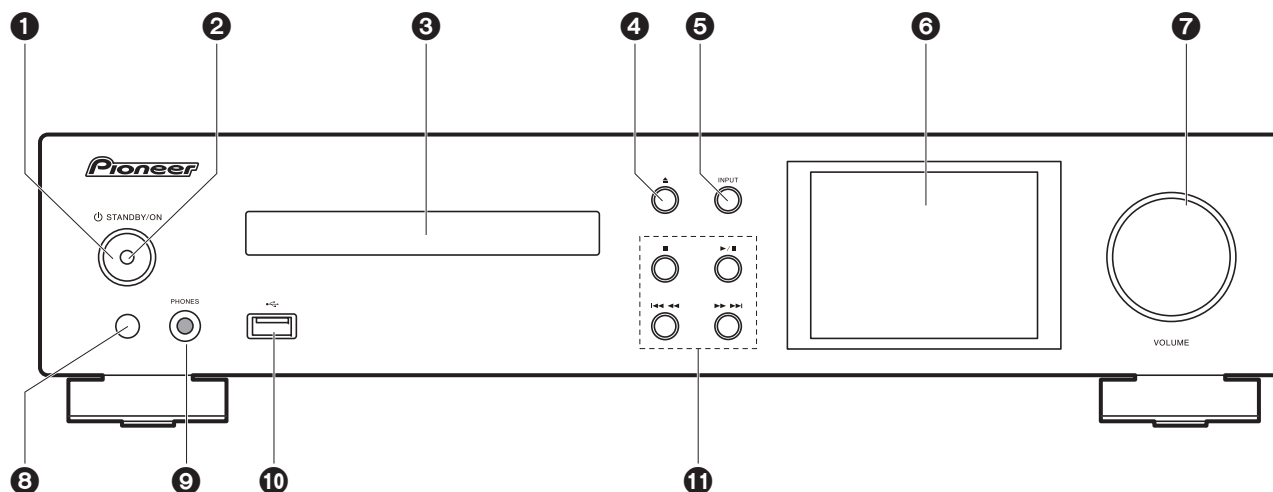

1. **⏻ STANDBY/ON button**: Turns the unit on or to standby mode.
2. **Power indicator**: This lights blue when the unit is on.
3. **Disc tray**: Place discs here. 8-cm discs can also be used.
4. **⏏ button**: Open or close the disc tray.
5. **INPUT button**: Switches the input to be played.
6. **Display (→P6)**
7. **VOLUME dial**: Adjust the volume. Adjust between 0 and 50.
8. **Remote control sensor**
9. **PHONES jack**: Connect stereo headphones with a standard plug (ø6.3 mm).
10. **USB port**: Connect a USB storage device or HDD (hard disk drive) to play music files. You can also supply power (maximum 5 V/0.5 A) to USB devices with a USB cable.
 - When connecting a HDD that requires more than 5 V/0.5 A, connect to the USB port (maximum 5 V/1 A) on the rear of the unit.
11. **Play button**:
 - : This button stops playback.

- ▶/||: This button pauses the playback.
- ◀◀◀: Return to the beginning of the track being played. Press and hold to rewind the track quickly. (CD)
 - Move to the previous track. (USB, Music Server)
- ▶▶▶: Move to the next track. Press and hold to fast-forward through the track. (CD)
 - Move to the next track. (USB, Music Server)
- Depending on the input, the operation may not start.



Rear Panel

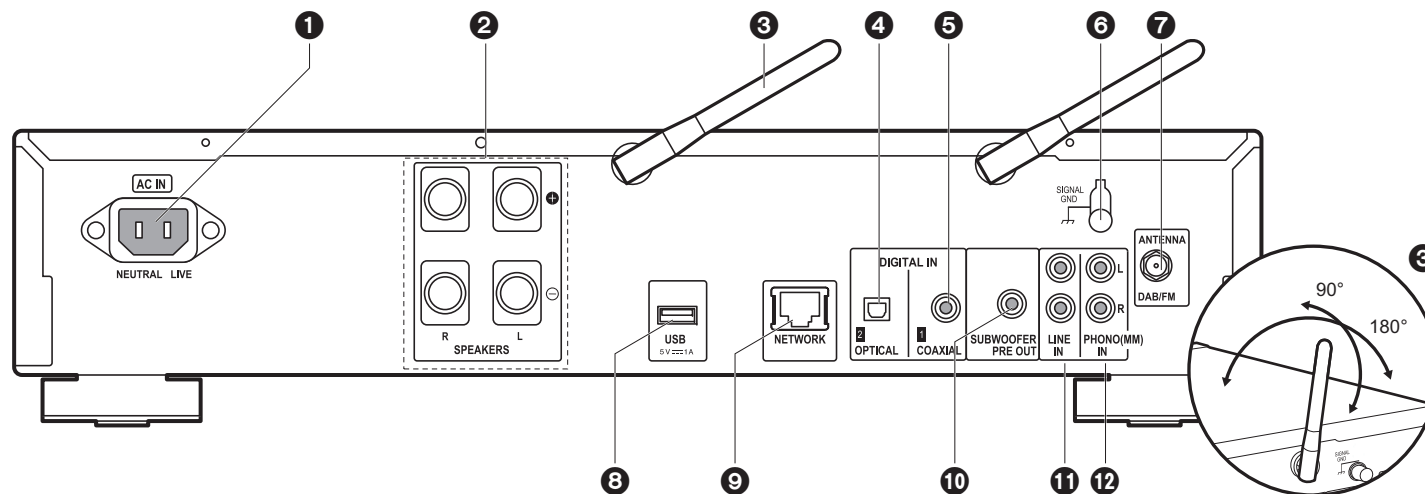

1. AC IN: Connect the supplied power cord.
2. Speaker terminals: Connect speakers with speaker cables.
3. Wireless antenna: Used for Wi-Fi connection or when using a BLUETOOTH enabled device. Adjust their angles according to the connection status.
4. DIGITAL IN OPTICAL jack: You can play the digital audio from an external device such as a television connected with a digital optical cable.
5. DIGITAL IN COAXIAL jack: You can play the digital audio from an external device such as a television connected with a digital coaxial cable.
6. SIGNAL GND terminal: Connect if the turntable connected to the PHONO (MM) IN jack has a ground wire.
7. DAB/FM ANTENNA jack: Connect the supplied DAB/FM wire antenna.
8. USB port: Connect a USB storage device or HDD (hard disk drive) to play music files. You can also supply power (maximum 5 V/1 A) to USB devices with a USB cable.
9. NETWORK jack: Connect to the network with an ethernet cable.
10. SUBWOOFER PRE OUT jacks: Connect a subwoofer with built-in amplifier.
11. LINE IN jack: You can play the audio from an external device such as a television connected with an analogue audio cable.
12. PHONO (MM) IN jacks: Connect a turntable (MM cartridge).



Remote Controller

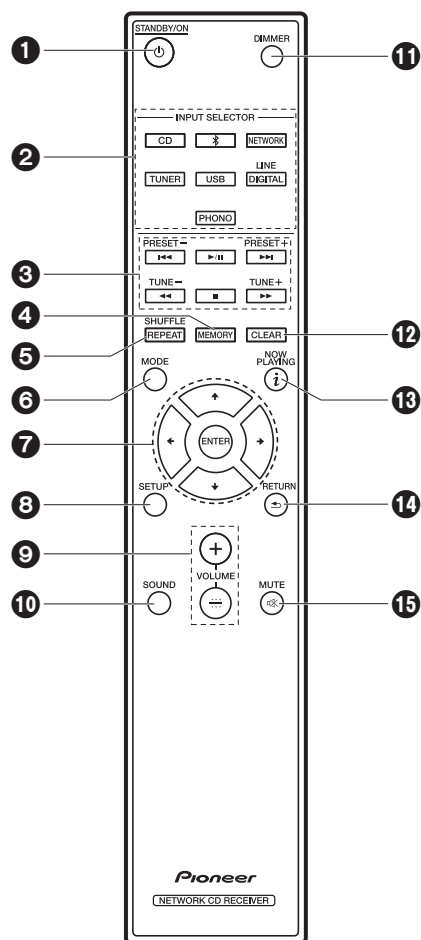

1. **STANDBY/ON** button: Turns the unit on or into standby mode.
2. **INPUT SELECTOR** buttons: Switches the input to be played.
3. **Play** buttons:
 - ◀◀: Return to the beginning of the track being played. (CD)
 - Move to the track before the one being played. (USB, Music Server)
 - ▶▶: Play or pause play.
 - ▶▶: Move to the next track.
 - ◀◀: Rewind the track quickly. (CD only)
 - : Stop playback.
 - ▶▶: Fast-forward the track. (CD only)
 - Depending on the input, the operation may not start.
- PRESET +/- buttons: Used to select stations that have been registered or to give names to stations.
- TUNE +/- buttons: Used to select radio stations.
4. **MEMORY** button: Used to register favorite radio stations.
5. **SHUFFLE/REPEAT** button: Set repeat play and shuffle play.
6. **MODE** button: Used for program play of CDs.
7. **Cursors, ENTER** button: Select the item with the cursors and press ENTER to confirm.
8. **SETUP** button: Displays the Setup menu.
9. **VOLUME +/-** buttons: Adjust the volume. Adjust between 0 and 50.
10. **SOUND** button: Adjust the sound quality.
11. **DIMMER** button: Switch the display off or adjust the brightness of the display in three steps.
12. **CLEAR** button: Used when entering text, etc.
13. **i (NOW PLAYING)** button: Switches the information on the display.
14. **RETURN** button: Returns the display to the previous state.
15. **MUTE** button: Temporarily mutes audio. Press again to cancel muting.

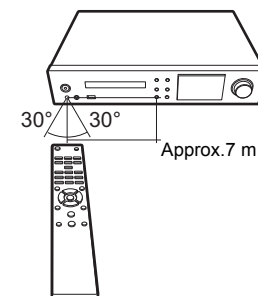



Display

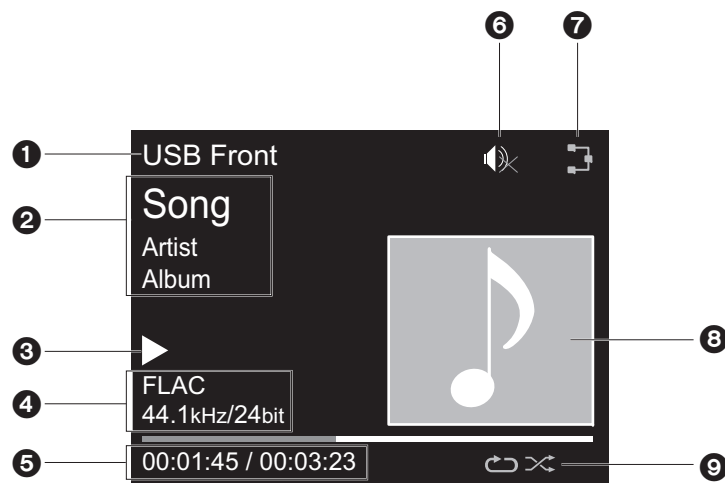

1. The input mode is displayed.
(USB Front / USB Rear / CD / Bluetooth / Network / Digital In 1 / Digital In 2 / Line / Phono / Tuner DAB / Tuner FM)
2. The name of the file, artist, album, station, etc., is displayed.
3. Displays the play status.
4. Displays file format, sampling frequency, and quantization bit information.
5. The file play status is displayed. This may not be displayed depending on the input or file.
6. This is displayed when muting is on.
7. Lights in the following conditions.
 - : When the connection setting on the unit is "Wired" and the unit is connected to the network.
 - : When the connection setting on the unit is "Wired" and the unit is not connected to the network.
 - : When the connection setting on the unit is "Wi-Fi" and the unit is connected to the network.
 - : When the connection setting on the unit is "Wi-Fi" and the unit is not connected to the network.
8. If an album jacket is recorded for the file being played, it is displayed here.
9. Lights in the following conditions.

- : When all track repeat play is on
- : When one track repeat play is on
- : When shuffle play is on

- When DIMMER is pressed to turn off the display, the unit may appear the same as if you had unplugged the unit from the power outlet, but electricity is still being supplied to the unit. To completely cut the unit off from the power supply, you need to unplug the power plug (shutoff device) unit from the power outlet.



Connect the Speakers

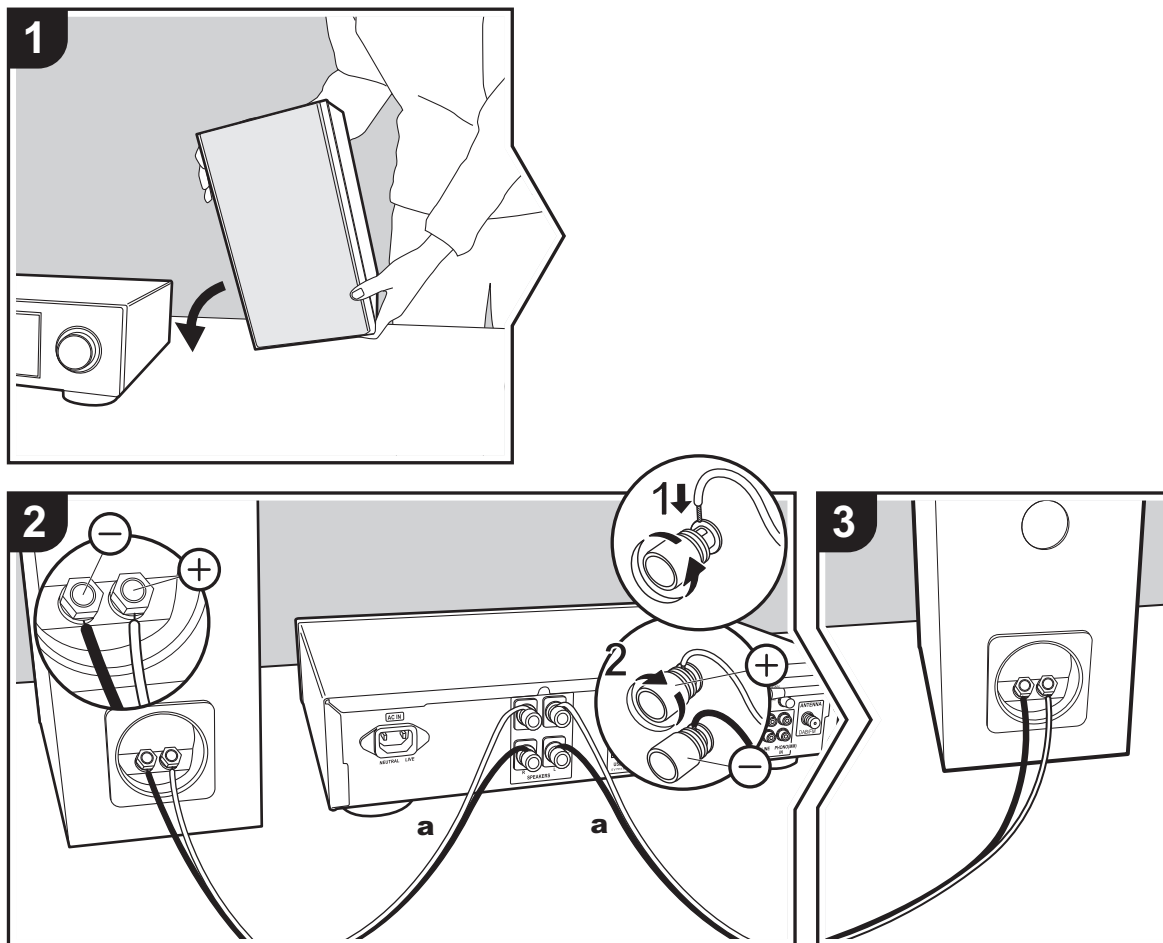

a Speaker cable

Use the illustration as a reference to connect your own speakers.

After inserting the speaker cables, tighten the terminals firmly by turning to the right. Also make sure the exposed wires of the speakers do not stick out of the speaker terminals when connecting. If the exposed wires of the speakers touch the rear panel or the + and - wires touch each other, the protection circuit may be activated and the power may turn off.

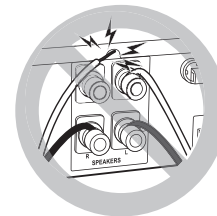

You can also connect a subwoofer with a built-in amplifier to boost bass playback even more. Use a subwoofer cable for connection.

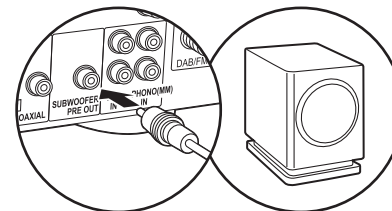



Connecting the antennas and power cord, etc.

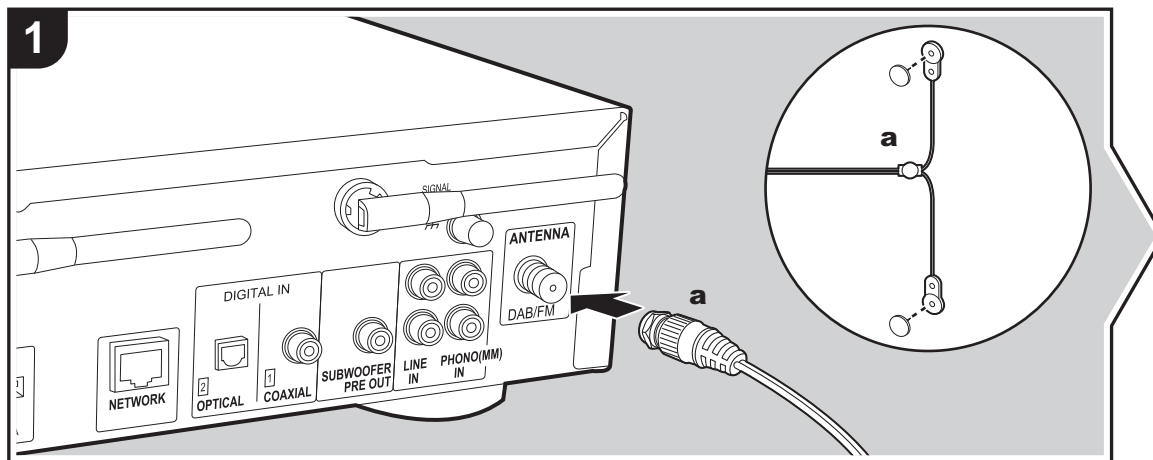

Antenna Hookup

Move the antenna around while playing the radio to find the position with the best reception.

Power Cord Hookup

This model includes a removable power cord. The power cord must be connected only after all other connections are completed. Make sure you first connect the power cord to AC IN terminal of the unit and then connect to the outlet. Always disconnect the outlet side first when disconnecting the power cord.

To connect to the network with an ethernet cable, use the NETWORK jack. When using Wi-Fi connection, make settings in initial settings (➔P9). You can enjoy features such as internet radio and AirPlay by connecting to the network.

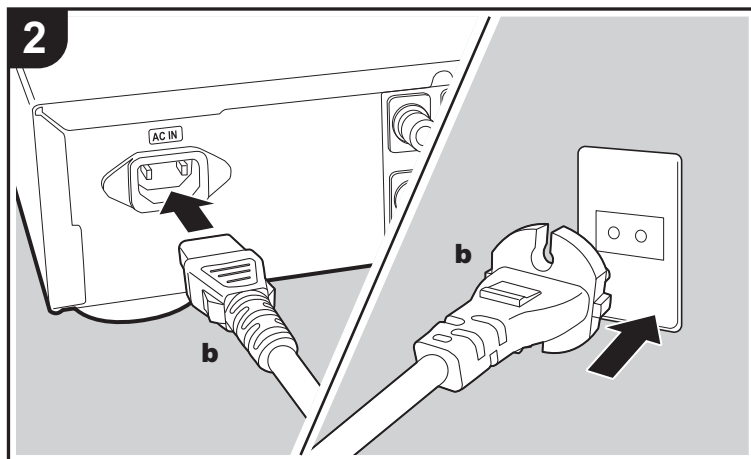

a DAB/FM wire antenna, **b** Power cord

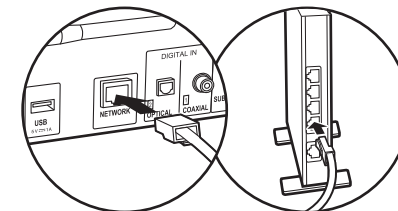



Power On & Initial Setup

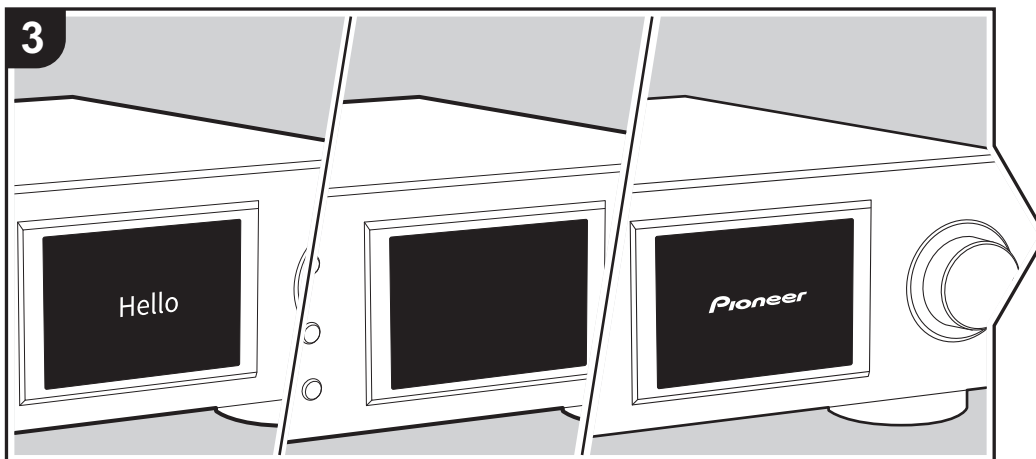
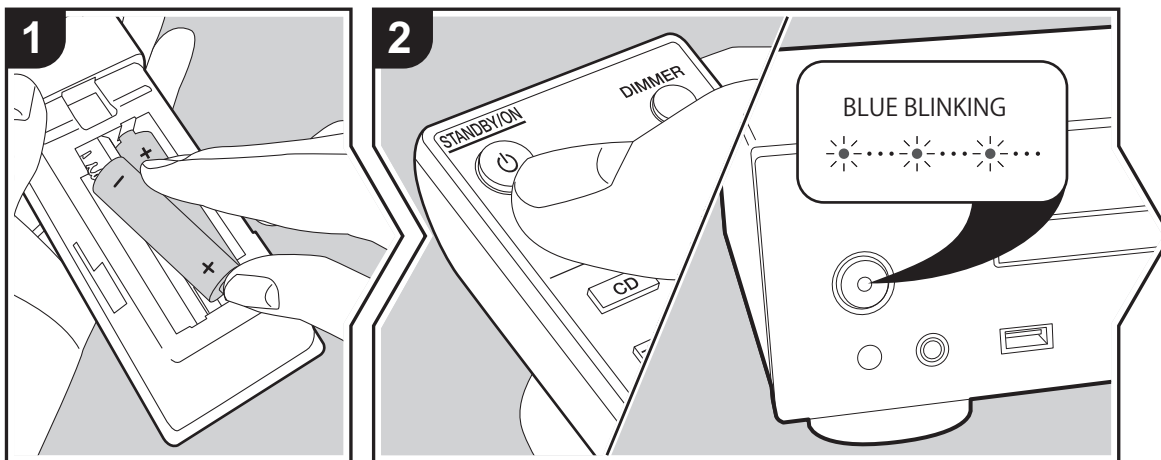

Starting up: When you press **STANDBY/ON**, the power indicator on the main unit slowly blinks blue, then "Hello" is displayed on the display about 20 seconds later. After this, the display goes blank, then after the Pioneer logo is displayed, you can start operating the unit.

Wi-Fi connection settings

When you first turn the power on, the initial setup screen is displayed automatically, allowing you to easily make Wi-Fi connection settings.

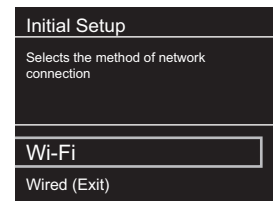

To set, select the item with the cursors on the remote controller and press **ENTER** to confirm. To return to the previous display, press **RETURN**.

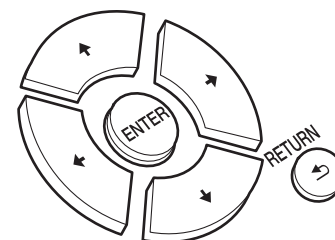



To make Wi-Fi settings, select "Wi-Fi". If you have connected with an ethernet cable, select "Wired(Exit)" and confirm. If you select "Wi-Fi", select the method for setting in the next screen (for example "Scan Networks").

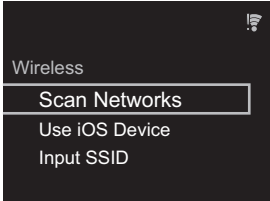

- To redo the initial settings, press SETUP on the remote controller, select "Wi-Fi" in "Network Setting" - "Connection", then select "Wi-Fi Setup".

■ Scan Networks

From the list of SSID for access points such as wireless LAN routers, select the required SSID and make the settings.

1. Select the SSID of the access point you want to connect and then confirm.

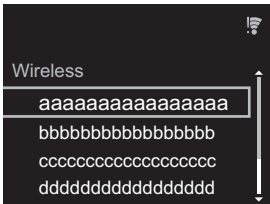

2. Select either "Enter Password" or "Push Button" and confirm. If the access point has an automatic setting button, by selecting "Push Button" you can connect without entering a password.



3. If you select "Enter Password", enter the password of the access point and press ENTER. For details on how to enter text, refer to "Entering text" (➔P29).

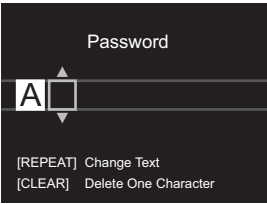

If you select "Push Button", then after pressing and holding the automatic setting button on the access point for the required amount of time, press ENTER on the remote controller.

4. is displayed when the settings are complete.



■ Use iOS Device

Set by sharing the iOS device's Wi-Fi settings with this unit.

1. Connect the iOS device by Wi-Fi.
2. Select this device in the "SET UP NEW AIRPLAY SPEAKER..." item on the screen of the iOS device and select "Next".
 - This unit is displayed as "Pioneer NC-50DAB"

XXXXXX".

3. After establishing the connection, select "Done" on the screen of the iOS device.
4. is displayed on the display of the unit when the settings are complete.



■ Enter SSID of the access point

Set by entering the SSID of the access point you want to connect.

1. Enter the SSID. For details on how to enter text, refer to "Entering text" (➔P29).

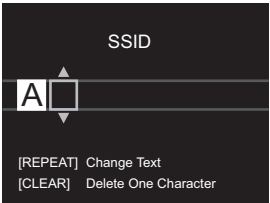

2. Select and confirm the authentication method.

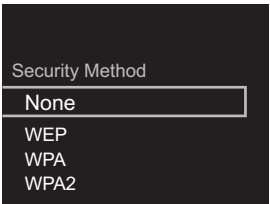

- If you select "None", proceed to step 3. If you select "WEP", "WPA", or "WPA2", enter the password and confirm.
3. is displayed when the settings are complete.





Playing CDs

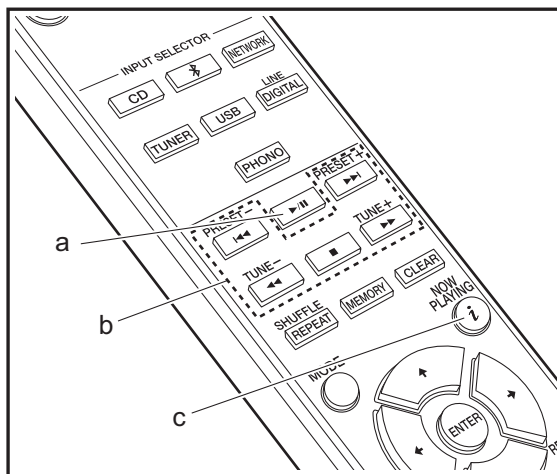
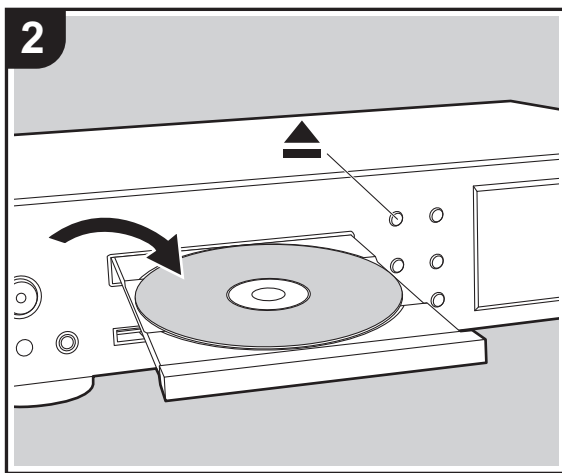
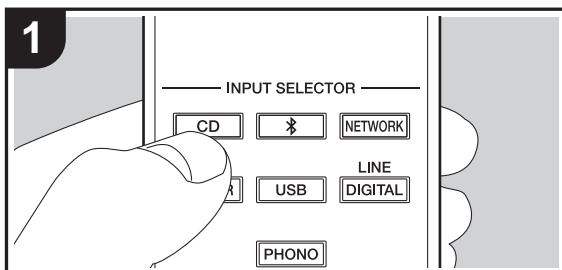

This unit can also play CD-R recorded with MP3 or WMA format files, along with commercially available music CDs.

- The supported sampling rates for MP3 files are 8 kHz to 48 kHz, and supported bitrates are between 64 kbps and 384 kbps.
- The supported sampling rates for WMA files are 32 kHz, 44.1 kHz, and 48 kHz, and supported bitrates are between 64 kbps and 320 kbps.
- Play of CDs not conforming to the CD standards, such as copy control CDs, is not guaranteed.

Playing music CDs

1. Turn the unit on.
2. Press **CD** to change input to CD.
3. Press **▲** on the main unit to open the disc tray.
4. Put the disc on the tray, then press **▲** to close the tray.
5. Press **▶/||** (a) on the remote controller to start play. Use other play buttons (b) to stop play or choose tracks to play. If you press **i** (NOW PLAYING) (c), you can switch the display to show the elapsed time or remaining time of the track.

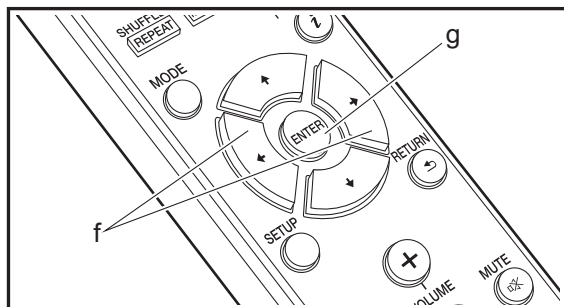
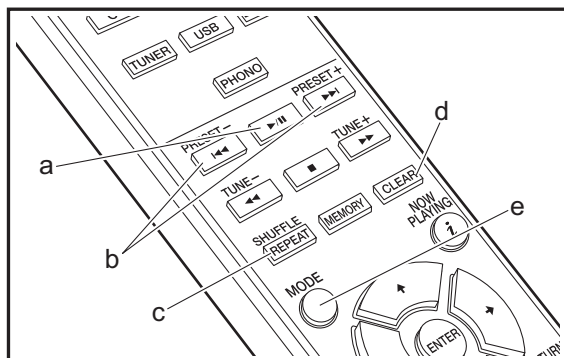

Playing MP3/WMA discs

1. Turn the unit on.
2. Press CD to change input to CD.
3. Press **▲** on the main unit to open the disc tray.
4. Put the disc on the tray, then press **▲** to close the tray.
5. When reading of the disc is complete, the numbers of folders containing MP3/WMA files and track numbers are displayed.

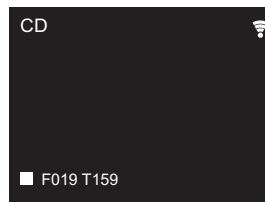

- If MP3/WMA files are stored in two or more folders, each folder is automatically allocated a number.
6. To start play, press **▶/||** (a) on the remote controller. To select a folder to play, press **◀/▶** (f) to select the folder. Play starts automatically when you select a folder.
 - Folders that do not contain music files this unit can play are skipped.
 - A maximum of 255 folders can be read. This includes folders that contain files this unit cannot play.

Program play (Music CDs)





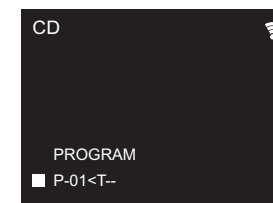

You can program up to 32 tracks to play.

1. Press MODE (e).
2. The track number (T--) flashes on the display.



3. Press **◀/▶** (b) to select the track to register and press ENTER (g). Repeat this step to register other tracks. The last track in the program is deleted if you press CLEAR (d).
4. Press **▶/||** (a) to start play.
 - If you press MODE (e) again while play is stopped, the entire program is cleared.
 - Shuffle play and 1 track repeat play cannot be used while playing a program.

Repeat play/Shuffle play

1. Repeatedly press SHUFFLE/REPEAT (c) to display , , or  on the display.
 - : Repeat play of all tracks.
 - : Repeat play of the selected individual track.
 - : Play tracks randomly.
 To cancel repeat or shuffle play, press SHUFFLE/REPEAT (c) several times until the icons disappear.



USB Storage Device/HDD

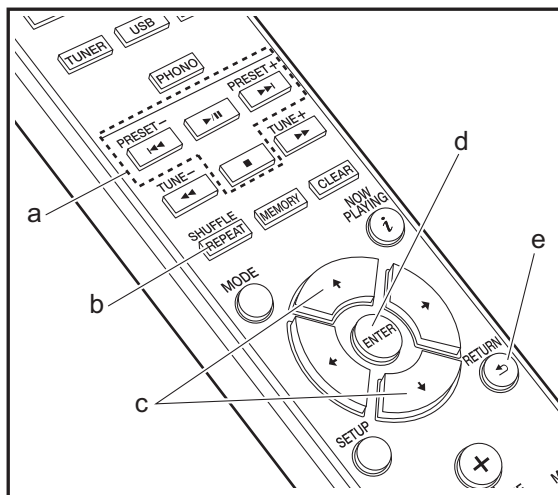
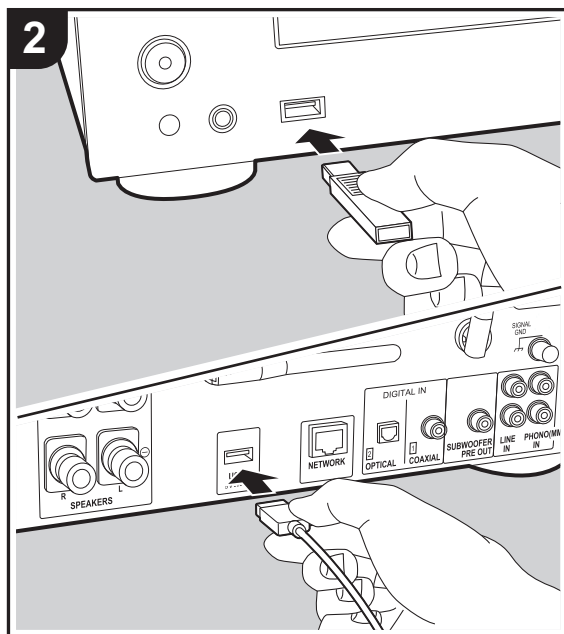
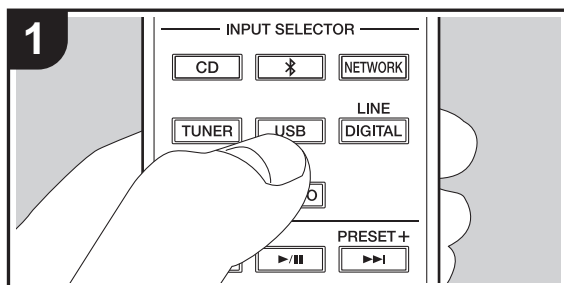

Basic operations

You can play music files by connecting a USB storage device or HDD (hard disk drive) to the USB port on the front or rear of the unit.

- The USB port on the front supports a maximum 5 V/0.5 A power supply. If the HDD requires more than this, connect to the USB port (maximum 5 V/1 A) on the rear of the unit.

1. Turn the unit on.
2. Press USB to select either "USB Front" or "USB Rear".

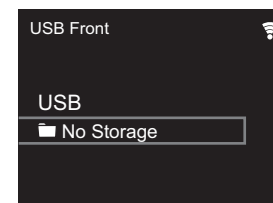

3. Plug your USB storage device or HDD into the USB port on the front or rear.
4. Folders and music files are displayed on the display when loading is complete. Press ENTER (d).

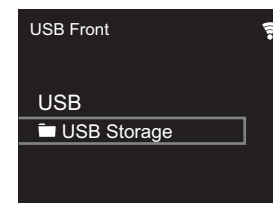

5. Select the folder or music file with the cursors (c) of the remote controller and press ENTER (d) to confirm. To return to the previous display, press RETURN (e).
6. Use play buttons (a) to stop play or choose tracks to play.
 - The display of album name, artist name, and album art is supported with MP3/WMA/Apple Lossless/FLAC/AAC/



DSD (DSF only) format music files. The formats for embedded images are JPEG and PNG.

- Characters that cannot be displayed by this unit appear as "×".
- The USB port of this unit conforms with the USB 2.0 standard. The transfer speed may be insufficient for some content you play, which may cause some interruption in sound.

Repeat/Shuffle

1. Repeatedly press SHUFFLE/REPEAT (b) during play to display , or on the display.
 : Repeat play of all tracks.
 : Repeat play of the selected individual track.
 : Play tracks in a folder randomly.
 To cancel repeat or shuffle play, press SHUFFLE/REPEAT (b) several times until the icons disappear.

USB Storage / HDD Device Requirements

- Note that operation is not guaranteed with all USB storage devices or HDD.
- This unit can use USB storage devices that comply with the USB mass storage device class standard. (However, there are still devices that cannot be played by this unit even if they comply with the USB mass storage class standard.)
- The unit is also compatible with USB storage devices using the FAT16 or FAT32 file system formats. Other formats such as exFAT, NTFS, and HFS cannot be played by this unit.
- If the USB storage device has been partitioned, each section will be treated as an independent device.
- Up to 20,000 tracks per folder can be displayed, and folders may be nested up to 16 levels deep.
- USB hubs and USB storage devices with hub functions are not supported. Do not connect these devices to the unit.

- USB storage devices with security function are not supported on this unit.
- If the USB storage device or HDD comes with an AC adapter, we recommend that you use its AC adapter to power it.
- Media inserted to the USB card reader may not be available in this function. Furthermore, depending on the USB storage device, proper reading of the contents may not be possible.
- We accept no responsibility whatsoever for the loss or damage to data stored on a USB storage device when that device is used with this unit. We recommend that you back up your important music files beforehand.

Supported Audio Formats

For server playback and playback from a USB storage device, this unit supports the following music file formats. Note that sound files that are protected by copyright cannot be played on this unit.

MP3 (.mp3/.MP3):

- Supported formats: MPEG-1/MPEG-2 Audio Layer 3
- Supported sampling rates: 44.1 kHz, 48 kHz
- Supported bitrates: Between 8 kbps and 320 kbps and VBR.

WMA (.wma/.WMA):

- Supported sampling rates: 44.1 kHz, 48 kHz
- Supported bitrates: Between 5 kbps and 320 kbps and VBR.
- WMA Pro/Voice/WMA Lossless formats are not supported

WAV (.wav/.WAV):

WAV files include uncompressed PCM digital audio.

- Supported sampling rates: 44.1 kHz, 48 kHz, 88.2 kHz, 96 kHz, 176.4 kHz, 192 kHz
- Quantization bit: 8 bit, 16 bit, 24 bit

AIFF (.aiff/.aif/.aifc/.afc/.AIFF/.AIF/.AIFC/.AFC):

AIFF files include uncompressed PCM digital audio.

- Supported sampling rates: 44.1 kHz, 48 kHz, 88.2 kHz, 96 kHz, 176.4 kHz, 192 kHz
- Quantization bit: 8 bit, 16 bit, 24 bit

AAC (.aac/.m4a/.mp4/.3gp/.3g2/.AAC/.M4A/.MP4/.3GP/.3G2):

- Supported formats: MPEG-2/MPEG-4 Audio
- Supported sampling rates: 44.1 kHz, 48 kHz, 88.2 kHz, 96 kHz
- Supported bitrates: Between 8 kbps and 320 kbps and VBR.

FLAC (.flac/.FLAC):

- Supported sampling rates: 44.1 kHz, 48 kHz, 88.2 kHz, 96 kHz, 176.4 kHz, 192 kHz
- Quantization bit: 8 bit, 16 bit, 24 bit

Apple Lossless (.m4a/.mp4/.M4A/.MP4):

- Supported sampling rates: 44.1 kHz, 48 kHz, 88.2 kHz, 96 kHz, 176.4 kHz, 192 kHz
- Quantization bit: 16 bit, 24 bit

DSD (.dsf/.dff/.DSF/.DFF):

- Supported formats: DSF/DSDIFF
- Supported sampling rates: 2.8 MHz, 5.6 MHz, 11.2 MHz



Internet Radio

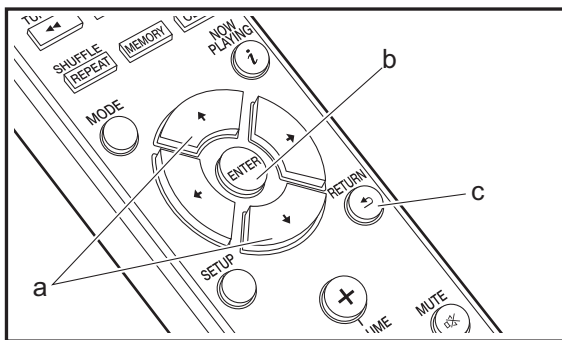
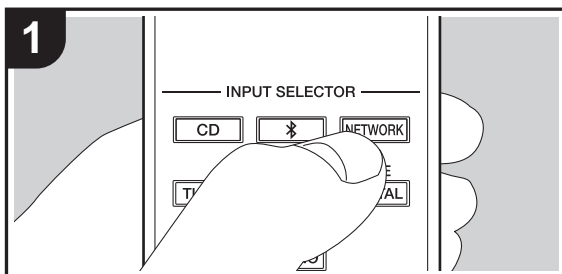

Basic operations

When this unit is connected to a network, you can listen to TuneIn or other preregistered Internet radio services. Depending on the internet radio service, the user may need to register from their computer first.

1. Turn the unit on.
2. Press NETWORK.

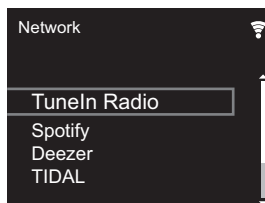

3. Select "TuneIn Radio" with the cursors (a) of the remote controller and press ENTER (b) to confirm. After switching the display to the internet radio service, you can select stations with the cursors (a) on the remote controller and press ENTER (b) to confirm. To return to the previous display, press RETURN (c).

TuneIn

You can register a station you have played as a favorite.

1. Press ENTER (b) while playing TuneIn.
2. Select "Add to My Presets" on the display and confirm.
3. To play a favorite, in the top screen of TuneIn, select the registered station in "My Presets" and confirm. To delete favorites, press ENTER (b) during play, select "Remove from My Presets" and confirm.



Spotify

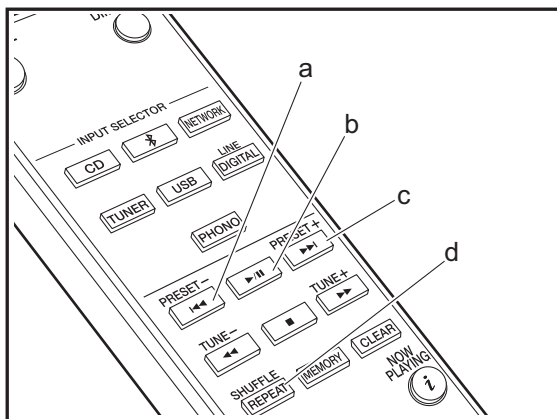
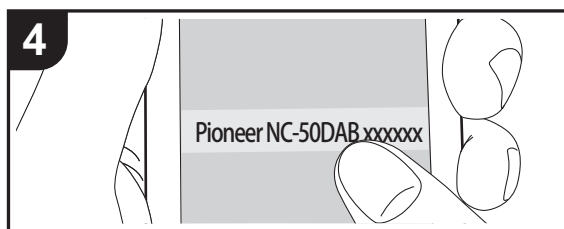
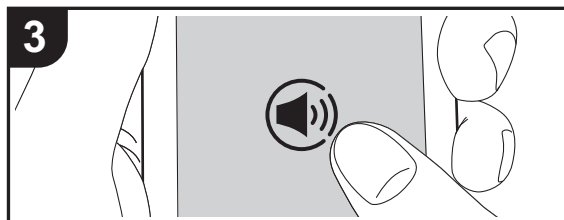
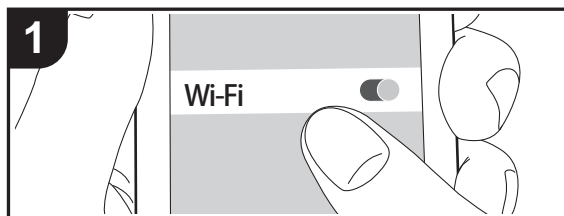

Basic Operation

Spotify Connect play is possible by connecting this unit to the same network as a smart phone or tablet. To enable Spotify Connect, install the Spotify application on your smartphone or tablet and create a Spotify premium account.

1. Connect the smartphone to the network that this unit is connected to.
2. Click the Connect icon in the track play screen of the Spotify app.
3. Select this unit.
 - This unit is displayed as "Pioneer NC-50DAB XXXXXX"
4. This unit turns on automatically and the input selector changes to NETWORK and streaming of Spotify starts.
 - If "Option Setting" - "Power Off Setting" - "Network Standby" is set to "Off" in the Setup menu, manually turn the unit on and then press NETWORK on the remote controller.
 - Refer to the following for Spotify settings:
www.spotify.com/connect/
 - The Spotify software is subject to third party licenses found here:
www.spotify.com/connect/third-party-licenses

The following remote controller operations are also possible.

- (a) This button plays the previous track.
- (b) Pressed during play this button pauses playback. Pressed while paused, and it restarts play.
- (c) This button plays the next track.
- (d) Start Repeat or Shuffle play. Pressing this button repeatedly cycles through the repeat/shuffle modes.



Listening to the FM Radio

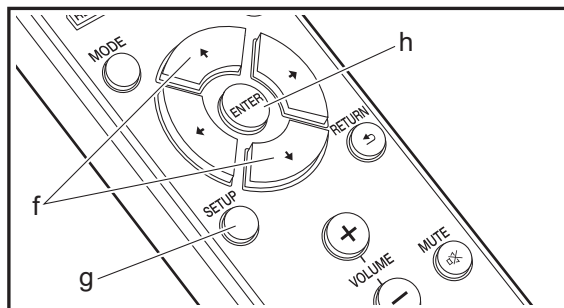
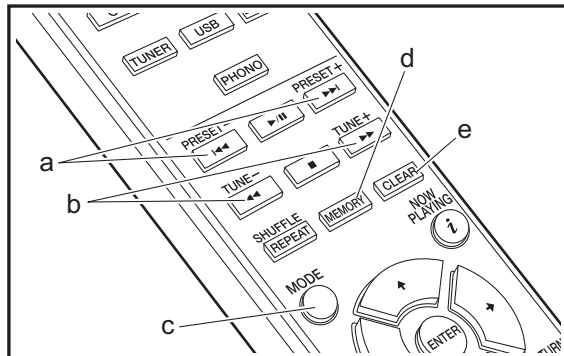
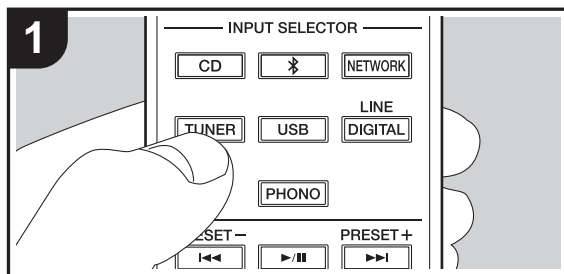

Tuning Automatically

1. Turn the unit on.
2. Repeatedly press TUNER to switch input to Tuner FM.



3. When you press TUNE +/- (b) on the remote controller, automatic tuning starts, and searching stops when a station is found. "Tuned Stereo" or "Tuned Mono" is displayed when FM stations are being received.

When FM broadcasts are difficult to receive: Perform the procedure for "Tuning Manually". If the "Tuning Mode" is set to "Manual", the reception for FM broadcasts will be monaural rather than stereo, irrespective of the sensitivity of the reception.

Tuning Manually

You will need to change the initial settings. Press SETUP (g) on the remote controller and select "Option Setting" - "Tuner Setting" - "Tuning Mode" - "Manual" on the display and confirm. Press SETUP (g) to finish the settings.

1. Turn the unit on.
2. Repeatedly press TUNER to switch input to Tuner FM.

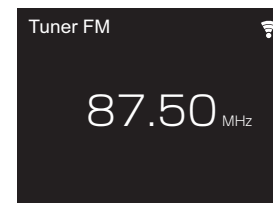

3. Select the station you want to listen to while pressing TUNE +/- (b) on the remote controller.
 - The frequency changes by 1 step each time you press the button. The frequency changes continuously if the button is held down and stops when the button is released. Tune by looking at the display.

Registering a station

You can register a maximum of 40 stations.

1. Tune into the radio station you want to register.
2. Press MEMORY (d) on the remote controller so that the preset number on the display flashes.

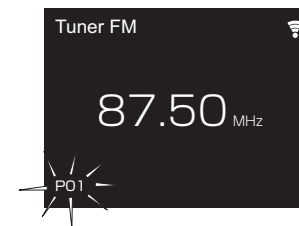

3. While the preset number is flashing (about 8 seconds), repeatedly press PRESET +/- (a) on the remote controller to select a number between 1 and 40.
4. Press MEMORY (d) on the remote controller again to register the station. When registered, the preset number stops flashing.



Selecting registered stations

1. Repeatedly press TUNER to switch input to Tuner FM.
2. Press PRESET +/- (a) on the remote controller to select a preset number.

To delete a registered station

1. Repeatedly press TUNER to switch input to Tuner FM.
2. Press PRESET +/- (a) on the remote controller to select the preset number you want to delete.
3. Press CLEAR (e) on the remote controller to delete the preset number.

To give a name to a registered station

1. Repeatedly press TUNER to switch input to Tuner FM.
2. Press PRESET +/- (a) on the remote controller to select a preset number.
3. Press SETUP (g) on the remote controller.
4. Press $\blacktriangle/\blacktriangledown$ (f) on the remote controller to select "Option Setting" - "Tuner Setting" - "Preset Name" and press ENTER (h).
5. Enter a name for the station. For details on how to enter text, refer to "Entering text" (→P29).

Using RDS

RDS stands for Radio Data System and is a method of transmitting data in FM radio signals. In regions using RDS, the radio station name is displayed when you tune into a radio station broadcasting program information. When you press MODE (c) on the remote controller in this state, you can use the following functions.

Displaying text information (Radio Text)

1. While the name of the station is being displayed on the display, press MODE (c) on the remote controller once. Radio Text (RT) broadcast by the station is displayed scrolling across the display. "Not RDS" is displayed when no text information is available.
- Unusual characters may be displayed when the unit

receives unsupported characters. However, this is not a malfunction. Also, if the signal from a station is weak, information may not be displayed.

Search for stations by Program Type

1. While the name of the station is being displayed on the display, press MODE (c) on the remote controller twice.
2. Press the PRESET +/- (a) on the remote controller to select the Program Type you want to find, then press ENTER (h) to start the search.

The Program Types displayed are as follows:

None
 News (News reports)
 Current affair
 Information
 Sport
 Education
 Drama
 Cultures
 Science (Science and technology)
 Varied speech
 Pop music
 Rock music
 Easy listening
 Light classics
 Serious classi (Serious classics)
 Other music
 Weather & metr
 Finance
 Children's pro (Children's programmes)
 Social affairs
 Religion
 Phone in
 Travel & touri
 Leisure & hobb
 Jazz music
 Country music
 Nation music
 Oldies music

Folk music
 Documentary

- The information displayed may sometimes not match the content being broadcast by the station.
3. "FINISH" is displayed when a station is found and the frequency display flashes. Press ENTER (h) while this is happening to start receiving that station. If you don't press ENTER (h), the unit continues to search for another station.
- If no stations are found, the message "Not Found" is displayed.
 - Unusual characters may be displayed when the unit receives unsupported characters. However, this is not a malfunction. Also, if the signal from a station is weak, information may not be displayed.



Listening to DAB Digital Radio

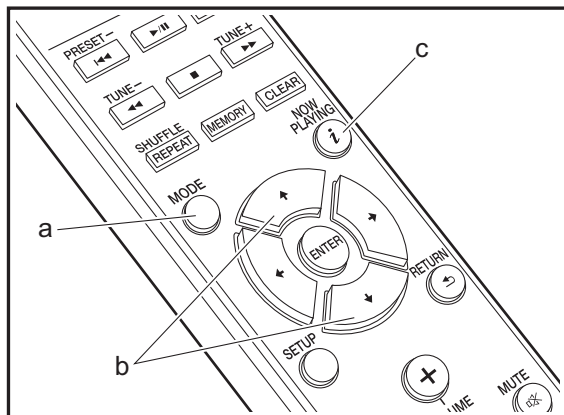
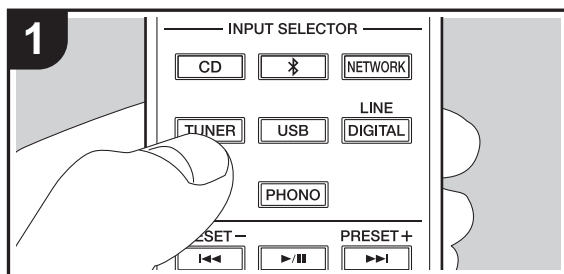

Tuning

1. Turn the unit on.
2. Repeatedly press TUNER to switch input to Tuner DAB.
 - The very first time you select Tuner DAB, the Auto Tuning function automatically scans the DAB Band 3 for the multiplexes (i.e., stations) available in your area.

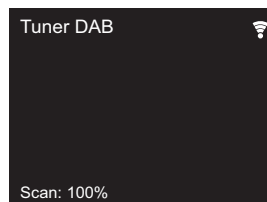

- Once the scanning process is complete, the first station that was detected is selected.
 - If a new DAB station is introduced, or you move to a new area, press SETUP on the remote controller, then use "DAB Scan" in "Option Setting" - "Tuner Setting".
3. Select the desired radio station with the cursors (b) on the remote controller.

Changing the order stations are displayed

You can sort the available stations alphabetically or by multiplex.

1. Press MODE (a) repeatedly to set the method for sorting the display order from the following.
 - Alphabet (default setting)** : Sort stations alphabetically.
 - Multiplex** : Sort stations by multiplex.

Displaying DAB Radio Information

1. Press the *i* (NOW PLAYING) button (c) repeatedly to display more information about the selected DAB station.

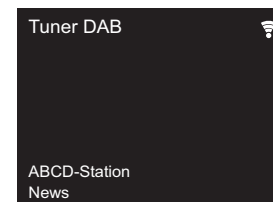

DLS (Dynamic Label Segment) : When tuned to a station that's broadcasting DLS text data, the text will scroll across the display.

Program Type : Displays the type of program.

Bit Rate and Audio Mode : Displays the station's bit rate and audio mode (Stereo, Mono).

Quality : Displays the signal quality.

0 - 59: Poor reception

60 - 79: Good reception

80 - 100: Excellent reception

Multiplex Name : Displays the name of the current multiplex.

Multiplex Number and Frequency : Displays the number and frequency of the current multiplex.



BLUETOOTH®

Pairing

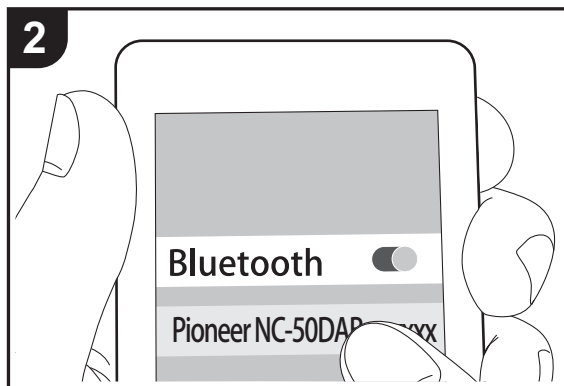
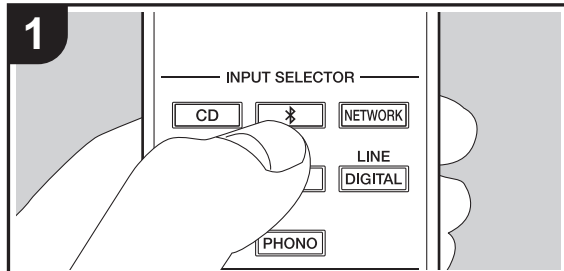

Playing Back

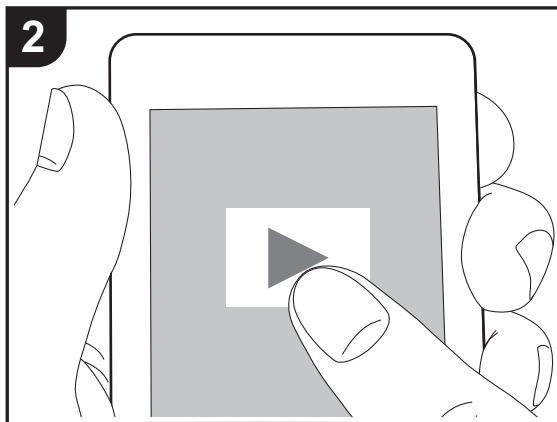
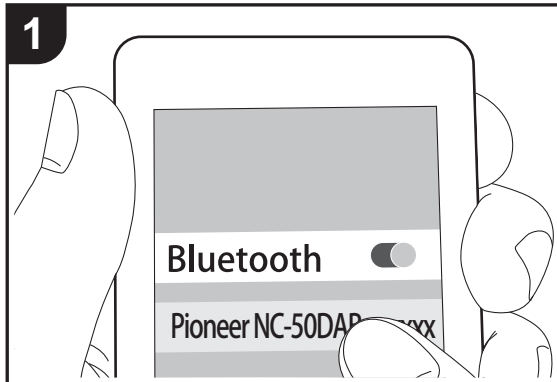

Pairing

1. Turn the unit on.
2. When you press the button on the remote controller, "Now Pairing..." is displayed on the display, and the pairing mode is enabled.

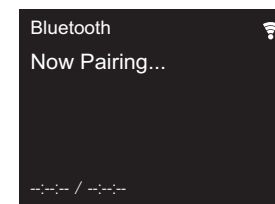

3. Enable (turn on) the BLUETOOTH function of the BLUETOOTH enabled device, then select this unit from amongst the devices displayed. If a password is requested, enter "0000".
 - This unit is displayed as "Pioneer NC-50DAB XXXXXX".
4. "Now Pairing..." on the display changes to the name of the BLUETOOTH enabled device.
 - To connect another BLUETOOTH enabled device, press and hold the button until "Now Pairing..." is displayed, then perform step 3 above. This unit can store the data of up to eight paired devices.
 - The coverage area is 10 meters. Note that connection is not always guaranteed with all BLUETOOTH enabled devices.

Playing Back

1. Turn the unit on.
2. Perform the connection procedure on the BLUETOOTH enabled device.
3. The input selector on this unit automatically switches to "Bluetooth".



4. Play the music files. Increase the volume of the BLUETOOTH enabled device to an appropriate level.
 - Due to the characteristics of BLUETOOTH wireless technology, the sound produced on this unit may slightly be behind the sound played on the BLUETOOTH enabled device.



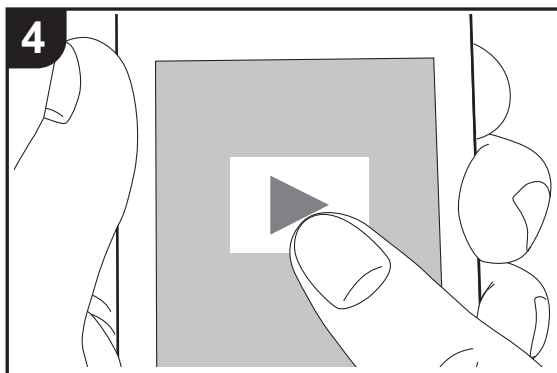
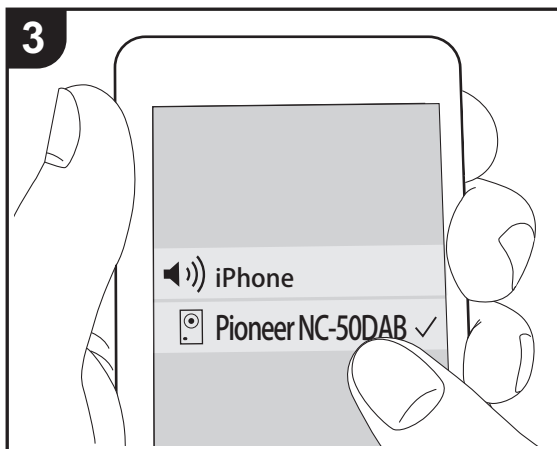
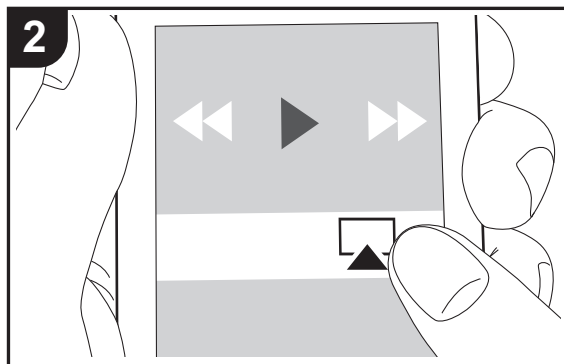
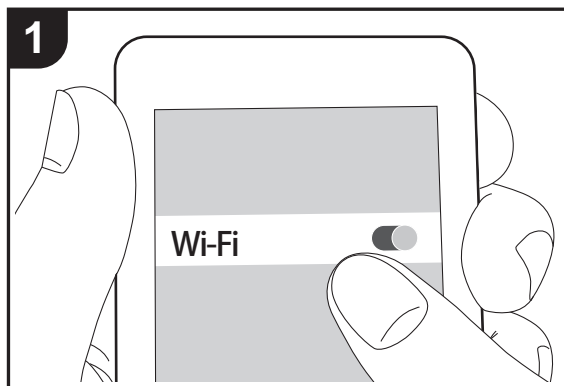

AirPlay®



Basic Operation

You can wirelessly enjoy the music files on an iPhone®, iPod touch®, or iPad® connected to the same access point as this unit. Update the OS version on your iOS device to the latest version.

1. Turn the unit on.
2. Connect the iOS device to the same network as this unit.
3. Tap the AirPlay icon  in the control center of the iOS device and select this unit from the list of devices displayed, and tap "Done".
 - This unit is displayed as "Pioneer NC-50DAB XXXXXX".
 - If an "AirPlay Password" has been set on this unit, enter the password you set.
4. Play the music files on the iOS device.
 - In the Setup menu displayed by pressing SETUP on the remote controller, when "Option Setting" - "Power Off Setting" - "Network Standby" is set to "On", when play of AirPlay starts, this unit turns on automatically and play starts.
 - Due to the characteristics of AirPlay wireless technology, the sound produced on this unit may slightly be behind the sound played on the AirPlay-enabled device.
 - SHUFFLE/REPEAT on the remote controller does not work. Operate from the iOS device.

You can also play the music files on a computer with iTunes (Ver. 10.2.2 or later). Make sure this unit and the computer are connected to the same network, click the AirPlay icon  in iTunes, select this unit from the list of devices displayed, and start play of a music file.



Playing audio from a turntable

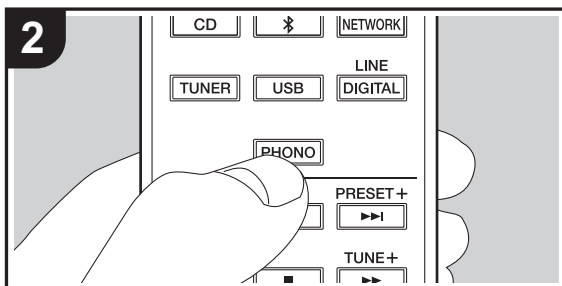
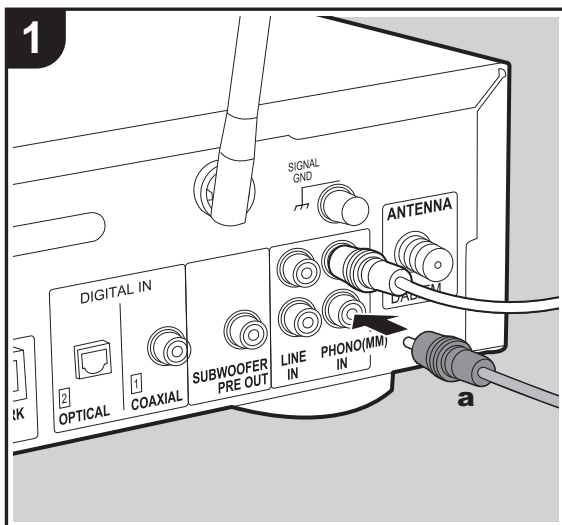

Connections

You can play the audio from turntables with MM cartridges through this unit.



Connect a turntable to the PHONO (MM) IN jacks on this unit using an analog audio cable.

- If the connected turntable has a built-in audio equalizer, connect it to the LINE IN jack.
- If the turntable has a ground wire, connect it to the SIGNAL GND terminal.

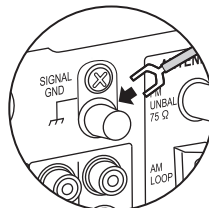

Playing Back

1. Turn the unit on.
2. Press PHONO to change input to Phono In.

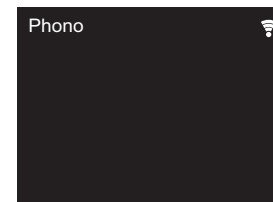

3. Start play on the turntable.

a Analog audio cable

Playing audio from other external device

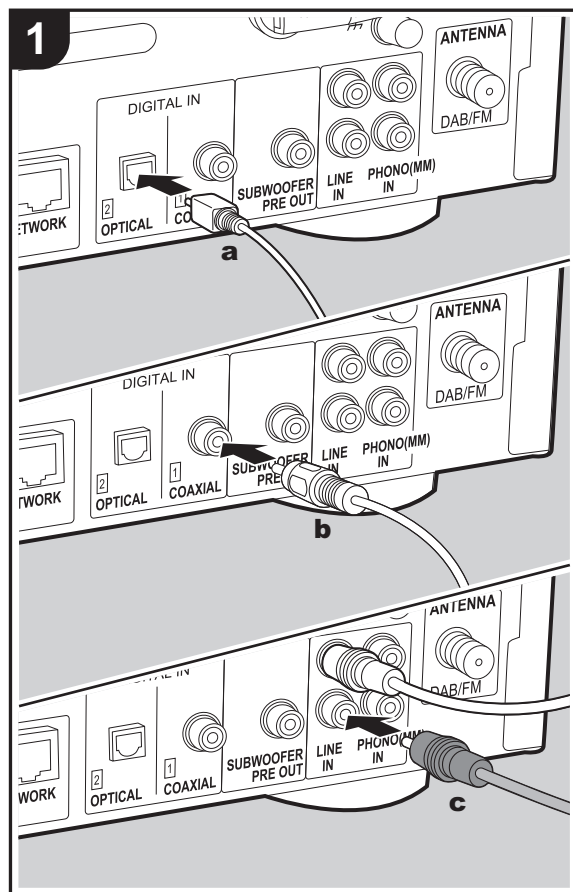

a Digital optical cable, **b** Digital coaxial cable, **c** Analog audio cable

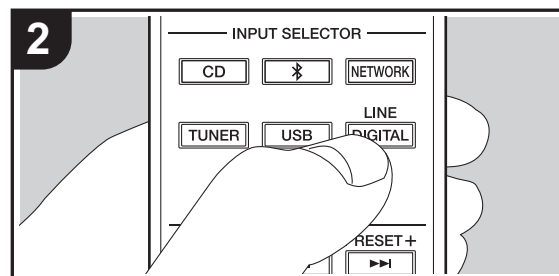

Connections

You can play the audio from external devices such as TVs and game consoles through this unit. Connect as follows according to the output jacks on the external devices you are connecting.

When using a digital optical cable, connect to the DIGITAL IN OPTICAL terminal on this unit.

When using a digital coaxial cable, connect to the DIGITAL IN COAXIAL terminal on this unit.

When using an analog audio cable, connect to the LINE IN jacks on this unit.

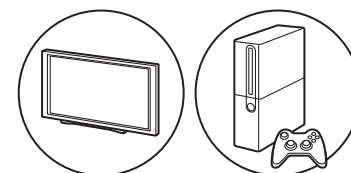

Playing Back

1. Turn the unit on.
2. When playing a device connected to the DIGITAL IN OPTICAL terminal, press LINE/DIGITAL repeatedly to change the input on this unit to "Digital In 2".

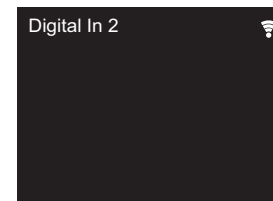

When playing a device connected to the DIGITAL IN COAXIAL terminal, press LINE/DIGITAL repeatedly to change the input on this unit to "Digital In 1".

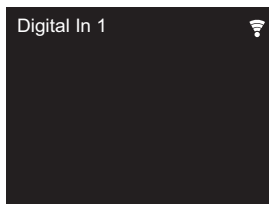

When playing a device connected to the LINE IN terminal, press LINE/DIGITAL repeatedly to change the input on this unit to "Line".

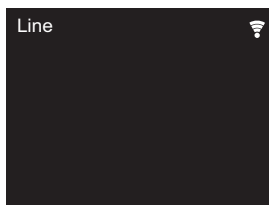

3. Start play on the player.

- This unit supports linear PCM signals of up to 192 kHz/24 bits for input. (Depending on the connected equipment and the environment it may not work.)



Music Server

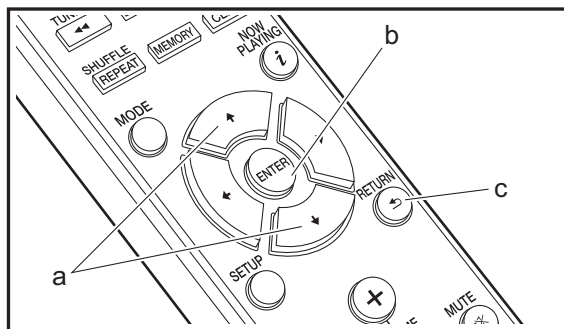
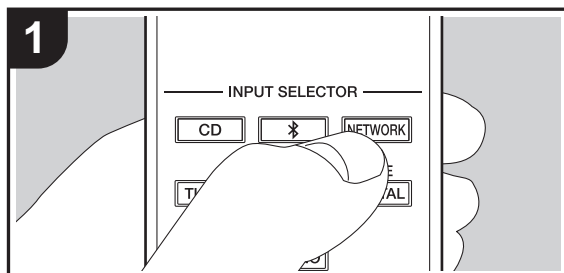

It is possible to stream music files stored on PCs or NAS devices connected to the same network as this unit. The network servers this unit is compatible with are those PCs with players installed that have the server functionality of Windows Media® Player 11 or 12, or NAS that are compatible with home network functionality. You may need to make some settings in advance to use Windows Media® Player 11 or 12. Note that only music files registered in the library of Windows Media® Player can be played.

Configuring Windows Media® Player

■ Windows Media® Player 11

1. Turn on your PC and start Windows Media® Player 11.
2. In the "Library" menu, select "Media Sharing" to display a dialog box.
3. Select the "Share my media" check box, and then click "OK" to display the compatible devices.
4. Select this unit, click "Allow" and put a check mark next to the icon for this unit.
5. Click "OK" to close the dialog.
 - Depending of the version of Windows Media® Player, there may be differences in the names of items you can select.

■ Windows Media® Player 12

1. Turn on your PC and start Windows Media® Player 12.
2. In the "Stream" menu, select "Turn on media streaming" to display a dialog box.
 - If media streaming is already turned on, select "More streaming options..." in the "Stream" menu to list players in the network, and then go to step 4.
3. Click "Turn on media streaming" to list players in the network.
4. Select this unit in "Media streaming options" and check that it is set to "Allow".
5. Click "OK" to close the dialog.
 - Depending of the version of Windows Media® Player,

there may be differences in the names of items you can select.

Playing

1. Turn the unit on.
2. Start the server (Windows Media® Player 11, Windows Media® Player 12, or NAS device) containing the music files to play.
3. Make sure that the PCs and/or NASs are properly connected to the same network as this unit.
4. Press NETWORK to display the network service list screen.

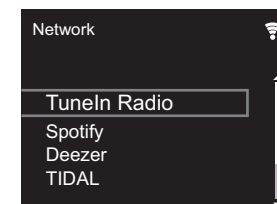

5. With ▲/▼ (a), select "Music Server", and then press ENTER (b).
6. Select the server and music file with ▲/▼ (a) and press ENTER (b) to confirm. To return to the previous display, press RETURN (c).
 - If "No Server" is displayed, check whether the network is properly connected.
 - Depending on the server being used and the files played, elapsed play time and remaining play time may not be displayed.
 - For music files on a server, there can be up to 20,000 tracks per folder, and folders may be nested up to 16 levels deep.

Controlling Remote Playback from a PC



You can use this unit to play music files stored on your PC by operating the PC inside your home network. The unit supports remote playback with Windows Media® Player 12.

1. Turn on your PC and start Windows Media® Player 12.
2. Open the "Stream" menu and check that "Allow remote control of my Player..." is checked. Click "Turn on media streaming" to list players in the network.
3. Select and right-click the music file to play with Windows Media® Player 12. To remotely play a music file on another server, open the target server from "Other Libraries" and select the music file to play.
4. Select this unit in "Play to" to open the "Play to" window of Windows Media® Player 12 and start playback on the unit. If your PC is running on Windows® 8.1, click "Play to", and then select this unit. If your PC is running on Windows® 10, click "Cast to Device", and select this unit. Operations during remote playback are possible from the "Play to" window on the PC.
5. Adjust the volume using the volume bar on the "Play to" window.
 - Sometimes, the volume displayed on the remote playback window may differ from that appeared on the display of the unit. Also, when the volume is adjusted from this unit, this is not reflected in the "Play to" window.
 - Remote playback is not possible when using a network service or playing music files on a USB storage device.
 - Depending of the version of Windows Media® Player, there may be differences in the names of items you can select.

Supported Audio Formats

For server playback and playback from a USB storage device, this unit supports the following music file formats.

- Note that playback via wireless LAN of sampling rates of 88.2 kHz or higher, and DSD are not supported.
- Remote play of FLAC, and DSD is also not supported.
- Variable bit-rate (VBR) files are supported. However,

playback times may not be displayed correctly.

- Remote playback does not support the gapless playback.

MP3 (.mp3/.MP3):

- Supported formats: MPEG-1/MPEG-2 Audio Layer-3
- Supported sampling rates: 44.1 kHz, 48 kHz
- Supported bitrates: Between 8 kbps and 320 kbps and VBR.

WMA (.wma/.WMA):

- Supported sampling rates: 44.1 kHz, 48 kHz
- Supported bitrates: Between 8 kbps and 320 kbps and VBR.
- WMA Pro/Voice/WMA Lossless formats are not supported.

WAV (.wav/.WAV):

WAV files include uncompressed PCM digital audio.

- Supported sampling rates: 44.1 kHz, 48 kHz, 88.2 kHz, 96 kHz, 176.4 kHz, 192 kHz
- Quantization bit: 8 bit, 16 bit, 24 bit

AIFF (.aiff/.aif/.aifc/.afc/.AIFF/.AIF/.AIFC/.AFC):

AIFF files include uncompressed PCM digital audio.

- Supported sampling rates: 44.1 kHz, 48 kHz, 88.2 kHz, 96 kHz, 176.4 kHz, 192 kHz
- Quantization bit: 8 bit, 16 bit, 24 bit

AAC (.aac/.m4a/.mp4/.3gp/.3g2/.AAC/.M4A/.MP4/.3GP/.3G2):

- Supported formats: MPEG-2/MPEG-4 Audio
- Supported sampling rates: 44.1 kHz, 48 kHz, 88.2 kHz, 96 kHz
- Supported bitrates: Between 8 kbps and 320 kbps and VBR.

FLAC (.flac/.FLAC):

- Supported sampling rates: 44.1 kHz, 48 kHz, 88.2 kHz, 96 kHz, 176.4 kHz, 192 kHz
- Quantization bit: 8 bit, 16 bit, 24 bit

LPCM (Linear PCM):

- Supported sampling rates: 44.1 kHz, 48 kHz
- Quantization bit: 16 bit

Apple Lossless (.m4a/.mp4/.M4A/.MP4):

- Supported sampling rates: 44.1 kHz, 48 kHz, 88.2 kHz, 96 kHz, 176.4 kHz, 192 kHz
- Quantization bit: 16 bit, 24 bit

DSD (.dsf/.dff/.DSF/.DFF):

- Supported formats: DSF/DSDIFF
- Supported sampling rates: 2.8 MHz, 5.6 MHz, 11.2 MHz



Entering text, adjusting sound quality, etc.

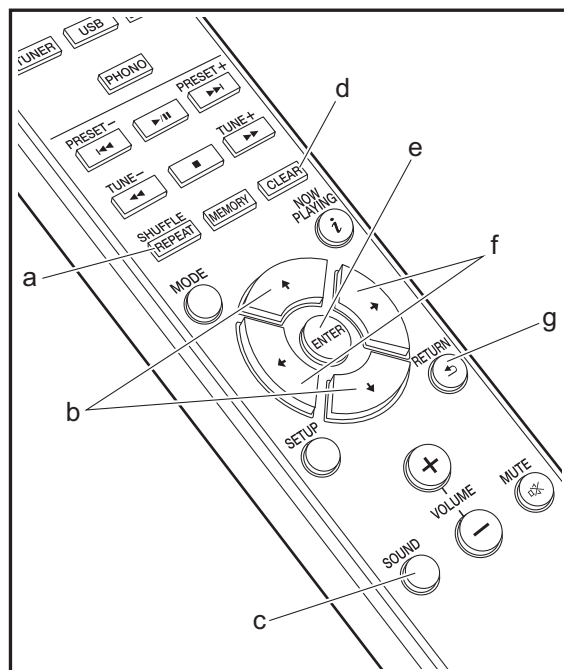

Entering text

Text entry, for passwords, etc., uses the following remote controller buttons.

SHUFFLE/REPEAT button (a): Each press changes text type in the order upper case → lower case → numbers → symbols.

+/- buttons (b): Each press changes the character.

←/→ buttons (f): Move the position (cursor position) where the character is to be entered.

CLEAR button (d): Deletes the character in the cursor position.

ENTER button (e): Confirms the entered content.

RETURN button (g): Cancels input and returns you to the previous display.

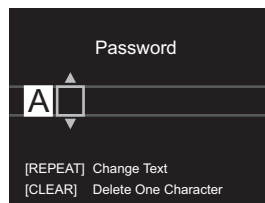

Emphasizing the low range (P.BASS)

1. Press SOUND button (c) three times.
2. Press ←/→ buttons (f) to select "On" and press ENTER (e).

Adjusting the sound quality

Adjusting the bass (BASS)

1. Press SOUND button (c).
2. Press ←/→ buttons (f) to adjust the bass. (−5 to +5)

Adjusting the treble (TREBLE)

1. Press SOUND button (c) twice.
2. Press ←/→ buttons (f) to adjust the treble. (−5 to +5)



Advanced Settings

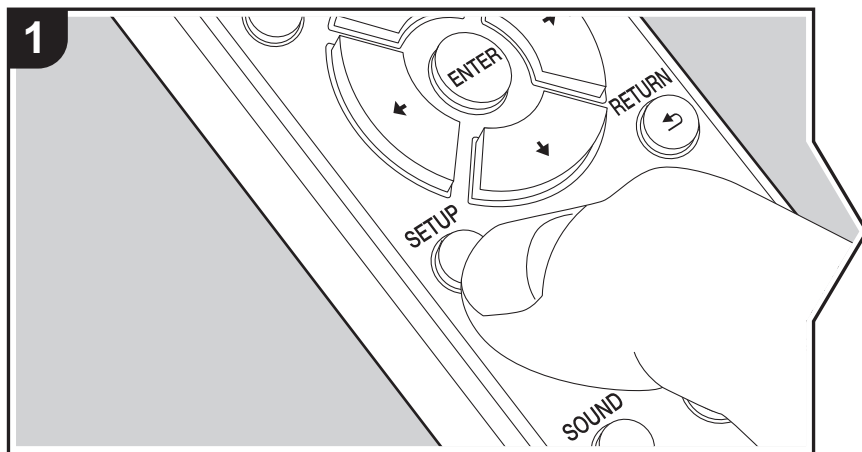

The unit allows you to configure advanced settings to provide you with an even better experience.

1. Press SETUP on the remote controller.

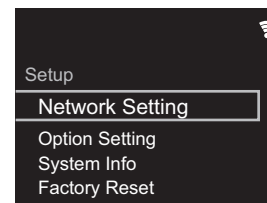

2. After the Setup screen is displayed, select the content or the setting with the cursors on the remote controller and press ENTER to confirm your selection. To return to the previous screen, press RETURN.
3. To exit the settings, press SETUP.

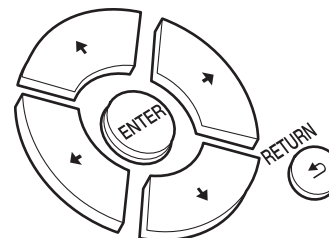

Network Setting

■ Connection

Select the type connection to the network.

"Wi-Fi": To connect via wireless LAN

"Wired" (Default Value): To connect via wired LAN

Perform "Wi-Fi Setup" if you select "Wi-Fi".

■ Wi-Fi Setup



Make Wi-Fi connection settings. (➔P9)

This can be set only when "Wi-Fi" is selected in "Connection".

- You can make Wi-Fi connection settings using a web browser on a computer. For details, refer to "Web Setup" (➔P33).

■ DHCP

"On" (Default Value): Auto configuration by DHCP

"Off": Manual configuration without DHCP

If selecting "Off", you must set "IP Address", "Subnet Mask", "Gateway", and "DNS Server" manually.

■ IP Address

Displays/Sets the IP address.

■ Subnet Mask

Displays/Sets the subnet mask.

■ Gateway

Displays/Sets the gateway.

■ DNS Server

Displays/Sets the primary DNS server.

■ Proxy URL

Displays/Sets the proxy server URL.

■ Proxy Port

Displays/Sets the proxy server port number when you enter "Proxy URL".

■ Friendly Name

Change the device name for this unit which is shown on other devices connected to the network to an easily recognized name. You can input up to 31 characters. For details on how to enter text, refer to "Entering text" (➔P29). After finishing input, press ENTER.

■ AirPlay Password

You can set a password of up to 31 characters so that only registered users can use AirPlay.

For details on how to enter text, refer to "Entering text" (➔P29). After finishing input, press ENTER.

■ Network Check

You can check the network connection.

Option Setting

■ Power Off Setting

Auto Standby	This setting places the unit on standby automatically after 20 minutes of inactivity without any audio input. "On" (Default Value): The unit will automatically enter standby mode. "Off": The unit will not automatically enter standby mode.
Network Standby	When this feature is turned "On", you can turn on the power of the unit via the network using an application that can control this unit. • Setting to "On" (Default Value) increases the power consumption even when the unit is on standby. • "Network Standby", which suppresses power consumption, may be disabled when the network connection is lost.
Bluetooth Wakeup	This function wakes up the unit on standby by connecting a BLUETOOTH enabled device. "On": Use this function "Off" (Default Value): Do not use this function • Setting to "On" increases the power consumption even when the unit is on standby. • This setting is fixed to "Off" if "Bluetooth Setting" - "Auto Input Change" is set to "Off".

■ Digital Filter

"Slow": Soft and fluid sound

"Sharp" (Default Value): Sound with more structure and firmness

"Short": Sound that starts quick and seems to move forward

■ Language



Select the language displayed on the display.

English (Default Value), German, French, Spanish, Italian, Dutch, Swedish, Russian, Chinese

■ Tuner Setting

Tuning Mode	Set the tuning method for the radio. "Auto" (Default Value): Radio stations that can be received are tuned automatically. "Manual": Tune to stations manually. If the "Tuning Mode" is set to "Manual", the reception for FM broadcasts will be monaural rather than stereo, irrespective of the sensitivity of the reception.
FM Search Level	You can choose to have only those FM stations with strong reception selected when tuning into stations automatically if tuning regularly stops on FM stations with weak reception. "Normal" (Default Value) "Strong": Select only stations with strong reception.
DAB Scan	You can run the auto scan when new DAB stations are added or when you move house.
DAB DRC	With the DRC (Dynamic Range Control) setting, you can reduce the dynamic range of DAB digital radio so that you can still hear quiet parts even when listening at low volume levels - ideal for listening to the radio late at night when you don't want to disturb anyone. "0" (Default Value): DRC off "1": Large reduction in dynamic range "1/2": Small reduction in dynamic range
Preset Name	You can give names to the stations that you have registered. For details on how to enter text, refer to "Entering text" (➔P29). After finishing input, press ENTER.

■ Bluetooth Setting

Bluetooth	Select whether or not to use the BLUETOOTH function. "On" (Default Value): Enables connection with a BLUETOOTH enabled device by using the BLUETOOTH function. Select "On" also when making various BLUETOOTH settings. "Off": When not using the BLUETOOTH function
Auto Input Change	The input of the unit will automatically be switched to "BLUETOOTH" when connection is made from a BLUETOOTH enabled device to the unit. "On" (Default Value): The input will automatically become "BLUETOOTH" when a BLUETOOTH enabled device is connected. "Off": The function is disabled. • If the input is not switched automatically, set to "Off" and change the input manually.
Auto Reconnect	This function automatically reconnects to the BLUETOOTH enabled device connected last when you change the input to "BLUETOOTH". "On" (Default Value): Use this function "Off": Do not use this function • This may not work with some BLUETOOTH enabled devices.
Pairing Information	You can initialize the pairing information saved on this unit. Press $\blacktriangle/\blacktriangledown$ to select "Clear", then press ENTER to initialize the pairing information stored in this unit. • This function does not initialize the pairing information on the BLUETOOTH enabled device. When pairing the unit again with the device, be sure to clear the pairing information on the BLUETOOTH enabled device in advance. For information on how to clear the pairing information, refer to the BLUETOOTH enabled device's instruction manual.

System Info

The MAC address of this unit and the current firmware version will be displayed.



Factory Reset

Reset the settings of this unit to the status at the time of shipment. We recommend that you take a note of the settings you have changed before going ahead with a factory reset. Select "Start" and confirm to go ahead. The unit will be placed on standby automatically when initializing is completed.

Update

"Update" is not displayed if there are no firmware updates.

■ via Network

Press ENTER to select when you want to update the firmware via network.

■ via USB

Press ENTER to select when you want to update the firmware via USB.

Web Setup

You can make Wi-Fi connection settings using a web browser on a computer. Be sure your computer is connected to the router wirelessly. If this unit is connected to the router using ethernet cable, you can not do this setting.

1. Turn the unit on.
2. Press SETUP on the remote controller, select "Wi-Fi" in "Network Setting" - "Connection", then select "Wi-Fi Setup".
3. Press $\blacktriangle/\blacktriangledown$ to select "Use iOS Device" and press ENTER.
4. In the list of wireless LAN connections on your computer, select SSID of this unit (softap_0009B0xxxxxx).
 - "xxxxxx" in SSID is the lower three bytes of the MAC address.
5. Open the web browser on your computer and access <http://192.168.200.1>.
6. The "Web Setup" menu is displayed. Make network settings for this unit.
 - Depending on the equipment being used or connection environment, this function may not work.
 - Consult the appropriate operating instructions for information regarding operation of the computer.
 - Since this kind of connection is not encoded, a minor security risk may be involved.



Firmware Update

The updating function on this unit

This unit has functionality to update the firmware (the system software) over a network or by the USB port. This enables us to make improvements to a variety of operations and to add features.

For details about the updated play features, see [here](#).

How to update

There are two methods for updating the firmware: via network and via USB. The update may take about 5 minutes to complete for either method: via network or via USB. Furthermore, existing settings are guaranteed regardless of the method used for update.

- For the latest information on updates, visit our company's website. There is no need to update the firmware on this unit if there is no update available.
- When performed over the network, it may take even more time depending on the connection status.
- During an update, do not
 - Disconnect and reconnect any cable or USB storage device, or perform any operation on the component such as turn off its power.
 - Accessing this unit from a PC or smartphone using an application

Disclaimer: The program and accompanying online documentation are furnished to you for use at your own risk. We will not be liable and you will have no remedy for damages for any claim of any kind whatsoever concerning your use of the program or the accompanying online documentation, regardless of legal theory, and whether arising in tort or contract.

In no event will we be liable to you or any third party for any special, indirect, incidental, or consequential damages of any kind, including, but not limited to, compensation, reimbursement or damages on account of the loss of present or prospective profits, loss of data, or for any other reason whatsoever.

Updating the Firmware via Network

- Check that the unit is turned on, and the connection to the Internet is secured.
- Turn off the controller component (PC etc.) connected to the network.

- Stop any playing Internet radio, USB storage device, or server content.

1. The setup screen is displayed on the display when SETUP on the remote controller is pressed.

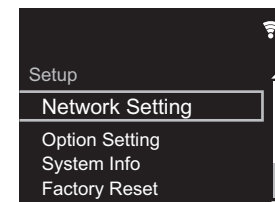

2. Press $\blacktriangle/\blacktriangledown$ and ENTER to select "Update" - "via Network" in order.

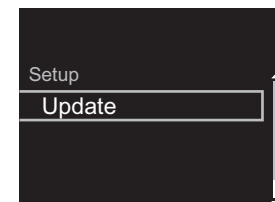

- "Update" is not displayed if there are no firmware updates.
3. Press ENTER to start the firmware update.
 - "COMPLETE" is displayed when the update is complete.
 4. Press STANDBY/ON on the main unit to switch the unit to standby. The process is completed and your firmware is updated to the latest version.

If an error message is displayed: When an error occurs, " * * * Error!" is displayed on the display of this unit. (" * " represents an alphanumeric character.) Check the following:



- *** -01, * -10:** Ethernet cable not found. Connect the Ethernet cable properly.
- *** -02, * -03, * -04, * -05, * -06, * -11, * -13, * -14, * -16, * -17, * -18, * -20, * -21:** Internet connection error. Check the following:
 - The router is turned on
 - This unit and the router are connected via the network
 Try to disconnect and then connect again the power to the unit and router. This may solve the problem. If you are still unable to connect to the Internet, the DNS server or proxy server may be temporarily down. Check the service status with your ISP provider.
- **Others:** Disconnect then reconnect the AC power cord, then repeat from the beginning.

Updating via USB

- Prepare a 128 MB or larger USB storage device. FAT16 or FAT32 file system format.
- Delete any data stored on the USB storage device.
- Turn off the controller component (PC etc.) connected to the network.
- Stop any playing Internet radio, USB storage device, or server content.
- Some USB storage devices may take long to load, may not be loaded correctly, or may not be correctly fed depending on the device or their content.
- We will not be liable whatsoever for any loss or damage of data, or storage failure arising from the use of the USB storage device with this unit. Thank you for your understanding.

1. Connect the USB storage device to your PC.
2. Download the firmware file from our company's website to your PC and unzip.

Firmware files are named in the following way:

PIOHIM *****.zip
Unzip the file on your PC. The number of unzipped files and folders varies depending on the model.

3. Copy all unzipped files and folders to the root folder of

the USB storage device.

- Make sure to copy the unzipped files.
4. Connect the USB storage device to the USB port of this unit.
 - If you connect a USB hard disk drive to the USB port of the unit, we recommend that you use its AC adapter to power it.
 - If the USB storage device has been partitioned, each section will be treated as an independent device.
 5. The setup screen is displayed on the display when SETUP button on the remote controller is pressed.

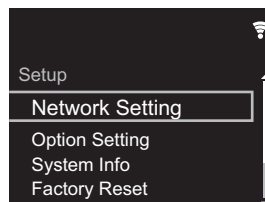

6. Press ▲/▼ and ENTER to select "Update" - "via USB" in order.

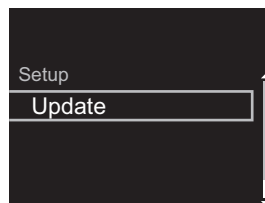

- "Update" is not displayed if there are no firmware updates.
7. Press ENTER to start the firmware update.
 - "COMPLETE" is displayed when the update is complete.
 8. Press ⏻ STANDBY/ON on the main unit to switch the unit to standby. The process is completed and your

firmware is updated to the latest version.

9. Remove the USB storage device from this unit.

If an error message is displayed: When an error occurs, " * - * * Error!" is displayed on the display of this unit. Check the following:

- *** -01, * -10:** USB storage device not found. Check whether the USB storage device or USB cable is correctly inserted to the USB port of this unit. Connect the USB storage device to an external power source if it has its own power supply.
- *** -05, * -13, * -20, * -21:** The firmware file is not present in the root folder of the USB storage device, or the firmware file is for another model. Retry from the download of the firmware file.
- **Others:** Disconnect then reconnect the AC power cord, then repeat from the beginning.



Troubleshooting

Before starting the procedure

When operation is unstable, problems may be solved by simply turning the power on or to standby or disconnecting/connecting the power cord, rather than reviewing settings and operations. Try the simple measures on both the unit and the connected device. If the problem isn't fixed after referring to "Troubleshooting", resetting the unit to the status at the time of shipment may solve the problem. Note that your settings will also be initialized when you reset, so we recommend that you note down your settings before doing the following.

Resetting the unit (this resets the unit settings to the default)

1. Press SETUP on the remote controller, select "Factory Reset" - "Start" in the Setup screen and press ENTER.
2. Press ENTER.
3. The unit switches to standby and the settings are reset.

■Power

Cannot turn on the unit

- Unplug the power cord from the wall outlet, wait 5 seconds or more, then plug it in again.

The unit turns off unexpectedly

- The unit automatically switches to standby when the "Option Setting" - "Power Off Setting" - "Auto Standby" setting in the Setup menu functions.
- Check if the speaker cable wires are touching the rear panel or if the + side and - side have shorted. If there is contact or shorting, the unit will switch to standby automatically.
- If the power turns off and indicators on the front panel continually blink, there may have been a malfunction with the amplifier or the protection circuit may have tripped.
 - If the power indicator blinks at approximately 1 second intervals: There may have been a malfunction in the

amplifier section. Unplug the power cord from the wall outlet immediately and contact the dealer or our company's support.

- If the power indicator blinks at approximately 0.3 second intervals: The protection circuit may have tripped due to playback at high volume. Reduce the volume for playback. Alternatively, the wires in the speaker cables may have touched the rear panel or other wires. Connect the wires so they do not protrude from the speaker jacks.

If the same symptoms such as being unable to turn the unit on happen repeatedly, unplug the power cord from the wall outlet immediately and contact the dealer or our company's support.

■There is no audio from external devices

- There is no sound if this unit is muted. Press MUTE on the remote controller to cancel muting.
- Confirm that the connection between the output jack on the external device and the input jack on this unit is correct.
- Change the input selector on this unit to the position of the terminal to which the external device is connected.
- Check the digital audio output setting on the connected component. On some game consoles, such as those that support DVD, the default setting is off.

■The display doesn't light

- The display may go dim while the DIMMER is working, and may also turn off. Press DIMMER button and change the brightness level of the display.

■Wi-Fi Connection

- Try plugging/unplugging the power supply of wireless LAN router and the unit, check the wireless LAN router

power-on status, and try reboot of the wireless LAN router.

Cannot connect to the access point

- Check that the setting of SSID and encryption (WEP, etc.) is correct. Make sure the network settings of the unit is properly set.
- Connection to an SSID that includes multi-byte characters is not supported. Name the SSID of the wireless LAN router using single-byte alphanumeric characters only and try again.
- When the wireless LAN router setting is at stealth mode (mode to hide the SSID key) or when ANY connection is off, the SSID is not displayed. Change the setting and try again.

Connected to an SSID different to the SSID selected

- Some access points allow you to set multiple SSIDs for one unit. If you use the automatic setting button on such a router, you may end up connecting with a different SSID from the SSID you wanted to connect to. Use the connection method requiring you to enter a password if this happens.

Playback is interrupted and communication does not work

- Shorten the distance from the access point or remove obstacles to improve visibility, and try again. Place the unit away from microwave ovens or other access points. It is recommended to place the access point and the unit in the same room.
- If there is a metallic object near the unit, wireless LAN connection may not be possible as the metal can effect on the radio wave.
- When other access point are used near the unit, several issues such as interrupted playback and communication may occur. You can avoid these issues by changing the channel of the access point. For instructions on changing channels, see the instruction manual provided with the access point.



■Cannot play discs

- Place the disc in the disc tray so the label is facing up.
- Play may not be possible if the disc is scratched or dirty.

■Cannot Play USB storage device / HDD

- Check whether the USB storage device or USB cable is correctly inserted to the USB port of the unit.
- Disconnect the USB storage device from the unit, and then try reconnecting.
- This unit may not recognize USB storage devices and HDDs as proper devices sometimes. Try switching this unit to standby and then turning it on again.
- Depending on the type of format, the playback may not be performed normally. Check the type of the file formats that is supported. (➔P15)
- Cautions regarding USB and HDD devices (➔P15)

■FM reception is poor

- Re-check the antenna connection.
- Separate the antenna from speaker cables and the power cord.
- Move the unit away from your TV or PC.
- Passing cars and airplanes can cause interference.
- Concrete walls weaken radio signals.
- FM reception may become clearer if you use the antenna jack on the wall used for the TV.
- FM reception improves if the Tuning Mode (➔P32) is set to Manual. However, reception will be monaural rather than stereo.

■Network function

- If you cannot select a network service, it will become selectable when the network function is started.
- Try plugging/unplugging the power supply of this unit and

the router, and try rebooting the router.

Cannot access the Internet radio

- Certain network service or contents available through the unit may not be accessible in case the service provider terminates its service.
- Make sure that your modem and router are properly connected, and make sure they are both turned on.
- Depending on ISP, setting the proxy server is necessary.
- Make sure that the used router and/or modem is supported by your ISP.

Cannot access the network server

- This unit needs to be connected to the same router as the network server.
- This unit is compatible with Windows Media® Player 11 or 12 network servers or NAS that are compatible with home network functionality. Furthermore, when using a PC, only music files registered in the Windows Media® Player library can be played.

Playback stops while listening to music files on the network server

- When the PC is serving as the network server, try quitting any application software other than the server software (Windows Media® Player 12, etc.).
- If the PC is downloading or copying large files, the playback may be interrupted.

The album names and artist names for the Music Server are not displayed

- Meta data, such as album names and artist names, needs to be recognized on the server for distribution to this unit, so this depends on the specifications of the NAS or server you are using.
- The file formats supported depend on the NAS or server software. For details, contact the manufacturer of NAS or the server software.

Album art in Music Server is displayed sometimes but

not other times

- Music Server depends on the specifications of the server software.
- The formats supported depend on the server software.
- For details, contact the manufacturer of the server software.

■BLUETOOTH function

- Try plugging/unplugging the power of the unit and try turning on/off the BLUETOOTH enabled device. Restarting the BLUETOOTH enabled device may be effective.
- The BLUETOOTH enabled devices must support the A2DP profile.
- Near components such as microwave oven or cordless phone, which use the radio wave in the 2.4 GHz range, a radio wave interference may occur, which disables the use of this unit.
- If there is a metallic object near the unit, BLUETOOTH connection may not be possible as the metal can effect on the radio waves.
- In order to respond to operations on the remote controller of this unit, the BLUETOOTH enabled device must support the AVRCP profile.
- Note that operation with the remote controller is not always guaranteed with all BLUETOOTH enabled devices.

Cannot connect with this unit

- Check that the BLUETOOTH function of the BLUETOOTH enabled device is enabled.
- If an already paired unit cannot be connected, delete the pairing information on the BLUETOOTH enabled device, then pair again.

Music playback is unavailable on the unit even after successful BLUETOOTH connection

- When the audio volume of your BLUETOOTH enabled



device is set low, the playback of audio may be unavailable. Turn up the volume on the BLUETOOTH enabled device.

- Some BLUETOOTH enabled devices may be equipped with a Send/Receive selector switch. Select Send mode.

Sound is interrupted

- There may be a problem with the BLUETOOTH enabled device. Check the information on the internet.



General Specifications

■Analog Audio Output Section

RMS Output Power

- 50 W + 50 W
(4 ohms, 1 kHz THD 10%)

THD+N

- 0.02% (1 kHz, half power, 4 ohms)

Input Sensitivity and Impedance

- 200 mVrms/47 k Ω (LINE (Unbalance))
- 2.5 mVrms/47 k Ω (PHONO MM)

Frequency Response

- 10 Hz - 60 kHz (± 3 dB, 8 Ω)

Tone Control Characteristics

- ± 10 dB (100 Hz (BASS))
- ± 10 dB (10 kHz (TREBLE))

Signal to Noise Ratio

- 100 dB (A-weighting/LINE)
- 85 dB (A-weighting/PHONO)

Supported Speaker Impedance

- 4 ohms - 16 ohms

■Tuner Section

Tuning Frequency Range (FM)

- 87.5 MHz - 108.0 MHz, RDS

Tuning Frequency Range (DAB)

- 174.928 MHz - 239.200 MHz

Antenna (FM/DAB)

- 75 Ω unbalanced

Preset Channel

- 40

■CD Section

Media/Format

- CD : Standard CD
- CD-R/RW : CD format/MP3, WMA File

■Digital Audio Input

Front/Rear USB

- Type A, USB2.0 High Speed

DC Output

- 5 V 1 A (Rear)/5 V 0.5 A (Front)

Optical Digital Input

- Optical Jack

Coaxial Digital Input

- RCA Jack

■Network Section

ETHERNET LAN

- 10BASE-T/100BASE-TX

Wireless LAN

- IEEE 802.11 a/b/g/n standard
- 5 GHz/2.4 GHz band

■Bluetooth Section

Communication system

- BLUETOOTH Specification version 4.1

Frequency band

- 2.4 GHz (2.402 GHz - 2.480 GHz)

Modulation method

- FHSS (Freq Hopping Spread Spectrum)

Compatible Bluetooth profiles

- A2DP 1.2
- AVRCP 1.3
- HOGP-Host (Client)
- HOGP-HID Device (Server)
- HID Service (HIDS)

Supported Codecs

- SBC
- AAC

Transmission range (A2DP)

- 20 Hz - 20 kHz (Sampling frequency 44.1 kHz)

Maximum communication range *

- (Line of sight approx.) 10 m.
- * The actual range will vary depending on factors such as obstacles between devices, magnetic fields around a microwave oven, static electricity, cordless phone, reception sensitivity, antenna's performance, operating system, software application, etc.

■General

Power Supply

- AC 220 - 230 V, 50/60 Hz

Power Consumption

- 50 W
- 0.3 W (In Standby)
- 2.1 W (In Standby, Network Standby : On, Network Setting : Wired)
- 2.5 W (In Standby, Network Standby : On, Network Setting : Wi-Fi)
- 2.2 W (In Standby, Bluetooth Wakeup : On)
- 2.5 W (In Standby, Network Standby : On, Network Setting : Wi-Fi, Bluetooth Wakeup : On)

Auto Standby



- On (20 min)/Off

Dimensions (W × H × D)

- 435 mm × 103 mm × 333 mm

Weight

- 6.4 kg



License and Trademark Information



The Wi-Fi CERTIFIED Logo is a certification mark of Wi-Fi Alliance®.



AirPlay, iPad, iPhone, and iPod touch are trademarks of Apple Inc., registered in the U.S. and other countries.

iPad Air and iPad mini are trademarks of Apple Inc.

"Made for iPod", "Made for iPhone" and "Made for iPad" mean that an electronic accessory has been designed to connect specifically to iPod, iPhone, or iPad, respectively, and has been certified by the developer to meet Apple performance standards. Apple is not responsible for the operation of this device or its compliance with safety and regulatory standards.

Please note that the use of this accessory with iPod, iPhone or iPad may affect wireless performance.

AirPlay works with iPhone, iPad, and iPod touch with iOS 4.3.3 or later, Mac with OS X Mountain Lion or later, and PC with iTunes 10.2.2 or later.



The Bluetooth® word mark and logos are registered trademarks owned by the Bluetooth SIG, Inc.



This Mark Certifies that this product is compliant with the BLACKFIRE ALLIANCE Standard.
Please refer to WWW.BLACKFIREALLIANCE.COM for more information.
BLACKFIRE™ is a Registered Trademark (No. 85,900,599) of BLACKFIRE RESEARCH CORP. All rights reserved.



FireConnect™ is technology powered by BlackFire Research.



The product with this logo is conformed to Hi-Res Audio standard defined by Japan Audio Society. This logo is used under license from Japan Audio Society.

This product is protected by certain intellectual property rights of Microsoft. Use or distribution of such technology outside of this product is prohibited without a license from Microsoft.

Windows and the Windows logo are trademarks of the Microsoft group of companies.

DSD and the Direct Stream Digital logo are trademarks of Sony Corporation.

MPEG Layer-3 audio coding technology licensed from Fraunhofer IIS and Thomson.

"All other trademarks are the property of their respective owners."

"Toutes les autres marques commerciales sont la propriété de leurs détenteurs respectifs."

"El resto de marcas comerciales son propiedad de sus respectivos propietarios."

"Tutti gli altri marchi di fabbrica sono di proprietà dei rispettivi proprietari."

"Alle anderen Warenzeichen sind das Eigentum ihrer jeweiligen Eigentümer."

"Alle andere handelsmerken zijn eigendom van de desbetreffende rechthebbenden."



2-3-12 Yaesu, Chuo-ku, Tokyo 104-0028 JAPAN

<U.S.A.>

18 PARK WAY, UPPER SADDLE RIVER, NEW JERSEY 07458, U.S.A.

Tel: 1-201-785-2600 Tel: 1-844-679-5350

<Germany>

Hanns-Martin-Schleyer-Straße 35, 47877 Willich, Germany

Tel: +49(0)2154 913222

<UK>

Anteros Building, Odyssey Business Park, West End Road, South Ruislip,
Middlesex, HA4 6QQ United Kingdom

Tel: +44(0)208 836 3612

<France>

6, Avenue de Marais F - 95816 Argenteuil Cedex FRANCE

Tel: +33(0)969 368 050

Корпорация О энд Пи

2-3-12, Яэсу, Чуо-ку, г. Токио, 104-0028, ЯПОНИЯ

Register your product on

<http://www.pioneer.eu> (Europe)

© 2016 Onkyo & Pioneer Corporation. All rights reserved.

© 2016 Onkyo & Pioneer Corporation. Tous droits de reproduction et de traduction réservés.

Onkyo group has established its Privacy Policy, available at [<http://www.pioneer-audiovisual.com/privacy/>].

"Pioneer" and "PBASS" are trademarks of Pioneer Corporation, and is used under license.

SN 29402668A

EN

F1701-1



* 2 9 4 0 2 6 6 8 A *