

Serie | 8

# HRG6769B2A Built-in Oven with Added Steam



## Included accessories

1 x grill tray  
 suit. pyrol. clean.  
 2 x combination grid  
 1 x universal pan

## Optional accessories

HEZ327000 : Pizza stone  
 HEZ617000 : Pizza pan, anthracite enamelled  
 HEZ625071 : Grill tray, anthracite enamelled  
 HEZ631070 : Baking tray, anthracite enamelled  
 HEZ632070 : Multipurpose pan, anthracite enamelled  
 HEZ633001 : Lid for professional pan, enamelled anth  
 HEZ634000 : Baking and roasting grid (standard)  
 HEZ636000 : Glass pan

**The Series 8 built-in oven with PerfectBake, PerfectRoast and added steam: automatically prepares your dishes so they're perfect and moist.**

- **Bosch Assist:** automatic setting of the optimal type of heat, temperature and time for countless dishes.
- **4D HotAir:** even heat distribution for perfect results – on any level.
- **Pyrolytic self-cleaning:** no cleaning effort thanks to 3 stage self-cleaning. Including enamel trays and shelf racking.
- **TFT touchscreen control:** easy-to-use thanks to the control ring with full text and colour images.
- **Top-/Bottom heat:** perfect results on one level thanks to optimal distribution of heat.

## Technical Data

Color / Material Front :	Black
Built-in / Free-standing :	Built-in
Integrated Cleaning system :	Pyrolytic
Required niche size for installation (HxWxD) :	585-595 x 560-568 x 550
Dimensions of the product (mm) :	595 x 594 x 548
Dimensions of the packed product (HxWxD) (mm) :	650 x 680 x 650
Control Panel Material :	Glass
Door Material :	Glass
Net weight (kg) :	47.062
Usable volume of cavity (l) :	71
Cooking method :	, 4D hot air, Bottom heat, Conventional heat, Defrost, Dehydrate, Full width grill, Half width grill, Hot Air-Eco, Hot air grilling, Intensive heat, low temperature cooking, Pizza setting, pre-heating, warming
First cavity material :	Enamelled
Temperature control :	electronic
Number of interior lights :	3
Approval certificates :	CE, VDE
Length electrical supply cord (cm) :	120
EAN code :	4242005131778
Number of cavities (2010/30/EC) :	1
Energy efficiency class (2010/30/EC) :	A
Energy consumption per cycle conventional (2010/30/EC) :	0.90
Energy consumption per cycle forced air convection (2010/30/EC) :	0.74
Energy efficiency index (2010/30/EC) :	87.1
Electrical connection rating (W) :	3600
Current (A) :	16
Voltage (V) :	220-240
Frequency (Hz) :	50; 60
Plug type :	no plug



## Serie | 8 Ovens

### HRG6769B2A

#### Built-in Oven with Added Steam

**The Series 8 built-in oven with PerfectBake, PerfectRoast and added steam: automatically prepares your dishes so they're perfect and moist.**

#### Heating Functions

- Oven with 15 heating methods:
  - 4D HotAir
  - 4D HotAir Eco
  - Top/bottom heating
  - Top/bottom heating Eco
  - Hot air grilling
  - Full width grill
  - Half width grill
  - Pizza setting
  - Bottom heating
  - Intensive heat
  - Slow cooking
  - Defrost
  - Preheat ovenware
  - Drying
  - Keep warm
- Additional heating methods with steam: Reheating, Dough Proving
- Rapid heating-up
- Temperature range 30 °C - 300 °C

#### Sensor Technology & Automatic Programs

- Bosch Assist - a menu of dishes for automatic cooking
- PerfectBake baking sensor
- PerfectRoast multipoint meat probe

#### Design

- TFT Touch Graphic Display
- Bosch Control Ring
- Drop down door, Oven door with SoftClose , SoftOpen
- LED lighting, Multi-level LED lighting
- Cavity volume: 71 net usable litres
- Anthracite enamel cavity with 5 shelf positions

#### Cleaning

- 3 Stage pyrolytic cleaning
- Additional functions:
  - Descaling programme
  - Drying function
- Pyrolytic proof trayholder and baking tray
- Full glass inner door

#### Convenience

- Automatic temperature proposal
- Actual temperature display
- Residual heat indicator
- Sabbath mode
- 3-level telescopic rails, fully extendable, safety stop function, pyrolytic proof
- Electronic clock/timer with end time programming
- Info button
- Large 1 litre water tank
- Water tank empty indicator
- Location of the steam generator is outside of the cavity
- Bar handle

#### Safety and Environment

- Quadruple glazed CoolTouch door
- Maximum door temperature 30° C
- Child lock function
- Automatic safety switch off function
- Residual heat indicator
- start button
- Door contact switch
- Cooling fan

#### Accessories

- 1 x grill tray, suit. pyrol. clean., 2 x combination grid, 1 x universal pan

#### Technical Info

- Appliance dimensions (HxWxD): 595 mm x 594 mm x 548 mm
- Installation dimensions (HxWxD): 585 mm - 595 mm x 560 mm - 568 mm x 550 mm
- Length of mains cable: 120 cm
- Nominal voltage: 220 - 240 V
- Total connected load electric: 3.6 KW
- Please reference the built-in dimensions provided in the installation drawing

## Serie | 8 Ovens

**HRG6769B2A**

### Built-in Oven with Added Steam

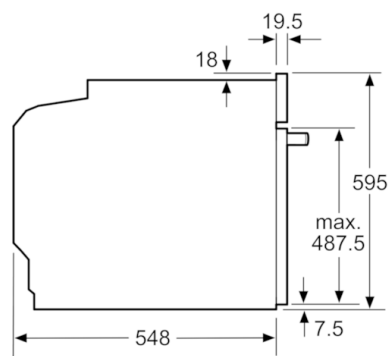

measurements in mm

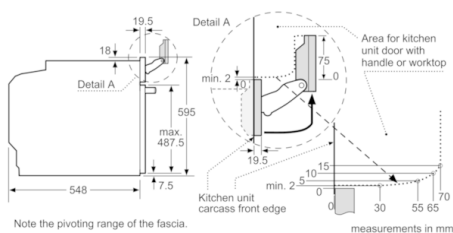

If the appliance will be installed underneath a hob, the following worktop thicknesses (including substructure if necessary) must be taken into account.

Hob type	min. worktop thickness	
	fitted	flush
Induction hob	37 mm	38 mm
Full surface Induction hob	47 mm	48 mm
Gas hob	30 mm	38 mm
Electric hob	27 mm	30 mm

