

EVOKE

A5尺寸
70克双胶纸
黑白印刷
此红色文字不印刷

Washing Machine OWNER'S MANUAL

Applicable Models

ETL600W

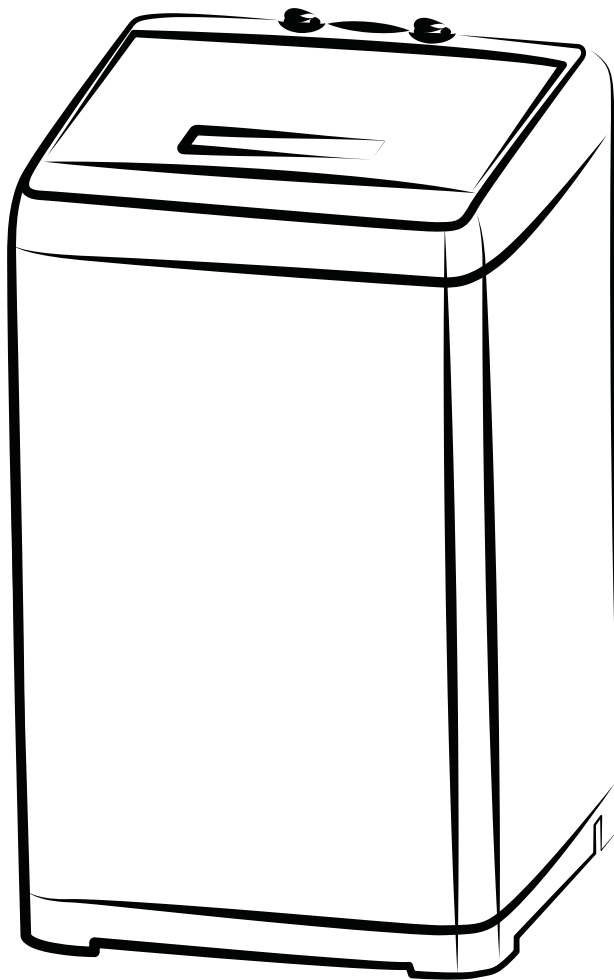

Thank you for choosing our Washing Machine.
It is essential to read this manual carefully before it is installed and used for the first time.

Contents

Safety notices.....	2
Parts and features	3
Installation.....	3
The functions of the control panel	6
How to use washer.....	6
Electric Diagram.....	7
Cleanness and Maintenance	8
Troubleshooting guide	8
Technical parameters.....	9

Safety notices

Warning

Read and understand thoroughly this safety instructions before use. The items indicated here are very important safety precautions, which must be followed. We cannot be held liable for damage caused by non-compliance with the warning and safety instructions or resulting from incorrect use or operation.

The appliance can be used by children aged from 8 years and above and persons with reduced physical, sensory or mental capabilities or lack of experience and knowledge if they have been given supervision or instruction concerning use of the appliance in a safe way and understand the hazards involved. Children shall not play with the appliance. Cleaning and user maintenance shall not be made by children without supervision. Children of less than 3 years should be kept away unless continuously supervised.

This appliance is intended to be used in household and similar applications such as:

- staff kitchen areas in shops, offices and other working environments;
- farm houses;
- by clients hotels, motels and other residential type environments;
- bed and breakfast type environments;
- areas for communal use in blocks of flats or in launderettes.

Technical safety

- Before setting up the washing machine, check it for any externally visible damage. Do not install or use a damaged washing machine.
- Before connecting the washing machine, ensure that the connection data on the data plate(voltage and current)match the electricity supply. If in any doubt, consult a qualified electrician.
- The electrical safety of this washing machine can only be guaranteed when continuity is complete it and an effective earthing system which complies with current local and national safety regulations. It is most important that this basic safety requirement is present and regularly tested, and where there is any doubt the household wiring system should be inspected by a qualified electrician. The manufacturer cannot be held liable for the consequences of an inadequate earthing system.
- Do not connect the washing machine to the mains electricity supply by an extension lead. Extension leads do not guarantee the required safety of the appliance.
- Unauthorized repairs could result in unforeseen dangers for the user, for which manufacturer cannot accept liability. Repairs should only be undertaken by an approved service technician. Ensure current is not supplied to the machine until after maintenance or repair work has been carried out.
- If the supply cord is damaged, it must be replaced by the manufacturer, its service agent or similarly qualified persons in order to avoid a hazard.
- When these parts are fitted can the safety standards of the machine be guaranteed.



Caution

THIS WASHING MACHINE MUST BE EARTHED.

Correct use

- To avoid the risk of personal injury or damage to the washing machine, do not install it in place where it is damp and where it suffers form rainfall.
- Do not install the washing machine in place where it suffers form the sun directly, in which plastic or components will be damaged, It will be shortened the life of your washing machine.
- Do not install the washing machine in place where temperatures below freezing may occur. Frozen hoses may burst or split. The reliability of the electronic control unit may be impaired at temperatures below freezing point.
- Do not shoot the washing machine with water when you clean it.
- Keep the washing machine away from fire or heat sources.
- Turn off the tap if the machine is to be left for any length of time (e.g. holiday), especially if there is no floor drain(gully)in the immediate vicinity.
- Do not place flammable substances near the machine, such as kerosene, benzine, paint thinner and alcohol.
- Do not put clothing with such substances in the tub.
- Take care to ensure that foreign objects (e.g. nails, pins, coins, paper clips)do not find their way into the machine with the laundry. These may damage components of the machine(e.g.tub), which in turn can result in damage to the laundry.

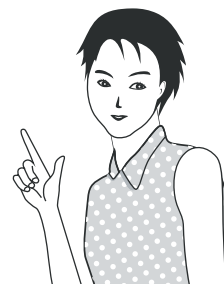

- Do not wash and spin waterproof sheets and garments.
- Never touch the laundry with your hand during the spin cycle until the tub has completely stopped spinning.
- Do not put your hand or foot under the washing machine while the machine is operating.
- Do not climb up or put anything heavy on the top of the machine.
- Do not use water hotter than 50°C for washing.
- For washing machines having ventilation openings in the washing machine can not be working on the carpet.
- Children may fall into the tub and drown. Do not leave the washing machine with water remaining inside.

! Safety with children

- Keep children away from the washing machine at all times. To avoid the risk of injury do not allow children to play on or near it or to play with its controls. Supervise children whilst you are using it.
- Older children may only use the washing machine if its operation has been clearly explained to them and they are able to use it safely, recognising the dangers of misuse.

Parts and features

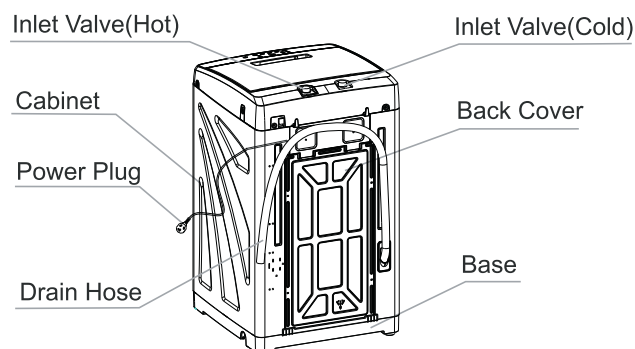
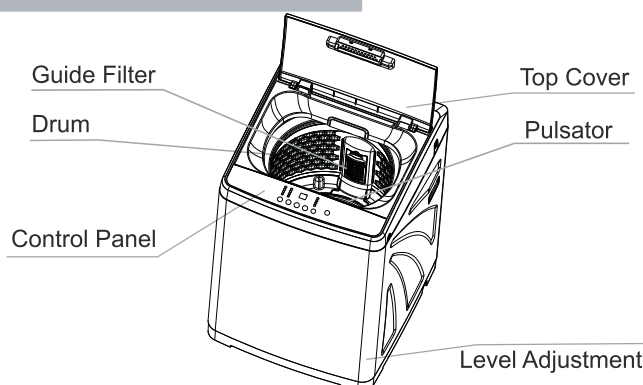

Caution

The shape of the machine shown in the manual is only for instruction purpose. Users should be subject to the actual model that they buy. Please be excused for any inconvenience.

Backout Packing

- Remove all the packing (inclidomg the foam base), or the vibration and noise may occur.
- Put all package materials(e. g. the plastic bag) to a place unreachable to children. After removing all packages, check if the machine is intact. If any questions, please contact the seller immediately before use.
- Please do not install the packaging inserts into the washing machine, otherwise the washing machine will generate abnormal sound and be damaged.
- Water drops may appear on the packing plastic bag and the glass of the observation window occasionally.
- They are condensation resulted from water testing before the product leaves the factory. It is normal.

Installation for Rat guard

When the package is opened, please put the washing machine on a soft object (e. g. towel, wool blanket) gently.

Push the ratguard into the bottom end of the block from right to left by hand, then take it up lightly as shown in figure.

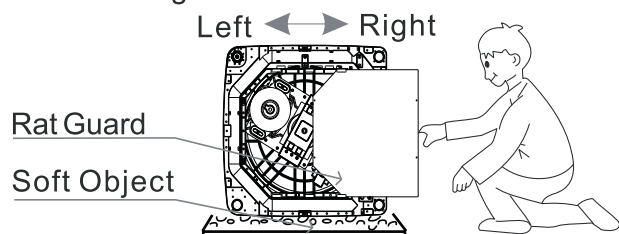

Accessories Checking

Make sure that you have received all of the items shown below.

Accessory	Accessory Names	Quantity
	Cold water Inlet Valve	1
	Hot water Inlet Valve	1
	Ratguard	1
	Manual	1

Placement Requirement

- Install the washing machine on a solid and level floor surface, please do not locate it on cushions or brackets.
- Do not install the washing machine in rooms where temperature below freezing may occur. Do not expose it to the weather ,and keep it away from heat sources such as coals and gas cylinders.
- A distance of 10 cm to the wall is required as shown in the right diagram.
- Allowable a lope under the entire washing machine is 2° . Slant or uneven ground may cause unstable function or other failures.

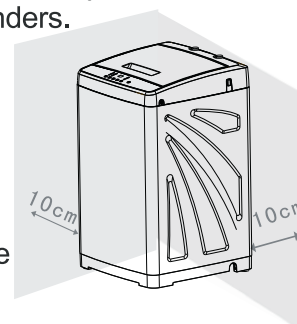



Caution If the floor is uneven, adjust the leveler so as to make the washing machine be even, Please do not put any wooden pieces or other objects under the foot base.

Level Adjustment

The machine must stand perfectly level on all four feet to ensure safe and proper operation. Incorrect installation may increase electricity and water consumption and may cause the machine to move about. To do these when the machine is not level:

- Put up the leveler side slightly.
- Rotate the leveler and regulate it at a required height.

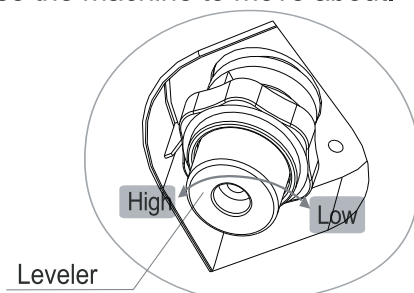

Inlet Hose Connection

When using the washing machine, connect one end of the inlet hose with the washing machine and the other with a tap.

The new hose-sets supplied with the appliance are to be used and that old hose-sets should not be reused.

1. Appropriate Tap

• Common Tap

The outlet length of the tap must be over 10 mm. The tap must be even, if it's uneven, please file it down by a file.

• Specialized Tap

The exterior angle of outlet end should be in a round angle and the surface should be smooth, otherwise the rubber sealing ring of the hose would be damaged to cause water leakage.

When install the inlet hose, please pay attention to connect it or put it down vertically, and it should be fastened up without loosening phenomenon after being connected.

If an appropriate specialized tap is used, an Inlet hose joint needs not to be installed.

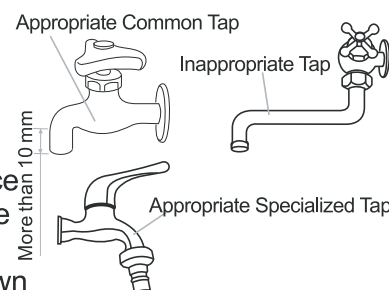

2. Connection between inlet Hose Joint and Tap

- Press the lower end of the locking bar to push slider down, and get down the inlet hose joint from the inlet pipe components, as shown in Figure 1. Loosen the four screws in the inlet hose joint properly, and then set the inlet hose into the tap, as shown in Figure 2. (If the caliber of the tap is oversize slightly and the inlet hose can not be connected, you can loosen the four screws and take down the lining. The front end of the tap must be even, otherwise it will cause water leakage, as shown in Figure 3.)
- Screw down the four screws at the inlet hose joint equally as shown in Figure 4.
- Take the notice plate off and screw the tight nut according to the requirements of the figure, as shown in Figure 5.

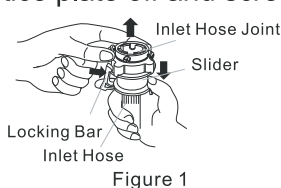

Figure 1

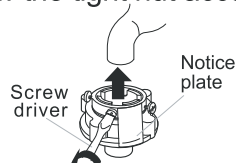

Figure 2



Figure 3

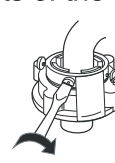

Figure 4

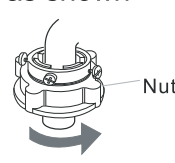

Figure 5

3. Connection between inlet Hose Joint and Tap

- Press the slider and insert the inlet hose into the inlet hose joint.
- Hang the inlet hose joint by the locking bar, and then put down the slider till a sound of pop generates, as shown in Figure 1.
- If the water tap is a screw type, assemble a water supply hose that fits to the tap, as shown in Figure 2. The inlet hose can not be bent by force.
- When the installation is completed, please check that it will be leakage or not.
- Before using the washing machine each time, please check the connection between the inlet hose joint and the tap, as well as check if the joint of inlet hose is firm so as to prevent it from dropping off because of uncompleted installation.

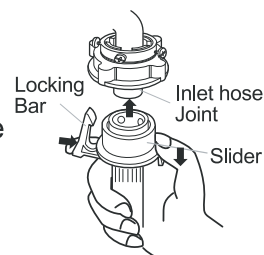

Figure 1

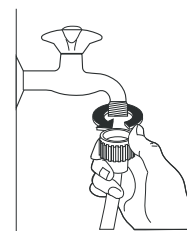
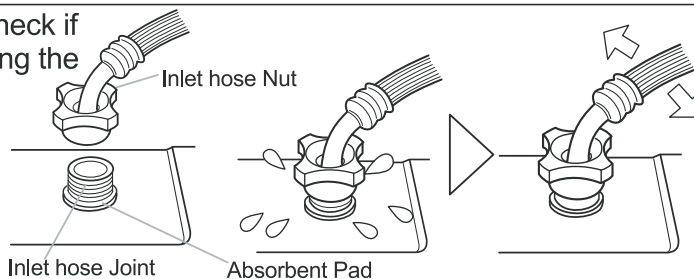

Figure 2

4. Connection between inlet Hose and Washing Machine.

- Please do not take down the absorbent pad, and check if the absorbent pad drops off or damages before using the washing machine each time; if such situation happens, please contact our After-sales Service Department in time.
- Set the inlet hose into the inlet valve joint.
- Screw down the inlet hose nut and check if it is fastened properly by shaking it slightly.



Drain hose connection

1. Direct into sink

If the outlet spigot has not before, remove any blanking plug that may be in place. Push the drain hose onto the spigot and secure with a clip if required, ensure a loop is formed in the drain hose to prevent waste from the sink entering the washing machine. If required, the drain hose can be extended to a length of 4 M.

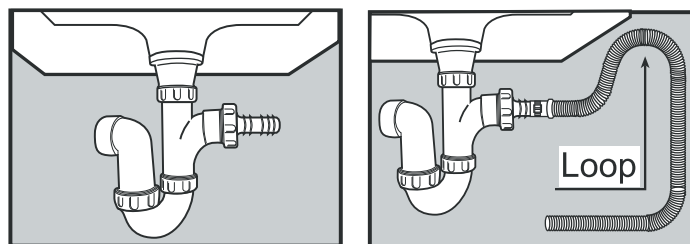

2. Connected securely to a standpipe.

Firstly form a hook in the end of the drain hose using the “U” piece supplied. Place the drain hose into your standpipe, which should have an internal diameter of approximately 38 mm thus ensuring there is an air break between the drain hose and standpipe. When discharging into a standpipe ensure that the top of the standpipe is no more than 90 cm and no less than 60cm above floor level.

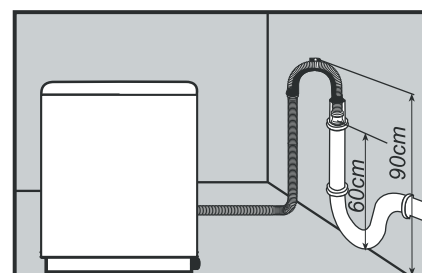
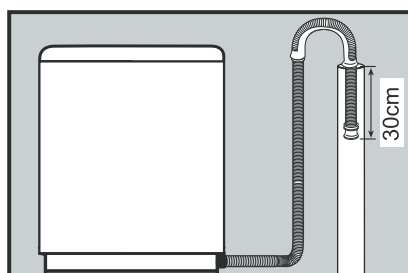

Automatic Detection

1. Washing Input

Put the washing into the washing machine, and press the “Power” switch, and then press the key of “Start/Pause”.

2. Automatically Rotating for about 7 Seconds

The impeller will automatically rotate for about 7 seconds to sense the volume of cloth in the state of no water.

3. Water Level Display

The washing machine will display the water level according to the volume of cloth, and water will automatically input into it for reaching the indicated water level.

The functions of the control panel

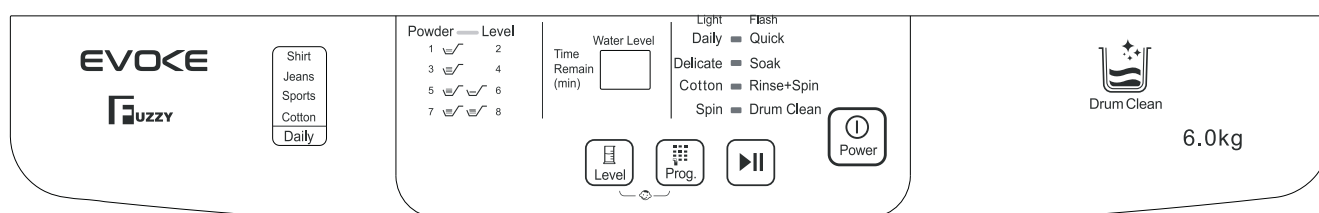

Power

Press this button to connect the power or cut off the power.

Start/Pause

The button is used to start wash cycle or pause the wash cycle. The time will not be recalculated for restarting.







Program

Press this button repeatedly to cycle through the available program: Daily, Quick, Delicate, Soak, Cotton, Rinse+Spin, Spin and Drum Clean. Select a program based on the type of the load you are washing.

Energy-efficient test program entrance guide:

XQB60-G1PTE Energy Rating: Using Cotton, water level is "4", water supply is cold program, or Using Cotton, default water level, water supply is cold&hot program.

XQB60-G1PTE Water Rating: Using Cotton.

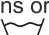
Program	Applicable Situation	Examples of Washable Clothes
Daily	Quick washing for common clothes.	Thick cotton sportswear, common sportswear, underwear, socks etc. Clothes with an icon of  .
Delicate	Soft clothes	Woolen clothes, linen shirts, casual pants, etc, clothes with icons of    .
Quick	The clothes with less stain can be washed quickly	The clothes of less stain with an icon of  .
Soak	The clothes with much stain on collar, sleeves, etc	The clothes with an icon of  .
Cotton	A garment made of cotton and linen, such as a uniform	Cotton, linens or cotton mix fabrics, e.g. table linen, underwear, t-shirts etc.  .

Warm Tip : If you want to change the washable clothes after the washing machine being started, you can press the "Start/Pause" button for switching. Cotton program shows that "A6" is 106 minutes, "B0" is 100 minutes.

How to use washer

Before washing clothes for the first time, you must run a complete cycle without clothes.

To do these:

1. Attach the drain hose to drain.
2. Connect the inlet hoses well and turn on the tap.
3. After making sure the power socket is grounded reliably, plug the cord into outlet.
4. Press "Power" and then "Start / Pause".

The remaining water inside the washing machine resulted from tests by the producer is driven out.

Preparation of Clothes

1. Sort the laundry by colour and by care label. Most garments have a textile care label in the collar or side seam.
2. Be sure to remove things such as keys, pins and coins from the laundry.
3. Tie the strings/straps of aprons, pillowcases and the like, close any fasteners and reverse the garments. (See Figure 1)

Level

Press the button you can change water level according to requirements. Do not press the button in the state of no water, the impeller will rotate, and the need water level can be detected according to the volume.

Child Lock

To avoid the child's abnormal operation out of curious, can start the child lock to lock the button. Press "Level" & "Prog." for 3 seconds, the Child-Lock can be safely locked or canceled.

4. Dark textiles often contain excess dye and should be washed separately several times before being included in a mixed load. Always wash whites and coloureds separately.
5. Do not put clothes with poor water absorbency into the washing machine.
6. Pre-treat dirt before putting clothes into the washing machine. A little detergent can be applied to stains previously so that they can be cleaned more easily. (See Figure 2)
7. Turn inside out any garments which give off lint or lint balls. (See Figure 3)
8. Put clothing with lace lingerie, nylon stockings, chemical fiber transparent fabrics etc. in a store-bought washing net.



Figure 1



Figure 2



Figure 3

Put Clothes into the Washing Machine

1. Loosen the clothes before putting them into the washing machine.
2. Each load should be under the rated capacity. Do not overload the washing machine every time.
3. Different thickness / sizes / categories of the laundry can affect the actual load capacity. It is advisable to load the amount of clothes that allows normal overturning during washing.

Washing Steps

1. Open the cover and load laundries.
 2. Add adequate detergent and softener according to the washing amount, and then close the cover.
 3. Press the "Power" button to connect the power.
 4. Press the "Program" button to select your required washing procedure.
 5. Press the "Start/Pause" button to start washing.
 6. When the washing is finished, a warning tone sounds; after the warning tone is off, the power will be turned off automatically.
- Please refer to the below table for washing procedures.

Washing by Initial Procedure

The washing machine turns to "Standard" as initial after being turned on. The operations are as the below:

1. Turn on the inlet tap.
2. Open the cover and put laundries piece by piece into the washing machine.
3. Add adequate detergent and softener; then close the drawer.
4. Close the cover.
5. Press the "Power" button to connect the power.
6. Press the "Start/Pause" button to start the washing machine; then the washing procedure is started.

First Use

Carry out a complete washing process without loading any laundries for the first time.

Detailed Operations:

1. Connect the power and inlet hose.
2. Turn on the tap
3. Press "Power" and then "Start/Stop"

The remaining water inside the washing resulted from tests by the producer is driven out .

Washing Finish

After any procedures finishes, the washing machine will sound automatically to remind you to take out the clothes or to re-use.

Detergent amount

Detergent type Water level (Laundry amount)	Powdre	Liquid
8	Approx. 47g	Approx. 69ml
7	Approx. 45g	Approx. 64ml
6	Approx. 42g	Approx. 58ml
5	Approx. 40g	Approx. 53ml
4	Approx. 37g	Approx. 47ml
3	Approx. 33g	Approx. 41ml
2	Approx. 30g	Approx. 35ml
1	Approx. 25g	Approx. 30ml

Please pour the detergent into the tub after putting in the clothes that need to be washed.

Manual Selecting

You can control washing manually instead of using the initial setting.

The operations are as follows:

1. Turn on the inlet tap.
2. Open the cover and put the laundries piece by piece into the washing machine.
3. Add adequate detergent, then close the drawer and the cover.
4. Press the "Power" button to connect the power.
5. Press the "Program" button, select the required producedure.
6. Press the "Level" button, select the required water level.
7. Press the "Start/Pause" button to start washing.

Electric diagram

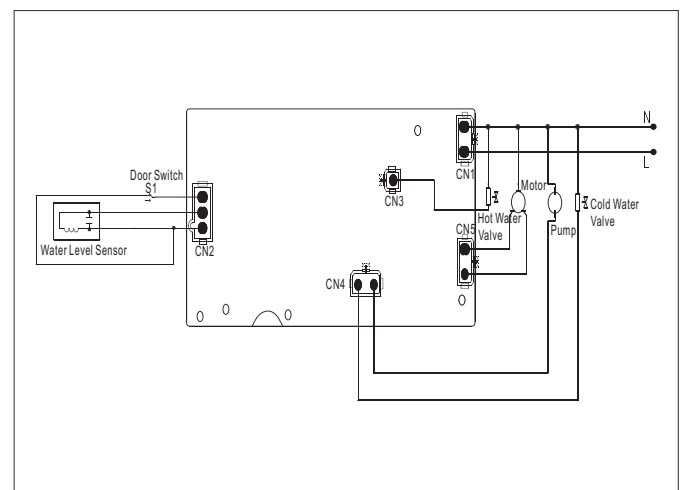

Cleanness and Maintenance

 Before maintenance, please disconnect the power plug.

Maintenance Method

Cleaning for Line Debris Filter

When in cleaning, you must use a line debris filter.

After each use, you must clean it in time. Please clean it according to the following steps:

- 1.Take off the line debris filter. As shown in the figure, press the claw of the filter by hands, and then draw it upward.
- 2.Overtum the wastepaper box, and then clean the wastepaper box and the filter.
- 3.Hold the handle of the filter, you can install it by pressing handle; make sure the filter claw be embedded into a corresponding part.

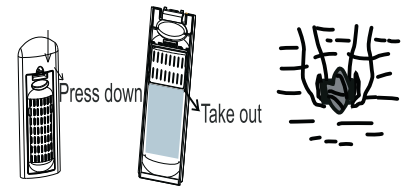

Cleaning the Water Filter

●After being used for long time, the water inlet filter may be blocked by fouling, clean it according to the following steps:

- 1.Close the tap and connect to the power.
- 2.Start the washing machine for 5 seconds (make the water in the inlet hose flow into the washing drum),and then cut off the power.
- 3.Remove the inlet hose, clean the removable feed valve and feed screen, and then install them well again.

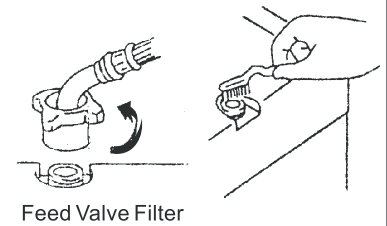

Troubleshooting guide

Symptom	Possible Cause	Solutions
E1	1.Is the inlet hose well connected? 2.Is the tap turned on? 3.Is the water inlet filter blocked? 4.Is the inlet hose frozen?	Connect the inlet hose properly (see P4, P5). Turn on the tap. Clean the water inlet filter (see P8). Solve the frozen problem .
E2	Is the cover closed well?	Close the cover well.
E3	1.Is the drain hose installed properly? 2.Is the drain hose blocked by heavy object? 3.Is the drain hose bent? 4.Is the drain hose blocked by extraneous matter? 5.Is there water frozen inside the hose?	Lay down the drain hose. Take the heavy object away. Straighten out the drain hose. Clean out the extraneous matter inside the hose. Defreeze the hose with water of 50°C
E4	This is not a failure. Since distribution of clothes inside the drum is not even, the washing machine can not run normally in dehydration?	Put the clothing into the drum well, and restart the washing procedure.
E5	1.Whether is the wire connected? 2.Whether is the switch sensor beyond the normal range value? 3.Whether the air pipe leak?	Based on the schematic wiring diagram to connect the wire. Change new switch sensor. Change new air pipe.
E6	1.Is there any problem with inlet valve? 2.Whether is water frequency value beyond over fall value?	Change new inlet valve. Restart to wash chosen program.
The washing machine can't be started.	1.Is the washing machine connected to power? 2.Is the power fuse disconnected? 3.Is the cover closed well? 4.Is the "Start/Pause" pressed?	Connect to the power and plug the socket . Replace the broken fuse by a new one. Open the cover and close it . Press "Start/Pause".
Intensive vibration or noise.	1.Is the washing machine placed on uneven ground? 2.Are clothes inside the inner drum of the washing machine in even distribution ?	Locate the washing machine on even ground and adjust the adjustable feet to make the machine level. Distribute laundries inside the inner drum again to reach good balance.
Too much bubboe	1.Is to much cleaning agent added? 2.Is cleaning agent with few bubbles that is special for full auto washing machines applied?	Add adequate cleaning agent. Use cleaning agent properly.
Water inlet cannot Stop	It is caused bu abnormality of the inlet valve or the level sensor.	Turn off the tap and disconnect the power plug, and then contact After-Sales Service Department.

If there are other problems that cannot be solved, please contact local After-Sales Service Center with failure details.

Technical parameters

Model Parameters	ETL600W
Power	220-240V~;50Hz
Washing Capacity	6.0kg
Spin Capacity	6.0kg
Input Power Wash/Spin	350W/300W
Standard Waster Pressure	0.02-0.8MPa
Noise	60dB(A) (washing) 68dB(A) (spin)
Net Weight/Gross Weight	25kg/29kg
Outer Dimension (WxDxH)mm	526x540x890

Note: Please be excused for not being informed if any changes of the above parameters happen. Please be subject to those marked values on the Rating Label adhered to the washing machine.

EVOKE

**Imported by Worldwide Appliances Pty Ltd
A.B.N. 45868077422**

**Distributed by Eurolinx Pty Ltd
48-50 Moore Street, Leichhardt N.S.W 2040
Post:**

**Locked Bag 3000, Annandale, N.S.W 2038
P: 1300 694 583**

WARRANTY REGISTRATION

Your ongoing satisfaction with your EVOKE product is important to us. We ask that you complete the enclosed Warranty Registration Card and return it to us so that we have a record of the EVOKE product purchased by you.

PRIVACY

Worldwide Appliances respects your privacy and is committed to handling your personal information in accordance with the National Privacy Principles and the Privacy Act 1988 (Cth). A copy of the Worldwide Appliances Privacy Policy is available at www.evokeappliances.com.au. Worldwide Appliances will not disclose any personal information set out in the Warranty Registration Card ("Personal Information") without your consent unless required by:

1. law;
2. any Worldwide Appliances related company;
3. any service provider which provide services to EVOKE or assist EVOKE in providing services (including repair and warranty services) to customers. Our purpose in collecting the Personal Information is to keep a record of the EVOKE product purchased by you, in order to provide a better warranty service to you in the unlikely event that there is a problem with your EVOKE product. Worldwide Appliances may contact you at any one or more of the address, email address or telephone numbers set out in the Warranty Registration Card. Please contact EVOKE on 1300 694 583 should you not wish to be contacted by Worldwide Appliances.

WARRANTY

1. Warranty

Worldwide Appliances warrants that each EVOKE product will remain, for a period of either 12 months or 24 months of warranty. All Warranties are valid from the original date of purchase, And warranty claims must be accompanied by the proof of purchase.

24 months warranty products:

Dishwashers - Freestanding, Fully Integrated, Semi Integrated and built-in. All Dryers, all washing machines.

2. What is not Covered by the Warranty.

The Warranty does not apply if an EVOKE product is defective by a factor other than a defect arising in the manufacture of the EVOKE product, including but not limited to:

- (a) damage through misuse (including failure to maintain, service or use with proper care), neglect, accident or ordinary wear and tear (including deterioration of parts and accessories and glass breakage);
 - (b) use for purpose for which the EVOKE product was not sold or designed;
 - (c) use or installation which is not in accordance with any specified instructions for use or installation;
 - (d) use or operation after a defect has occurred or been discovered;
 - (e) damage through freight, transportation or handling in transit (other than when Worldwide Appliances is responsible);
 - (f) damage through exposure to chemicals, dusts, residues, excessive voltage, heat, atmospheric conditions or other forces or environmental factors outside the control of Worldwide Appliances;
 - (g) repair, modification or tampering by the purchaser or any person other than Worldwide Appliances, an employee of Worldwide Appliances or an authorised EVOKE service contractor*;
 - (h) use of parts, components or accessories which have not been supplied or specifically approved by EVOKE.
 - (i) damage to surface coatings caused by cleaning or maintenance using products not recommended in the EVOKE product handbook provided to the purchaser upon purchase of the EVOKE product;
 - (j) damage to the base of an electric oven due to items having been placed on the base of the oven cavity or covering the base, such as aluminium foil (this impedes the transfer of heat from the element to the oven cavity and can result in irreparable damage); or
 - (k) damages, dents or other cosmetic imperfections not affecting the performance of the EVOKE in respect of an EVOKE product purchased as a "factory second" or from display
- The Warranty does not extend to light globes used in EVOKE products.

3. Domestic Use

Each EVOKE product is made for domestic use. This Warranty may not extend to EVOKE products used for commercial purposes.

Continued over...

4. Time for Claim under the Warranty

You must make any claim under this Warranty within twenty eight (28) days after the occurrence of an event which gives rise to a claim pursuant to the Warranty, by booking a service call on the telephone number below.

5. Proof of Purchase

Customers must retain proof of purchase in order to be eligible to make a warranty claim in respect of an EVOKE product.

6. Claiming under the Warranty

Customers will bear the cost of claiming under this Warranty unless Worldwide Appliances determines the expenses are reasonable, in which case the customer must claim those expenses by providing written evidence of each expense to Worldwide Appliances at the address on the Warranty Registration Card.

7. Statutory Rights

(a) These terms and conditions do not affect your statutory rights.

(b) The limitations on the Warranty set out in this document do not exclude or limit the application of the consumer guarantees set out in the Act or any other equivalent or corresponding legislation in the relevant jurisdiction where to do so would:

(i) contravene the law of the relevant jurisdiction; or

(ii) cause any part of the Warranty to be void.

(c) Worldwide Appliances excludes indirect or consequential loss of any kind (including, without limitation, loss of use of the EVOKE product) and (other than expressly provided for in these terms and conditions) subject to all terms,

conditions and warranties implied by custom, the general law, the Act or other statute.

(d) The liability of Worldwide Appliances to you for a breach of any express or non-excludable implied term, condition or warranty is limited at the option of Worldwide Appliances to:

(i) replacing or repairing the defective part of the EVOKE product;

(ii) paying the cost of replacing or repairing the defective part of the EVOKE product;

(iii) replacing the EVOKE product; or

(iv) paying the cost of replacing the EVOKE product.

(e) Our goods come with guarantees that cannot be excluded under the Australian Consumer Law. You are entitled to a replacement or refund for a major failure and for compensation for any other reasonably foreseeable loss or damage. You are also entitled to have the goods repaired or replaced if the goods fail to be of acceptable quality and the failure does not amount to a major failure.

8. Defects

Any part of an EVOKE product deemed to be defective and replaced by Worldwide Appliances is the property of Worldwide Appliances. Worldwide Appliances reserves the right to inspect and test EVOKE products in order to determine the extent of any defect and the validity of a claim under the Warranty.

All warranty service calls must be booked via the customer care department. The team can be contacted on 1 300 85 64 11 option 1 or customercare@eurolinx.com.au

01072021

EVOKE

Warranty Card tear off

WARRANTY REGISTRATION CARD
01072021

Please complete and send to EVOKE at: REPLY PAID 83617
LEICHHARDT NSW 2040

Last Name:		First Name:
Address:		
State:	Postcode:	Email:
Home Phone:		Mobile:
Purchase Date: / /		(Please attach proof of purchase to validate warranty)

MODEL NUMBER	SERIAL NUMBER (if you cannot locate the serial number please call EVOKE on 1300 856 411)
1	
2	
3	
4	

01072021

