

# Your washing machine

**Congratulations** – You have opted for a modern, high-quality domestic appliance manufactured by Bosch. The washing machine is distinguished by its economical energy consumption.

Each appliance which leaves our factory is inspected thoroughly to ensure that it functions properly and is in perfect condition.

For further information and a selection of our products go to our web site: [www.bosch-home.com](http://www.bosch-home.com)

**Environmental disposal**

Dispose of packaging in an environmentally friendly manner.

This appliance has been identified in accordance with the European Directive 2002/96/EG on Waste Electrical and Electronic Equipment (WEEE).

The Directive specifies the framework for an EU-wide valid return and recycling of waste appliances.

# Contents

Intended use	1
Programmes	1
Setting programme	3
Washing	3/4
After washing	4
Individual settings	5
Important information	6
Overview of programmes	7
Safety instructions	8
Consumption values	8
Care	9
Information on the display panel	9
Maintenance	10
What to do if ...	11

## Intended use

- for use in the household only,
- for the washing of machine-washable textiles in a detergent solution,
- to be operated with cold drinking water and commercially available detergents and care products which are suitable for use in frontloading-washing machines.

**Do not leave children unattended near the washing machine!**

- The appliance is not intended for use by young children or infirm persons without supervision.
- Keep pets away from the washing machine!

## Programmes

For detailed overview of programmes -> *page 7*.  
Temperature and spin speed can be selected individually.

Cottons	hard-wearing textiles
Cottons Eco	hard-wearing textiles
Cottons Prewash	hard-wearing textiles
Cottons Easy-iron	hard-wearing textiles
Easy-Care	easy-care textiles
Easy-Care Intensive	easy-care textiles
Easy-Care Prewash	easy-care textiles
Mixed Load	easy-care textiles
Delicate/Silk	delicate washable textiles
Wool	hand/machine-washable textiles
Express 15'	short programme
Rinse/Freshen up	with subsequent spin cycle; for hand-washed items, starching or "freshen up" items, -> <i>Page 6</i> .
Spin	washing washed by hand
Drain	the rinsing water if ---- occurs

## Preparation

**Correct installation according to separate installation instructions.**

**Checking the machine**

- Never switch on a damaged machine!
- Inform your customer service!

**Turn on water tap**

**Insert mains plug**

**With dry hands only! Take hold of the plug only!**

**Sorting and inserting the washing**

Follow manufacturer's care information! According to the information on the care labels. According to type, colour, soiling and temperature. Do not exceed maximum load -> *Page 7*.

Follow important instructions! See *page 6!*

Insert large and small items of washing! Close the washing machine door. Take care not to trap any items of clothing between the loading door and rubber seal.

**Add detergent and care product**

Meter accordingly: Washing amount, soiling, water hardness (ask your water supply company) and manufacturer's instructions. Pour liquid detergent into the appropriate dispenser and place in the drum.

**Dispenser I:** Detergent for prewash  
**Dispenser II:** Fabric softener, starch  
**Dispenser III:** Detergent for main wash, fabric softener, bleaching agent, stain remover

Dilute viscous fabric softener and fabric conditioner with water. Prevents blockage of the overflow.

## Set and adjust programme

For additional functions and option buttons see *individual settings, page 5*.

**Programme selector for switching the machine on and off and for selecting the programme. Can be rotated in either direction.**

**Select Start/Pause**

---- - 1200*	Select the spin speed (* depending on model) or ---- (without final spin)
cold - 90	Select the temperature
1 - 24h	Programme starts in ...

# Washing

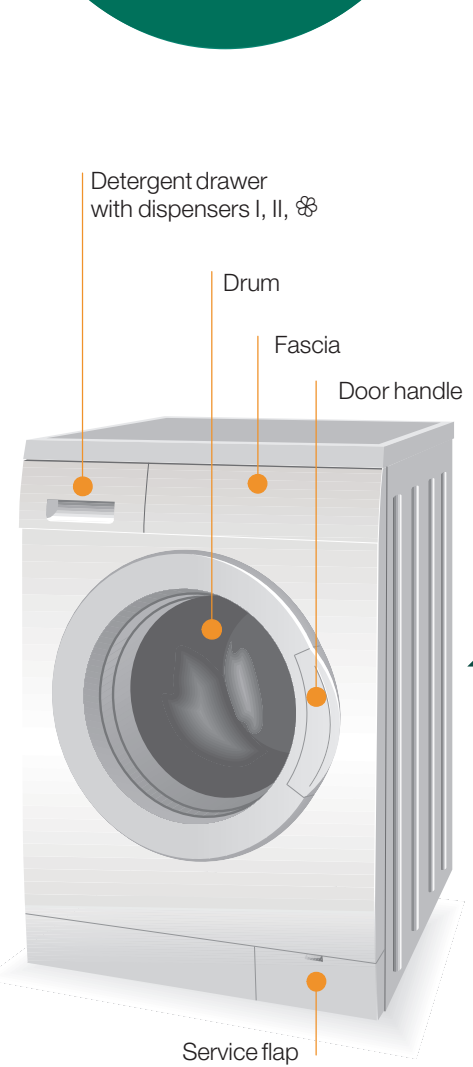

1  
2  
3

# Washing

## Removing washing

Open washing machine door and remove washing.

If ---- (without final spin) active: Set programme selector to **Drain** or select spin speed. Select **Start/Pause**. Remove any foreign objects – risk of rusting.

## Turn off tap

## Switch off

Set programme selector to **Off**.

## End of programme when ...

... indicator light **Spin** flashes and **End** is indicated on the display panel.

## Change programme ...

If you have mistakenly selected a wrong programme:

- Reselect programme.
- Select **Start/Pause**.

## ...or terminate

Programmes with high temperature, first:

- Cool washing: Select **Rinse/Freshen up**.
- Washing machine door remains locked.
- Select **Off**.
- Select **Spin** or **Drain**.
- Select **Start/Pause**.

## Individual settings

**Option buttons**

You can change the spin speed and temperature beforehand and while the selected programme is running. Effects dependent on the programme progress.

**(spin speed rpm)**

You can change the indicated spin speed. The maximum spin speed which can be selected depends on the set programme.

**(Temperature °C)**

You can change the indicated washing temperature. The maximum washing temperature which can be selected depends on the set programme.

**(Start in)**

The respective programme duration is displayed by selecting the programme. The programme start can be delayed before the programme begins. The Start in-time can be set in hour-steps up to maximum 24h. Keep pressing the button until the required number of hours is indicated (h=hour). Select **Start/Pause**. The start in-time begins counting down as soon as the programme starts. This indicated by the flashing indicator lights **Start/Pause**, **Wash** and by the flashing apostrophe ' between the number and h.

**Additional functions** see also *programme overview*

Rinse plus Additional rinse cycle. For areas with very soft water or for further improvement of the rinsing result.

**Start/Pause**

For starting or interrupting the programme.

## Important information

**Protecting the washing and the machine**

- Empty pockets.
- Remove metal parts (paper clips, etc.).
- Wash delicates in the net/bag (tights, curtains, underwired bras).
- Close zips, button up covers.
- Brush sand out of pockets and collars.
- Remove curtain fittings or include in the net/bag.

**Before washing for the first time**

Do not put any washing in the washing machine! Turn on the tap, fill approx. 1 litre of water and then pour ½ measuring cup of detergent into dispenser II. Set programme selector to **Easy-Care 60 °C** and select **Start/Pause**. At the end of the programme set the programme selector to **Off**.

**Washing with different degrees of soiling**

Light	Wash new items separately.
Medium	Do not prewash.
Heavy	If required, pretreat stains. Select <b>Cottons Stains</b> additional function.
	Load less washing.
	Prewash.

**Soaking** Load washing of the same colour

Pour soaking agent/detergent into dispenser II according to the manufacturer's instructions. Set programme selector to **Cottons 30 °C** and select **Start/Pause**. After approx. 10 minutes select **Start/Pause**. After the required soaking time reselect **Start/Pause** if the programme is to be continued or change the programme.

**Starching** Washing should not be treated with fabric softener

Liquid starch can be used in all wash programmes. Meter starch into the fabric softener dispenser according to manufacturer's specifications.

**Dyeing/bleaching**

Dye in small quantities only. Salt can corrode stainless steel. Observe the dye manufacturer's specification. Do not bleach laundry in the washing machine.

**Freshen up** Use programme **Rinse/Freshen up**

For items, that have been tucked away or stored for a period of time, to remove creases caused by folding and storage and to eliminate odours. Use fabric conditioner for "fresh" smell.

**Protection of the environment/conservation tips**

- Utilise the maximum amount of washing for the particular programme.
- Wash normally soiled washing without prewash.
- Instead of **Cottons Stains 90 °C** select **Cottons Eco 60 °C** programme. Comparable cleaning result with significantly lower energy consumption.
- Meter detergent according to the manufacturer's instructions and water hardness.
- If the washing is then dried in the tumble dryer, select spin speed according to the instructions of the dryer manufacturer.



Programmes	°C	Max.	Type of washing	Additional functions; information
Cottons	cold-60 °C			
Cottons	cold-90 °C	6.5 kg	Hard-wearing textiles, heat-resistant textiles made of cotton or linen	Rinse plus
Cottons	cold-60 °C			
Cottons	cold-90 °C			
Cottons	cold-60 °C			
Easy-Care		3 kg	Easy-care textiles made of cotton, linen, synthetic fibres or blended fabrics	Rinse plus
Easy-Care	cold-60 °C			
Easy-Care				
Mixed Load	cold-40 °C		Textiles made of cotton and easy-care textiles	Rinse plus ; Different types of washing can be washed together
Delicate/Silk	cold-40 °C		For delicate, washable textiles, e.g. made of silk, satin, synthetic fibres or blended fabrics (e.g. curtains)	Rinse plus ; no spin cycle between the rinse cycles
Wool/	cold-40 °C	2 kg	Hand or machine-washable wool or rich-wool textiles	Especially gentle wash programme to prevent shrinkage, prolonged programme pauses (textiles rest in the detergent solution).
Express 15'	cold-40 °C		Easy-care textiles made of cotton, linen, synthetic fibres or blended fabrics	Short programme approx. 15 minutes; suitable for refreshing

**Additional programmes**  
 Programmes without prewash – pour detergent into dispenser **II**, programmes with prewash – divide detergent between dispensers **I** and **II**.

Robert Bosch Hausgeräte GmbH  
 Carl-Wery Str. 34  
 81739 München / Germany

WAE24271AU  
 WAE20261AU

9000 355 204  
 1009

## Safety instructions

- Read and follow the operating and installation instructions and all other information enclosed with the washing machine.
  - Retain documents for subsequent use.
- Risk of electric shock**
- Never pull out the mains plug by tugging the power cord!
  - Never insert/pull out the mains plug with damp hands.
  - Washing machine door may become very hot.
  - Caution when draining hot detergent solution.
  - Do not climb on the washing machine.
  - Do not lean on the open washing machine door.
  - Do not touch the drum in case it is still spinning.
  - Caution when opening the detergent drawer while washing machine is running!
- Risk of injury**
- Keep detergents and care products out of the reach of children.
  - Keep packaging, plastic film and packaging parts out of the reach of children.
- Risk of poisoning**
- Risk of suffocation**
- Danger to life**
- On redundant appliances:
- Pull out the mains plug.
  - Sever the power cord and discard together with the plug.
  - Destroy the lock on the washing machine door. This will prevent children from locking themselves in and suffocating.
- Risk of explosion**
- Caused by detergents containing solvents, e.g. stain remover/ items of washing pretreated with solvent naphtha may result in an explosion after being loaded into the washing machine. Beforehand thoroughly rinse items of washing by hand.

## Consumption values

Programme	Load	Current**	Water**	Programme duration**
Cottons   40 °C *	6.5 kg	0.65 kWh	56 l	2:51 h
Cottons   60 °C	6.5 kg	1.30 kWh	56 l	3:09 h
Cottons   60 °C	6.5 kg	1.19 kWh	47 l	2:35 h
Cottons   90 °C	6.5 kg	2.00 kWh	66 l	2:31 h
Easy-Care  40 °C	3 kg	0.55 kWh	48 l	0:59 h
Mixed Load  30 °C	3 kg	0.35 kWh	48 l	0:52 h
Delicate/Silk  30 °C	2 kg	0.28 kWh	48 l	0:44 h
Wool/ 30 °C	2 kg	0.20 kWh	32 l	0:53 h

- \* Programme setting with maximum spin speed for testing according to or in accordance with AS/NZS 2040.2 and AS/NZS 6400.
- \*\* The values deviate from the indicated values depending on water pressure, water hardness, water inlet temperature, room temperature, type and amount of washing and degree of soiling, utilised detergent, fluctuations in the mains voltage and selected additional functions.

## Care



### Machine housing, control panel

- Wipe with a soft, damp cloth.
- Do not use any abrasive cloths, sponges or cleaning agents (stainless-steel cleaner).
- Immediately remove washing and cleaning agent residue.
- Do not clean the appliance with a water jet.



### Clean the detergent drawer ...

... if it contains detergent or fabric softener residue.

1. Pull out, depress insert, completely remove.
2. Open the cover.
3. Clean with water and dry.
4. Close and lock the cover (place cylinder on guide pin).
5. Insert detergent drawer.

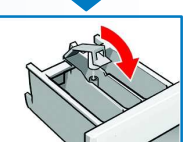
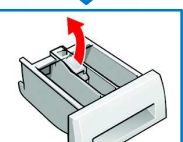
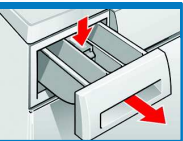

Leave detergent drawer open so that residual water can evaporate.

## Drum

Leave washing machine door open so that the drum can dry out.  
 Rust stains – use chlorine-free cleaning agent, not steel wool.



### Descaling No washing in the machine!

Descale according to the instructions of the descaling agent manufacturer, not required for correct detergent dosage

## Information on the display panel

E2	Motor fault. Call customer service!
E3	Close the washing machine door properly; washing may be caught.
E5	Turn on the tap, supply hose kinked/jammed; clean filter -> <i>page 10</i> , water pressure too low.
E6	Detergent solution pump blocked; clean the detergent solution pump -> <i>page 10</i> . Drainage hose / waste pipe blocked; clean the drainage hose at the siphon -> <i>page 10</i> .
E8	Turn off the tap and call customer service.

## Maintenance



### Detergent-solution pump

Set programme selector to **Off**, pull out the mains plug.

1. Open and remove service flap.

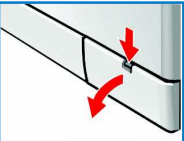

2. For models with drainage hose: Take drainage hose out of the holder and pull out of the housing. Remove sealing cap, allow detergent solution to flow out. Press on sealing cap and insert drainage hose into the holder.



- 2\* For models without drainage hose: Carefully unscrew pump cover until the detergent solution begins to run out. When the service flap is half full, screw back the pump cover and empty the service flap. Repeat steps until all the detergent solution has run out.

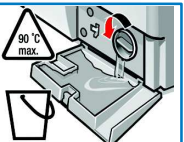

3. Carefully unscrew the pump cover (residual water).

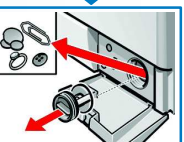

4. Clean the interior, pump cover thread and pump housing (fan impeller in the detergent-solution pump must rotate).



To prevent unused detergent from flowing into the outlet during the next wash: Pour 1 litre of water into dispenser **II** and select the **Drain** programme.



### Drainage hose at the siphon

Set programme selector to **Off**, pull out the mains plug.



1. Loosen the hose clamp, carefully remove the drainage hose (residual water).
2. Clean the drainage hose and siphon connecting piece.
3. Reattach the drainage hose and secure the connection with the hose clamp.



### Filters in the water supply

Release water pressure in the supply hose:

1. Turn off the tap!
2. Select any programme (except **Spin/Drain**).
3. Press **Start/Pause** . Leave programme for approx. 40 seconds.
4. Set programme selector to **Off**.
5. Remove hose from tap.
6. Clean filter with small brush.
7. Depending on the model, remove hose from the rear of the appliance and clean the filter.
8. Connect the hose and check for leaks.

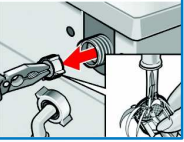

## What to do if ...

- Water is running out.
  - Correctly attach/replace drainage hose.
  - Tighten screw-fitting on the supply hose.
- Water not flowing in. Detergent not washed in.
  - **Start/Pause** not selected?
  - Tap not open?
  - Filter blocked? Clean filter -> *page 10*.
  - Supply hose kinked or jammed?
  - Safety function active. Wait approx. 2 minutes.
  - ---- (without final spin) selected?
- Washing machine door cannot be opened.
  - **Start/Pause** selected?
  - Door closed?
  - Clean detergent-solution pump -> *page 10*.
  - Clean outlet pipe and/or drainage hose.
- Programme does not start.
  - Distribute small and large items of washing in the drum.
- Detergent solution is not drained.
  - Not a fault – unbalanced load detection system adjusts imbalance.
- Washing not spun correctly.
  - Not a fault – water below the visible area
- Spin cycle actuated several times.
  - Not a fault – effect of the care product not impaired.
- Water not visible in the drum.
  - Not a fault – effect of the care product not impaired.
- Residual water in the dispenser for care product.
  - Run **Cottons** **90 °C** programme without washing. Use standard detergent.
- Odour formation in the washing machine.
  - Too much detergent used? Mix 1 tablespoon of fabric softener with ½ litre of water and pour into compartment **II** (*not with outdoor fabrics!*).
  - Reduce detergent dosage for the next wash cycle.
- Foam is coming out of the detergent drawer.
  - Appliance feet fixed? Secure appliance feet -> *Installation instructions*.
  - Transportation safety devices removed? Remove transportation safety devices -> *Installation instructions*.
- Vibrations during spin cycle.
  - Power failure?
  - Fuse tripped? Switch on/replace fuse.
  - If the fault occurs repeatedly, call customer service.
- Display panel/indicator lights do not function while the appliance is running.
  - Not a fault – unbalanced load detection system adjusts imbalance by repeatedly distributing the washing.
  - Not a fault – foam detection system active - a rinse cycle is started.
- Programme progress longer than usual.
  - Occasionally phosphate-free detergents contain water-insoluble residue.
  - Select **Rinse/Freshen up** or brush the laundry after washing.
- Detergent residue on the washing.
  - If a fault cannot be rectified or a repair is required:
    - Set programme selector to **Off** and pull out the mains plug.
    - Turn off the tap and call customer service -> *Installation instructions*.

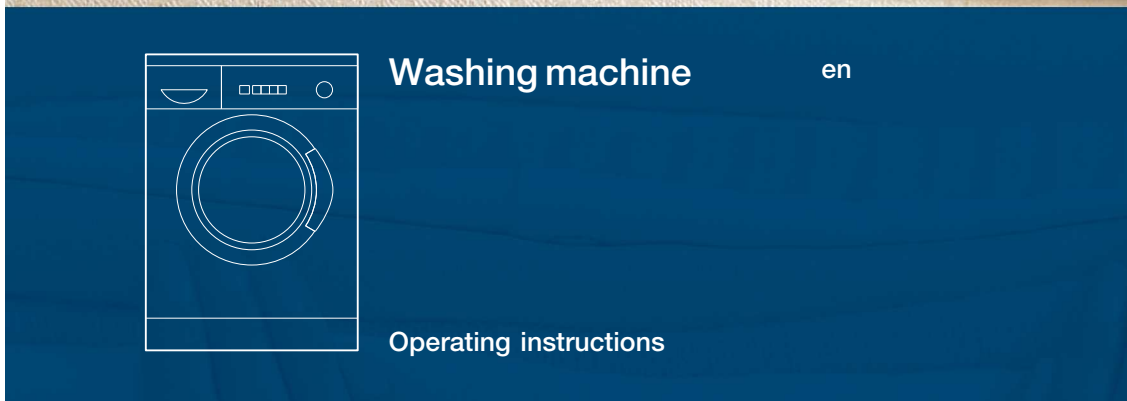

**Read these instructions before switching on the washing machine!**  
 Also follow the separate installation instructions.  
 Follow the safety instructions on page 8!





# Your washing machine

**Congratulations** – You have opted for a modern, high-quality domestic appliance manufactured by Bosch. The washing machine is distinguished by its economical energy consumption.

Each appliance which leaves our factory is inspected thoroughly to ensure that it functions properly and is in perfect condition.

For further information and a selection of our products go to our web site: [www.bosch-home.com](http://www.bosch-home.com)

## Environmental disposal

Dispose of packaging in an environmentally friendly manner.

This appliance has been identified in accordance with the European Directive 2002/96/EG on Waste Electrical and Electronic Equipment (WEEE).

The Directive specifies the framework for an EU-wide valid return and recycling of waste appliances.



## Contents

Page

Intended use	1
Programmes	1
Setting programme	3
Washing	3/4
After washing	4
Individual settings	5
Important information	6
Overview of programmes	7
Safety instructions	8
Consumption values	8
Care	9
Information on the display panel	9
Maintenance	10
What to do if ...	11

## Intended use

- for use in the household only,
- for the washing of machine-washable textiles in a detergent solution,
- to be operated with cold drinking water and commercially available detergents and care products which are suitable for use in frontloading-washing machines.

- Do not leave children unattended near the washing machine!
- The appliance is not intended for use by young children or infirm persons without supervision.
- Keep pets away from the washing machine!

## Preparation

Correct installation according to separate installation instructions.

### Checking the machine

- Never switch on a damaged machine!
- Inform your customer service!

### Turn on water tap

### Insert mains plug

With dry hands only!  
Take hold of the plug only!

Dilute viscous fabric softener to avoid overflow.

## Programmes

For detailed overview of programmes → page 7.

Temperature and spin speed can be selected individually.

Cottons	hard-wearing textiles
Cottons Stains	
Cottons Eco	
Cottons Prewash	
Cottons Easy-iron	
Easy-Care	easy-care textiles
Easy-Care Intensive	
Easy-Care Prewash	
Mixed Load	easy-care textiles
Delicate/Silk	delicate washable textiles
Wool	hand/machine-washable textiles
Express 15'	short programme
Rinse/Freshen up	with subsequent spin cycle; for hand-washed items, starching or "freshen up" items, → Page 6.
Spin	washing washed by hand
Drain	the rinsing water if ---- occurs

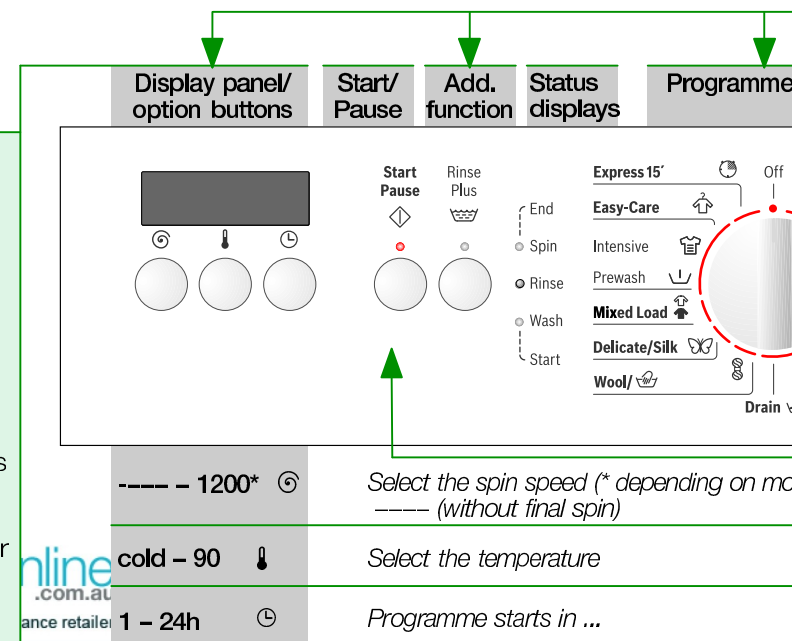

Before washing for the first time,  
wash once without any washing. -> page 6

## Sorting and inserting the washing

Follow manufacturer's care information!  
According to the information on the care labels.  
According to type, colour, soiling and temperature.  
Do not exceed maximum load -> Page 7.

Follow important instructions! See page 6!

Insert large and small items of washing! Close the washing machine door. Take care not to trap any items of clothing between the loading door and rubber seal.

## Add detergent and care product

Meter accordingly:  
Washing amount, soiling, water hardness (ask your water supply company) and manufacturer's instructions. Pour liquid detergent into the appropriate dispenser and place in the drum.

**Dispenser I:** Detergent for prewash  
**Dispenser II:** Fabric softener, starch  
**Dispenser III:** Detergent for main wash, fabric softener, bleaching agent, stain remover  
Fabric softener and fabric conditioner with water. Prevents blockage of the

## Set and adjust programme

For additional functions and option buttons see individual settings, page 5.



Programme selector for switching the machine on and off and for selecting the programme. Can be rotated in either direction.

Select Start/Pause ◀▶

selector

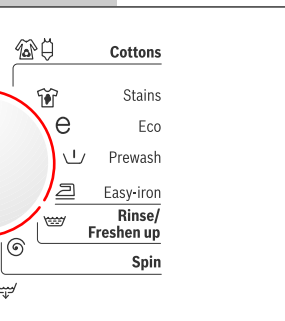

odel) or

# Washing

Detergent drawer with dispensers I, II, III

Drum

Fascia

Door handle

Service flap

# Washing

Australia's largest online appliance retailer

## Removing washing

Open washing machine door and remove washing.  
If ——— (without final spin) active: Set programme selector to **Drain** 🌀 or select spin speed. Select **Start/Pause** ◀▶.  
Remove any foreign objects – risk of rusting.

## Turn off tap

## Switch off

Set programme selector to **Off**.

## End of programme when ...

... indicator light **Spin** flashes and **End** is indicated on the display panel.

## Change programme ...

If you have mistakenly selected a wrong programme:  
– Reselect programme.  
– Select **Start/Pause** ◀▶.

## ...or terminate

Programmes with high temperature, first:  
– Cool washing: Select **Rinse/Freshen up** 🌀.  
Washing machine door remains locked.  
– Select **Off**.  
– Select **Spin** 🌀 or **Drain** 🌀.  
– Select **Start/Pause** ◀▶.

# Individual settings

## Option buttons

You can change the spin speed and temperature beforehand and while the selected programme is running. Effects dependent on the programme progress.

### ⌚ (spin speed rpm)

You can change the indicated spin speed. The maximum spin speed which can be selected depends on the set programme.

### 🌡️ (Temperature °C)

You can change the indicated washing temperature. The maximum washing temperature which can be selected depends on the set programme.

### ⌚ (Start in)

The respective programme duration is displayed by selecting the programme. The programme start can be delayed before the programme begins. The Start in-time can be set in hour-steps up to maximum 24h. Keep pressing the ⌚ button until the required number of hours is indicated (h=hour). Select **Start/Pause** ⏸. The start in-time begins counting down as soon as the programme starts. This indicated by the flashing indicator lights **Start/Pause** ⏸, **Wash** and by the flashing apostrophe ' between the number and h.

## Additional functions *see also programme overview*

Rinse plus 🌊 Additional rinse cycle. For areas with very soft water or for further improvement of the rinsing result.

### ⏸ (Start/Pause)

For starting or interrupting the programme.



# Important information



## Protecting the washing and the machine

- Empty pockets.
- Remove metal parts (paper clips, etc.).
- Wash delicates in the net/bag (tights, curtains, underwired bras).
- Close zips, button up covers.
- Brush sand out of pockets and collars.
- Remove curtain fittings or include in the net/bag.



## Before washing for the first time



Do not put any washing in the washing machine! Turn on the tap, fill approx. 1 litre of water and then pour ½ measuring cup of detergent into dispenser II. Set programme selector to

**Easy-Care** 🌡️ 60 °C and select **Start/Pause** ⏸.

At the end of the programme set the programme selector to **Off**.

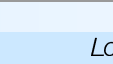

## Washing with different degrees of soiling

		Wash new items separately.
Light		Do not prewash.
		If required, pretreat stains. Select <b>Cottons</b> 🌡️ 🌡️ <b>Stains</b> 🌊 additional function.
Heavy		Load less washing.
		Prewash.



## Soaking *Load washing of the same colour*

Pour soaking agent/detergent into dispenser II according to the manufacturer's instructions. Set programme selector to **Cottons** 🌡️ 🌡️ 30 °C and select **Start/Pause** ⏸. After approx. 10 minutes select **Start/Pause** ⏸. After the required soaking time reselect **Start/Pause** ⏸ if the programme is to be continued or change the programme.



## Starching *Washing should not be treated with fabric softener*

Liquid starch can be used in all wash programmes. Meter starch into the fabric softener dispenser 🌊 according to manufacturer's specifications.



## Dyeing/bleaching

Dye in small quantities only. Salt can corrode stainless steel. Observe the dye manufacturer's specification. Do **not** bleach laundry in the washing machine.



## Freshen up *Use programme Rinse/Freshen up 🌊*

For items, that have been tucked away or stored for a period of time, to remove creases caused by folding and storage and to eliminate odours. Use fabric conditioner for "fresh" smell.



## Protection of the environment/conservation tips

- Utilise the maximum amount of washing for the particular programme.
- Wash normally soiled washing without prewash.
- Instead of **Cottons** 🌡️ 🌡️ **Stains** 🌡️ 90 °C select **Cottons** 🌡️ 🌡️ **Eco** 🌡️ 60 °C programme. Comparable cleaning result with significantly lower energy consumption.
- Meter detergent according to the manufacturer's instructions and water hardness.
- If the washing is then dried in the tumble dryer, select spin speed according to the instructions of the dryer manufacturer.

# Programme overview -> Pay attention to the Consumption values table on page 8 and the information on page 6

Programmes	°C	Max.	Type of washing	Additional functions; information
Cottons	cold-60 °C			
Cottons	cold-90 °C			
Cottons	cold-60 °C	6.5 kg	Hard-wearing textiles, heat-resistant textiles made of cotton or linen	Rinse plus
Cottons	cold-90 °C			
Cottons	cold-60 °C			
Easy-Care		3 kg		
Easy-Care	cold-60 °C		Easy-care textiles made of cotton, linen, synthetic fibres or blended fabrics	Rinse plus
Easy-Care				
Mixed Load	cold-40 °C		Textiles made of cotton and easy-care textiles	Rinse plus ; Different types of washing can be washed together
Delicate/Silk	cold-40 °C		For delicate, washable textiles, e.g. made of silk, satin, synthetic fibres or blended fabrics (e.g. curtains)	Rinse plus ; no spin cycle between the rinse cycles
Wool	cold-40 °C	2 kg	Hand or machine-washable wool or rich-wool textiles	Especially gentle wash programme to prevent shrinkage, prolonged programme pauses (textiles rest in the detergent solution).
Express 15'	cold-40 °C		Easy-care textiles made of cotton, linen, synthetic fibres or blended fabrics	Short programme approx. 15 minutes; suitable for refreshing
Additional programmes				
<div> <div>  Programmes without prewash – pour detergent into dispenser II, programmes with prewash – divide detergent between dispensers I and II. </div> <div> Rinse/Freshen up , Spin , Drain  </div> </div>				
			Robert Bosch Hausgeräte GmbH Carl-Wery Str. 34 81739 München / Germany	WAE24271AU WAE20261AU
			9000 355 204 1009	

## ! Safety instructions

- Read and follow the operating and installation instructions and all other information enclosed with the washing machine.
  - Retain documents for subsequent use.
- Risk of electric shock**
- Never pull out the mains plug by tugging the power cord!
  - Never insert/pull out the mains plug with damp hands.
- Risk of injury**
- Washing machine door may become very hot.
  - Caution when draining hot detergent solution.
  - Do not climb on the washing machine.
  - Do not lean on the open washing machine door.
  - Do not touch the drum in case it is still spinning.
  - Caution when opening the detergent drawer while washing machine is running!
- Risk of poisoning**
- Risk of suffocation**
- Keep detergents and care products out of the reach of children.
  - Keep packaging, plastic film and packaging parts out of the reach of children.
- Danger to life**
- On redundant appliances:
- Pull out the mains plug.
  - Sever the power cord and discard together with the plug.
  - Destroy the lock on the washing machine door. This will prevent children from locking themselves in and suffocating.
- Risk of explosion**
- Caused by detergents containing solvents, e.g. stain remover/ items of washing pretreated with solvent naphtha may result in an explosion after being loaded into the washing machine. Beforehand thoroughly rinse items of washing by hand.

## Consumption values

Programme	Load	Current**	Water**	Programme duration**
Cottons   40 °C *	6.5 kg	0.65 kWh	56 l	2:51 h
Cottons   60 °C	6.5 kg	1.30 kWh	56 l	3:09 h
Cottons   60 °C	6.5 kg	1.19 kWh	47 l	2:35 h
Cottons   90 °C	6.5 kg	2.00 kWh	66 l	2:31 h
Easy-Care  40 °C	3 kg	0.55 kWh	48 l	0:59 h
Mixed Load  30 °C	3 kg	0.35 kWh	48 l	0:52 h
Delicate/Silk  30 °C	2 kg	0.28 kWh	48 l	0:44 h
Wool   30 °C	2 kg	0.20 kWh	32 l	0:53 h

\* Programme setting with maximum spin speed for testing according to or in accordance with AS/NZS 2040.2 and AS/NZS 6400.

\*\* The values deviate from the indicated values depending on water pressure, water hardness, water inlet temperature, room temperature, type and amount of washing and degree of soiling, utilised detergent, fluctuations in the mains voltage and selected additional functions.

# Care



- Risk of electric shock!  
Pull out the mains plug!
- Risk of explosion! No solvents!



## Machine housing, control panel

- Wipe with a soft, damp cloth.
- Do not use any abrasive cloths, sponges or cleaning agents (stainless-steel cleaner).
- Immediately remove washing and cleaning agent residue.
- Do not clean the appliance with a water jet.



## Clean the detergent drawer ...

... if it contains detergent or fabric softener residue.

1. Pull out, depress insert, completely remove.
2. Open the cover.
3. Clean with water and dry.
4. Close and lock the cover (place cylinder on guide pin).
5. Insert detergent drawer.

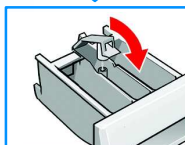
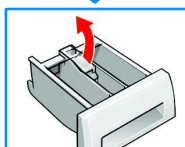
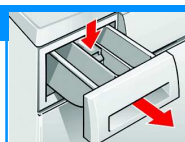

Leave detergent drawer open so that residual water can evaporate.



## Drum

Leave washing machine door open so that the drum can dry out.  
Rust stains – use chlorine-free cleaning agent, not steel wool.



## Descaling No washing in the machine!

Descale according to the instructions of the descaling agent manufacturer, not required for correct detergent dosage

# Information on the display panel

E2	Motor fault. Call customer service!
E3	Close the washing machine door properly; washing may be caught.
E5	Turn on the tap, supply hose kinked/jammed; clean filter -> page 10, water pressure too low.
E6	Detergent solution pump blocked; clean the detergent solution pump -> page 10. Drainage hose / waste pipe blocked; clean the drainage hose at the siphon -> page 10.
E8	Turn off the tap and call customer service.

# Maintenance



- Risk of scalding!  
Allow detergent solution to cool down!
- Turn off the tap!



## Detergent-solution pump

Set programme selector to **Off**, pull out the mains plug.

1. Open and remove service flap.
2. For models with drainage hose:  
Take drainage hose out of the holder and pull out of the housing.  
Remove sealing cap, allow detergent solution to flow out.  
Press on sealing cap and insert drainage hose into the holder.
- 2\* For models without drainage hose:  
Carefully unscrew pump cover until the detergent solution begins to run out.  
When the service flap is half full, screw back the pump cover and empty the service flap.  
Repeat steps until all the detergent solution has run out.
3. Carefully unscrew the pump cover (residual water).
4. Clean the interior, pump cover thread and pump housing (fan impeller in the detergent-solution pump must rotate).
5. Reinsert and screw on pump cover.
6. Insert and close service flap.

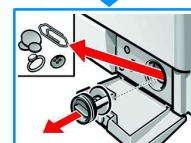
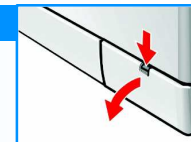

To prevent unused detergent from flowing into the outlet during the next wash:  
Pour 1 litre of water into dispenser II and select the **Drain** programme.



## Drainage hose at the siphon

Set programme selector to **Off**, pull out the mains plug.

1. Loosen the hose clamp, carefully remove the drainage hose (residual water).
2. Clean the drainage hose and siphon connecting piece.
3. Reattach the drainage hose and secure the connection with the hose clamp.

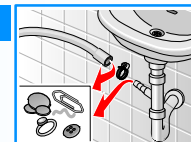

## Filters in the water supply

Release water pressure in the supply hose:

1. Turn off the tap!
2. Select any programme (except **Spin**/ **Drain**).
3. Press **Start/Pause** . Leave programme for approx. 40 seconds.
4. Set programme selector to **Off**.
5. Remove hose from tap.
6. Clean filter with small brush.
7. Depending on the model, remove hose from the rear of the appliance and clean the filter.
8. Connect the hose and check for leaks.

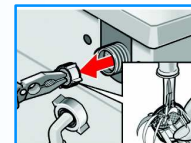



# What to do if ...

- Water is running out.
  - Correctly attach/replace drainage hose.
  - Tighten screw-fitting on the supply hose.
- Water not flowing in.  
Detergent not washed in.
  - **Start/Pause** ◊ not selected?
  - Tap not open?
  - Filter blocked? Clean filter → *page 10*.
  - Supply hose kinked or jammed?
- Washing machine door cannot be opened.
  - Safety function active. Wait approx. 2 minutes.
  - ----- (without final spin) selected?
- Programme does not start.
  - **Start/Pause** ◊ selected?
  - Door closed?
- Detergent solution is not drained.
  - Clean detergent-solution pump → *page 10*.
  - Clean outlet pipe and/or drainage hose.
- Washing not spun correctly.
  - Distribute small and large items of washing in the drum.
- Spin cycle actuated several times.
  - Not a fault – unbalanced load detection system adjusts imbalance.
- Water not visible in the drum.
  - Not a fault – water below the visible area
- Residual water in the dispenser for care product.
  - Not a fault – effect of the care product not impaired.
- Odour formation in the washing machine.
  - Run **Cottons** 🧺 **Stains** 🧺 **90 °C** programme without washing. Use standard detergent.
- Foam is coming out of the detergent drawer.
  - Too much detergent used?
  - Mix 1 tablespoon of fabric softener with ½ litre of water and pour into compartment II (*not with outdoor fabrics!*).
  - Reduce detergent dosage for the next wash cycle.
- Vibrations during spin cycle.
  - Appliance feet fixed?  
Secure appliance feet → *Installation instructions*.
  - Transportation safety devices removed?  
Remove transportation safety devices  
→ *Installation instructions*.
- Display panel/indicator lights do not function while the appliance is running.
  - Power failure?
  - Fuse tripped? Switch on/replace fuse.
  - If the fault occurs repeatedly, call customer service.
- Programme progress longer than usual.
  - Not a fault – unbalanced load detection system adjusts imbalance by repeatedly distributing the washing.
  - Not a fault – foam detection system active - a rinse cycle is started.
- Detergent residue on the washing.
  - Occasionally phosphate-free detergents contain water-insoluble residue.
  - Select **Rinse/Freshen up** 🧺 or brush the laundry after washing.
- If a fault cannot be rectified or a repair is required:
  - Set programme selector to **Off** and pull out the mains plug.
  - Turn off the tap and call customer service → *Installation instructions*.

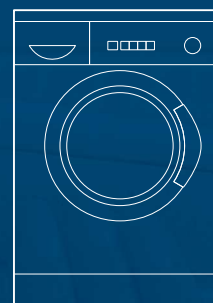

Washing machine

en

Operating instructions



**BOSCH**



Read these instructions before switching on the washing machine!  
Also follow the separate installation instructions.  
Follow the safety instructions on page 8!