

## EXTERNAL ROOF SOLUTION

765, 1140 & 2010m<sup>3</sup>/h

1. Fan power supply connects to internal hood unit
2. Tile or metal roof flashing (optional accessory)
3. Rigid duct mount (optional accessory)
4. 200mm flexi ducting (attached to internal hood unit)\*

*\*Advise to include gentle bend in duct run as well ensuring ducting is pulled tight and excess removed.*

**We recommend to install the roof motor offset from rangehood to avoid direct noise travel.**

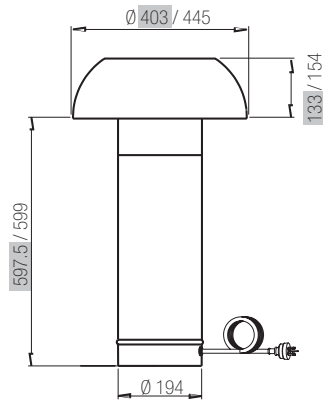

ER-765/1140 Dimensions  
ER-2010 Dimensions

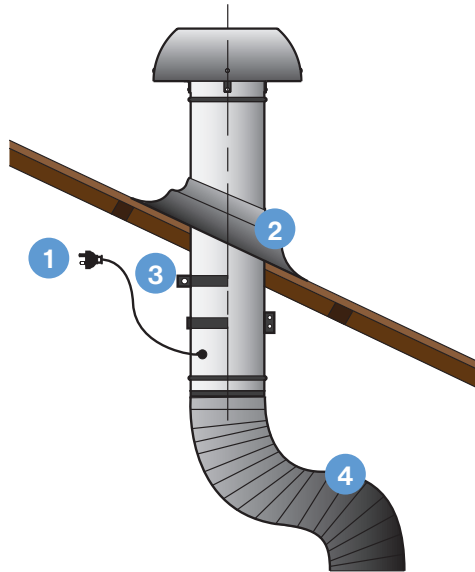

## EXTERNAL WALL SOLUTION

765, 1140 & 2010m<sup>3</sup>/h

1. Fan power supply (connects to internal hood unit)
2. 200mm flexi ducting (attached to internal hood unit)\*

*\*Advise to include gentle bend in duct run as well ensuring ducting is pulled tight and excess removed.*

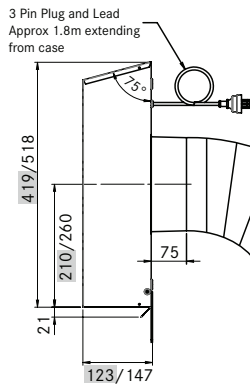

EW-765/1140 Dimensions  
EW-2010 Dimensions

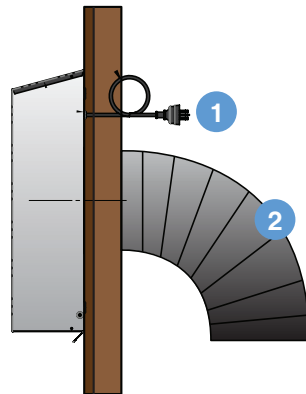

## IN-ROOF MOTOR SOLUTION

765 & 1140m<sup>3</sup>/h

1. Fan power supply (attached to internal hood unit)
2. 200mm flexi duct installed between rangehood and motor inlet\*
3. 200mm flexi duct installed between motor outlet and wall/eave vent
4. Vent installed in eave position

1. Fan power supply (attached to internal hood unit)
2. 200mm flexi duct installed between rangehood and motor inlet\*
3. 200mm flexi duct installed between motor outlet and wall/eave vent
4. Vent installed in wall position

*\*Advise to include gentle bend in duct run as well ensuring ducting is pulled tight and excess removed.*

