

GOLDAIR™

2400W Glass Panel Heater OPERATING INSTRUCTIONS



For Models: GGPH224B, GGPH224W

General Care and Safety Guide

Thank you for choosing a Goldair Panel Heater. This Goldair appliance has been designed and manufactured to high standards of engineering and with proper use and care, as described in this booklet, will give you years of useful service. Please read these instructions carefully and keep for future reference.

1. **WARNING** you must not cover this appliance. Covering this appliance presents fire risk and will activate the safety fuse; permanently disabling the unit.
2. Use only the voltage specified on the rating label of the appliance.
3. Keep all objects at least 1 metre from the front, sides and rear of the appliance.
4. This appliance is intended for household use only and not for commercial or industrial use.
5. Indoor use only.
6. Do not use abrasive cleaning products on this appliance. Clean with a damp cloth (not wet) rinsed in hot soapy water only. Always remove plug from the mains supply before cleaning.
7. The common cause of overheating is deposits of dust or fluff in the appliance. Ensure these deposits are removed regularly by unplugging the appliance and vacuum cleaning the air vents and grills.
8. Always unplug appliance when not in use.
9. When the appliance has been unpacked, check it for transport damage and ensure all parts have been delivered. If parts are missing or the appliance has been damaged, contact the Goldair Customer Services Team.
10. If your appliance does not work, or is not working properly, contact the place of purchase or the Goldair Customer Services Team.
11. Do not connect the appliance to mains supply until completely assembled and adjusted.
12. Ensure hands are dry before handling the plug or main unit.
13. Do not locate the appliance directly below any power socket outlet.
14. Ensure appliance is on a flat, stable, heat-resistant surface.
15. Do not operate with cord set coiled up as a heat build up is likely, which could be sufficient to become a hazard.
16. Carry out regular checks of the supply cord to ensure no damage is evident.
17. Do not operate this appliance with a damaged cord, plug or after the appliance malfunctions or has been dropped or damaged in any manner. Return to a qualified electrical person for examination, electrical service or repair.
18. Do not remove plug from power socket by pulling cord; always grip plug.
19. Do not twist, kink or wrap the cord around the appliance, as this may cause the insulation to weaken and split. Always ensure that all cord has been removed from any cord storage area and is unrolled before use.
20. It is recommended that this appliance is plugged directly into the wall socket. The use of power boards is not recommended as many power boards are not designed to supply power to high wattage appliances.
21. A correctly specified, undamaged extension cord may be used with this appliance provided it is used in a safe manner.
22. Use this appliance only as described in this manual. Any other use is not recommended by the manufacturer and may cause fire, electric shock or injury.
23. Do not remove plug from power socket until the appliance has been switched off.
24. Do not remove plug from power socket by pulling cord; Do not place cord under carpet or cover with rugs or furniture. Arrange the cord so it cannot be tripped over.
25. Do not place appliance on bedding or on thick & long carpet where the openings may get blocked.
26. Switch off and allow to cool before moving.
27. Do not place appliance close to radiant heat source.
28. Never use the appliance to dry clothes.
29. Do not insert or allow foreign objects to enter any ventilation or exhaust opening, as this may cause an electric shock, fire or damage to the appliance.
30. Do not sit on the appliance.
31. Do not operate in areas where petrol, paint or other flammable liquids are used or stored.
32. This appliance is not intended for use by persons (including children) with reduced physical, sensory or mental capabilities or lack of experience and knowledge, unless they are supervised or have been given instruction concerning the use of the appliance by a person responsible for their safety.
33. Children should be supervised to ensure that they do not play with the appliance.
34. Do not use this appliance in the immediate surrounds of a bath, a shower, or a swimming pool or other liquids. The appliance must not be immersed in any liquids.
35. There are no user serviceable parts installed in the unit.
36. Do not place the unit in wardrobes or other enclosed spaces as this may cause fire hazards.
37. This unit is not supposed to be used in or around locations where foodstuffs, works of art or delicate articles of science, etc are stored.

YOUR SAFETY IS IMPORTANT TO US. PLEASE ENSURE YOU TAKE NOTE OF THE INSTRUCTIONS AND WARNINGS OUTLINED IN THIS MANUAL.

Components

HEAT OUTLET

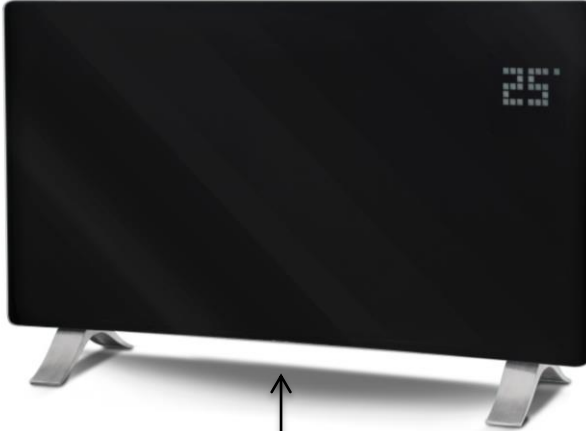

← CONTROL PANEL

← (BACK)
MAIN POWER
SWITCH

AIR INLET



FEET x 2

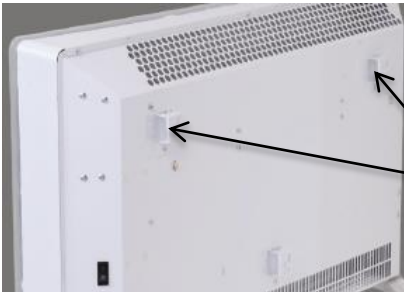

WALL MOUNTING
BRACKETS



REMOTE CONTROL

SCREW PACK
6 x SCREWS including 2 x
ONE WAY SCREWS TO
ATTACH FEET

WALL MOUNTING
2 x LONG SCREWS
2 x WALL PLUGS

Assembly and Installation

Before using this appliance, it must either be wall mounted or have the feet fitted. The screw pack to attach the feet to your appliance will be taped to either one of the feet for your appliance, or taped to the plug.

FREE STANDING

1. Ensure the appliance is unplugged and power switches are off.
2. Carefully turn the Main Body upside-down on a scratch-free and stable surface. Be careful to prevent damage to the cosmetic finish or your floor surfacing.
3. Align the screw hole on the Feet Bracket with the screw hole on the base of the appliance.
4. Attach feet with the screws provided and ensure the bracket sits firmly in place (do not over tighten).
5. Set appliance upright and plug into a standard 240 volt AC electrical outlet.

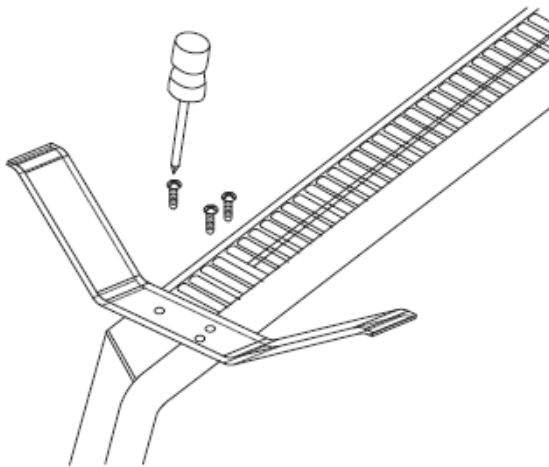

Assembly and Installation

Before using this appliance, it must either be wall mounted or have the feet fitted. The screw pack to attach the feet to your appliance will be taped to either one of the feet for your appliance, or taped to the plug.

WALL MOUNTED

1. Make sure the appliance is unplugged and power switches are off.
2. Position the panel appliance within one metre of a wall socket. Do not mount in front of or below the wall socket. Ensure there is at least 100mm clearance on all sides of the appliance.
3. Position the mounting screws on the wall per below mounting guide and check they are horizontal with a spirit level. Ensure the bottom of the heater is at least 100mm from the floor and drill holes as required.
4. Slot the back of the appliance onto the mounting screws. The bottom mount is on there to keep the heater at the correct distance from the wall. You do not need to put a screw in the bottom mount.
5. Plug appliance into a standard 240 volt AC electrical outlet.

Mounting Guide

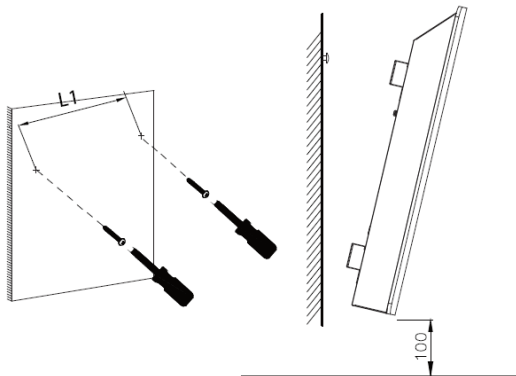
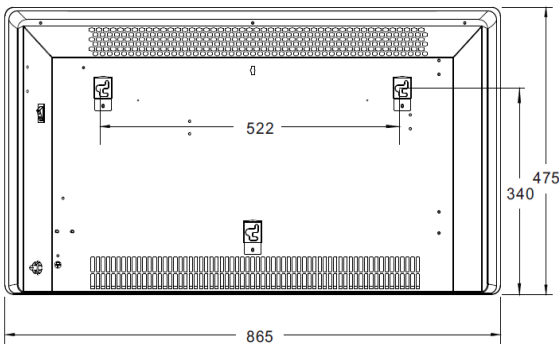

Wall mounted mode

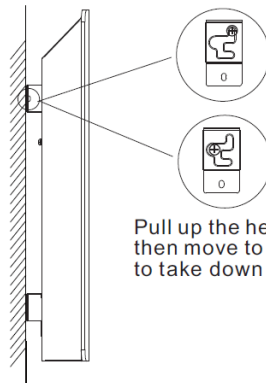
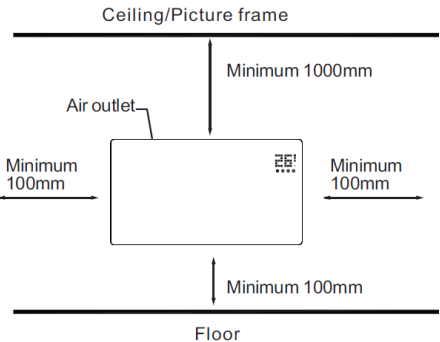

Pull up the heater 5mm, then move to left 10mm to take down the heater.

Take down the heater from wall

Operating your Appliance

Always choose a safe location for the appliance, keeping in mind the safety precautions outlined. Ensure all packaging has been removed from the unit before use.

WARNING: Keep all objects at least 1000mm from the front and 100mm from the sides of the appliance.

WARNING: In order to avoid overheating or risk of fire, do not cover the heater.

WARNING: Never leave this appliance unattended when in use.

WARNING: Do not use this appliance with a programmer, remote-control system, separate timer or any other device that switches the appliance on automatically.

Note: When the appliance is turned on for the first time, it may release a slight odour or smoke. This odour or smoke is a normal occurrence caused by the initial heating of the internal heating elements and should not occur again.

CONTROL PANEL

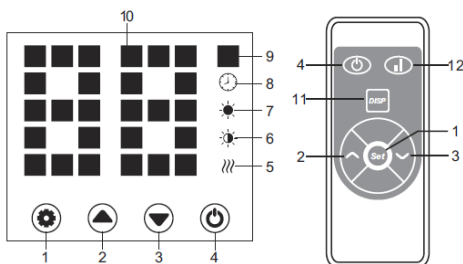

- 1 – Setting Button
- 2 – Up Button
- 3 – Down Button
- 4 – Power Button
- 5 – Heating Element Indicator
- 6 – Low Heating Indicator
- 7 – High Heating Indicator
- 8 – Timer Indicator
- 9 – Temperature Indicator
- 10 – LED Number Display
- 11 – LED Screen On-Off Button
- 12 – Low/High Heating Selection

Ensure the power switch is in the OFF position before plugging unit in.

Do not use this heater until it is fully assembled according to the free standing or wall mounting instructions within this manual.

OPERATION

Plug in the unit and switch on the main power switch. The power indicator will light up.

Press the Power button (4) to turn the unit on. The current room temperature will be displayed.

SETTING THE TEMPERATURE

Press the Setting button (1) to set the temperature. The Temperature Indicator (9) and LED Number Display (10) will flash. Press the Up (2) or Down (3) Arrow buttons to increase or decrease the temperature. The maximum setting is 45C, while the minimum is 5C. If no buttons are pressed for 3 seconds, the heater will run to the previously set temperature.

POWER LEVEL SELECTION

Pressing the Up button (2) or the Low/High Heating Selection (12) on the remote, will select the power output. When the High Heating Indicator (7) is lit, the heater will work at full power. Press the Down button (3) or Low/High Heating Selection (12) on the remote to change to half power and the Low Heating Indicator (6) will light up.

SETTING THE TIMER

Press the Setting button (1) twice to set timer. The set time is displayed while the timer indicator (8) is flashing. Press the Up (2) or Down (3) arrows to increase or decrease the timer in one hour increments. The timer has a range of 0-24 hours. The unit will turn off once the timer completes its countdown.

Operating your Appliance

Always choose a safe location for the appliance, keeping in mind the safety precautions outlined. Ensure all packaging has been removed from the unit before use.

CHILD SAFETY LOCK

Press and hold the Up (2) and Down (3) Arrow buttons on the LED Display together for 3 seconds to lock the system. A [] will be displayed.

To unlock, either turn the unit off or press and hold the Up (2) and Down (3) Arrow buttons together for 3 seconds.

DISP MODE

Press and hold the Setting button (1) and the Down button (3) together for 3 seconds on LED display or the LED Screen On/Off button (11) on the remote control to turn off the control panel lights. Only the current Heating Indicator (6 or 7), and the Heating Element Indicator (5) will remain lit. Touch the button location on the LED display or the LED Screen On/Off button on the remote to turn on LED display again.

TURN OFF

Press and hold the Power button (4) to turn off the unit. The power indicator light will remain lit while the main power switch is in the On position.

Care and Cleaning

CLEANING YOUR APPLIANCE

The appliance requires regular cleaning to ensure trouble free operation:

Unplug the appliance from the mains supply before cleaning.

Ensure that the appliance has been allowed to cool down completely before cleaning.

Use a damp (not wet) cloth to wipe the exterior of the appliance to remove dust and dirt.

Never use solutions such as benzene, thinners or polishing agents.

Use a vacuum cleaner to remove dust and fluff from the inlet and outlet grills.

To clean behind the appliance (when mounted on a wall); remove unit from wall per instructions within this booklet.

It is important to return the appliance to its original position after cleaning and to remount on wall per instructions within this booklet.

Ensure the appliance is dry before plugging back into the mains supply.

Do not attempt to dismantle the appliance. There are no user serviceable parts. For service or repair, contact an authorised electrical service technician.

PROOF OF PURCHASE

To receive warranty retain receipt as proof of purchase.

SAFETY DEVICES

This appliance has two protection devices:

1. Tilt switch - this will automatically turn the appliance off if the appliance is not in the appropriate operating position.
2. Thermal fuse - this disconnects the appliance permanently in case of overheating. (It is non resettable).

CAUTION: The appliance generates heat during use. Proper precautions must be taken to prevent the risk of burns, scalds, fires or other damage to persons.

TECHNICAL SPECIFICATION

Model No: GGPH224B, GGPH224W
Supply: 220-240VAC 50-60Hz
Wattage: 2000-2400W

GOLDAIR

SUPPORT AND TECHNICAL ADVICE

Goldair – New Zealand
Monday – Friday 8am-5pm
Phone +64 (0)9 917 4000
Phone 0800 232 633
info@cdb.co.nz

Goldair – Australia
Monday – Friday 8am-5pm
Phone +61 (0)3 9365 5100
Phone 1300 465 324
info@cdbgoldair.com.au

Two Year Warranty

Thank you for purchasing this Goldair product. Your product is warranted against faults and manufacture when used in normal domestic use for a period of **two years**. In non-domestic use Goldair limits the voluntary warranty to **three months**.

Goldair undertake to repair or replace this product at no charge if found to be defective due to a manufacturing fault during the warranty period.

This warranty excludes damage caused by misuse, neglect, shipping accident, incorrect installation, or work carried out by anyone other than a qualified electrical service technician.

PLEASE KEEP YOUR RECEIPT AS THIS WILL HELP VERIFY YOUR WARRANTY.

The benefits given to you by this warranty are in addition to other rights and remedies available to you under law in relation to the goods or services to which this warranty relates.

In Australia, our goods come with guarantees that cannot be excluded under the Australian Consumer Law. You are entitled to a replacement or refund for a major failure and compensation for any other reasonably foreseeable loss or damage. You are also entitled to have the goods repaired or replaced if the goods fail to be of acceptable quality and the failure does not amount to a major failure.

In New Zealand this warranty is additional to the conditions and guarantees of the Consumers Guarantee Act (1993).

Goldair – New Zealand

CDB Goldair
PO Box 100-707
N.S.M.C
Auckland

Phone +64 (0)9 917 4000
Phone 0800 232 633
www.goldair.co.nz

Goldair – Australia

CDB Goldair Australia Pty
PO Box 574
South Morang
Victoria, 3752

Phone +61 (0)3 9365 5100
Phone 1300 GOLDAIR (1300 465 324)
www.goldair.com.au

Goldair Two Year Warranty (IMPORTANT: Please complete and retain this warranty card)

Name

Address

Place Of Purchase

Date Of Purchase

Name Of Product

Model Number

Attach a copy of the purchase receipt to this warranty card

GOLDAIR™

CDB  GOLDAIR

New Zealand
PO Box 100-707,
North Shore Mail Centre,
Auckland, 0745
www.goldair.co.nz

Australia
PO Box 574,
South Morang,
Victoria, 3752
www.goldair.com.au