

The word "dreame" is the abbreviation of Dreame Technology Co., Ltd. and its subsidiaries in China. It is the transliteration of the company's Chinese name " 追觅 ", which means striving for excellence in every endeavor and reflects the company's vision of continuous pursuit, exploration and search in technology.



For more support, contact us via <https://global.dreameotech.com>
Manufactured by: Dreame Trading (Tianjin) Co., Ltd.
Made in China



RLL42SD-EU-A00
10/2023

DreameBot L10s Plus

Auto-Empty Robot Vacuum and Mop User Manual

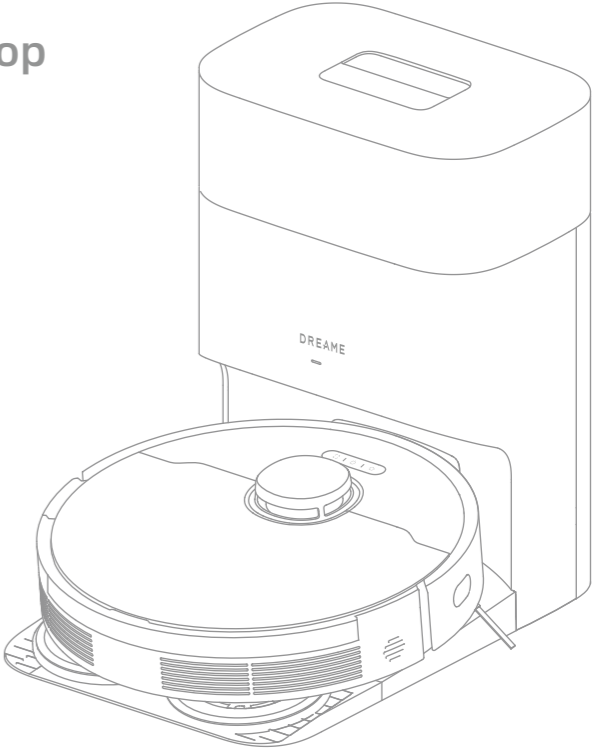

The illustrations in this manual are for reference only. Please refer to the actual product.

DREAME

Contents

EN	User Manual
DE	Benutzerhandbuch
FR	Manuel d'utilisation
IT	Manuale utente
ES	Manual de usuario
RU	Руководство пользователя
PL	Instrukcja obsługi
HE	מדריך למשתמש
AR	دليل المستخدم

Safety Information

To avoid electric shock, fire or injury caused by improper use of the appliance, please read the user manual carefully before using the appliance and keep it for future reference.

Usage Restrictions

- This product should not be used by children younger than 8 years old nor persons with physical, sensory, intellectual deficiencies, or limited experience or knowledge without the supervision of a parent or guardian to ensure safe operation and to avoid any risks. Cleaning and maintenance shall not be performed by children without supervision.
- This appliance contains batteries that are only replaceable by skilled persons.
- Clear the area to be cleaned. Children shall not play with the appliance. Ensure children and pets are kept at a safe distance from the robot while it is operating.
- Do not install, charge or use the appliance in the bathrooms or around the pools.
- This product is for floor cleaning in a home environment only. Do not use it outdoors, on non-floor surfaces, or in a commercial or industrial setting.
- If the power cord is damaged, it must be replaced by a special cord or assembly available from the manufacturer or its service agent.
- Do not use the robot in an area suspended above ground level without a protective barrier.
- Do not place the robot upside down. Do not use the LDS cover, robot cover, or bumper as a handle for the robot.
- Do not use the robot at an ambient temperature above 40°C or below 0°C or on a floor with liquids or sticky substances.

Usage Restrictions

- To prevent damage or harm from dragging, clear any loose objects from the floor, and remove cables or power cords on the cleaning path before operating the appliance.
- Remove fragile or small items from the floor to prevent the robot from bumping into and damaging them.
- Keep hair, fingers, and other body parts away from the suction opening of the robots.
- Do not operate the appliance in a room where an infant or child is sleeping.
- Do not place children, pets, or any item on top of the robot regardless of whether it is stationary or moving.
- Do not use the robot to clean any burning objects. Do not use the robot to pick up flammable or combustible liquids, corrosive gases, or undiluted acids or solvents.
- Do not vacuum hard or sharp objects. Do not use the appliance to pick up objects such as stones, large pieces of paper or any item that may clog the appliance.
- Plug must be removed from the socket-outlet before cleaning or maintaining the appliance.
- Do not wipe the robot or the base station with a wet cloth or rinse them with any liquid. After cleaning washable parts, fully dry the parts before reinstalling and using them.
- Please use this product in accordance with the instructions in the User Manual. Users are responsible for any loss or damage that arise from improper use of this product.

Batteries and Charging

- Do not use any third-party battery or base station with auto-empty. Use only with RCLD1 supply unit.
- Do not attempt to disassemble, repair, or modify the battery or the base station with auto-empty on your own.
- Do not place the base station with auto-empty near a heat source.
- Do not use a wet cloth or wet hands to wipe or clean the charging contacts of the base station with auto-empty.
- Do not improperly dispose of old batteries. Unneeded batteries should be discarded at an appropriate recycling facility.
- If the power cord becomes damaged or broken, stop using it immediately and contact after-sales service.
- Make sure the robot is turned off when being transported and kept in its original packaging if possible.
- If the robot will not be used for an extended period, fully charge it, then turn it off and store it in a cool, dry place. Recharge the robot at least once every 3 months to avoid over-discharging the battery.

Laser Safety Information

- The laser sensor in this product meets the IEC 60825-1:2014/EN 60825-1:2014/A11:2021 Standard for Class 1 laser products. Please avoid direct eye contact with it during use.

CLASS 1 LASER PRODUCT
CONSUMER LASER PRODUCT
EN 50689:2021

Hereby, Dreame Trading (Tianjin) Co., Ltd. declares that the radio equipment type RCLD1 is in compliance with Directive 2014/53/EU. The full text of the EU declaration of conformity is available at the following internet address: <https://global.dreametech.com>
For detailed e-manual, please go to <https://global.dreametech.com/pages/user-manuals-and-faqs>

Product Overview

Package Contents

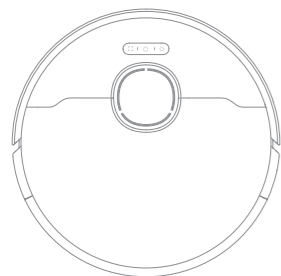

Robot

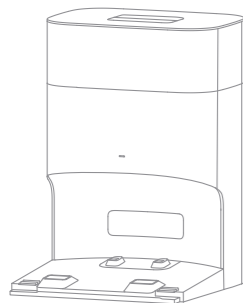

Base Station with
Auto-Empty

Other Accessories



Side Brush

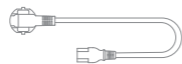

Power Cord



Base Station Ramp
Extension Plate
(install before use)



Mop Pad Holder ×2

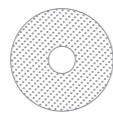

Mop Pad ×2
(pre-installed)



Dust Bag ×2
(pre-installed ×1)



User Manual

Product Overview

Robot

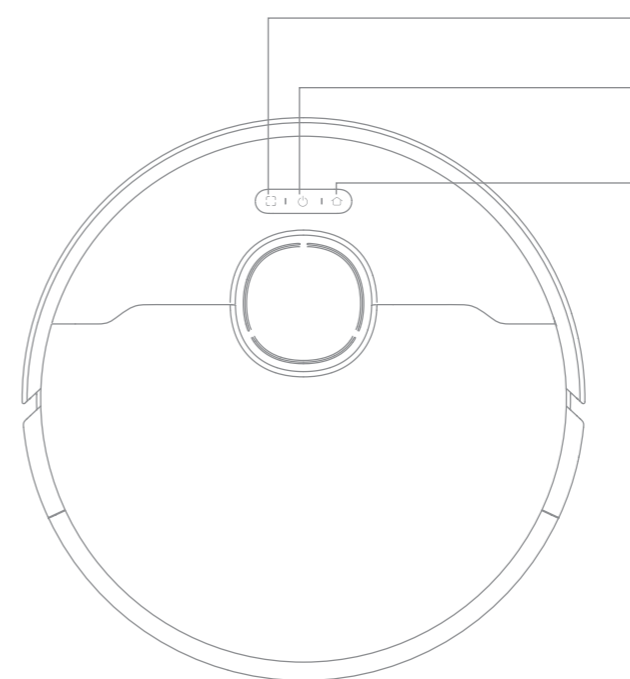

- **Spot Cleaning Button**
· Press to start spot cleaning
- **Power / Clean Button**
· Press and hold for 3 seconds to turn on or off
· Press to start cleaning after the robot is turned on
- **Dock Button**
· Press to send the robot back to the base station
· Press and hold for 3 seconds to disable Child Lock

- Status Indicator**
- Solid White: Cleaning or cleanup completed
 - Blinking Orange: Error

- Note:**
- Press any button on the robot to pause while the robot is cleaning or returning to charge.
 - Child Lock can be enabled/disabled through the Dreamehome app.

Product Overview

Robot and Sensors

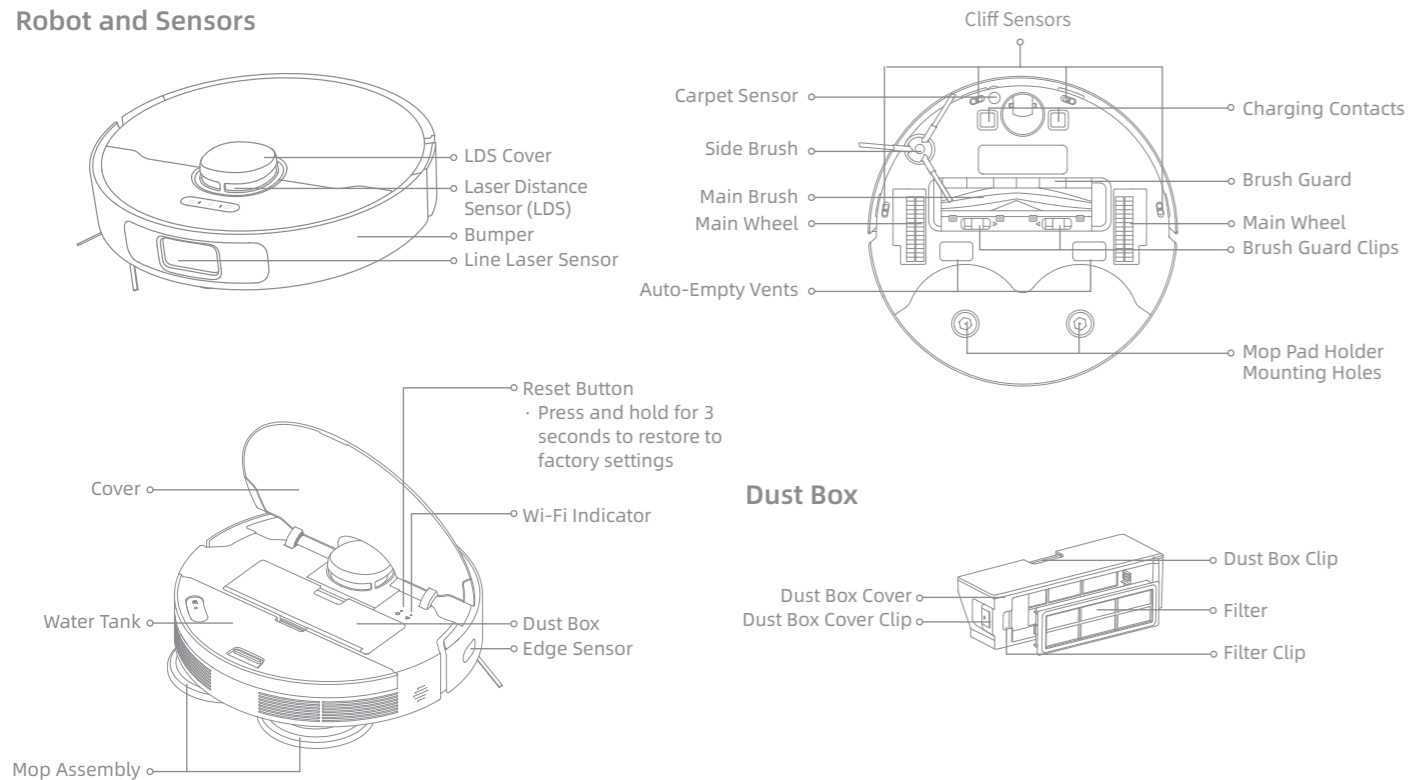

Product Overview

Mopping Module

Water Tank

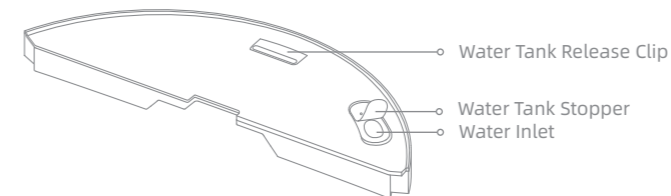

Mop Assembly

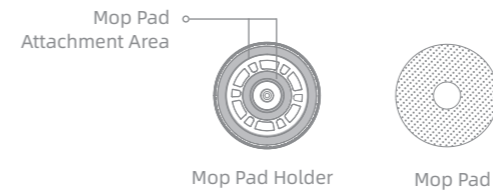

Product Overview

Base Station with Auto-Empty

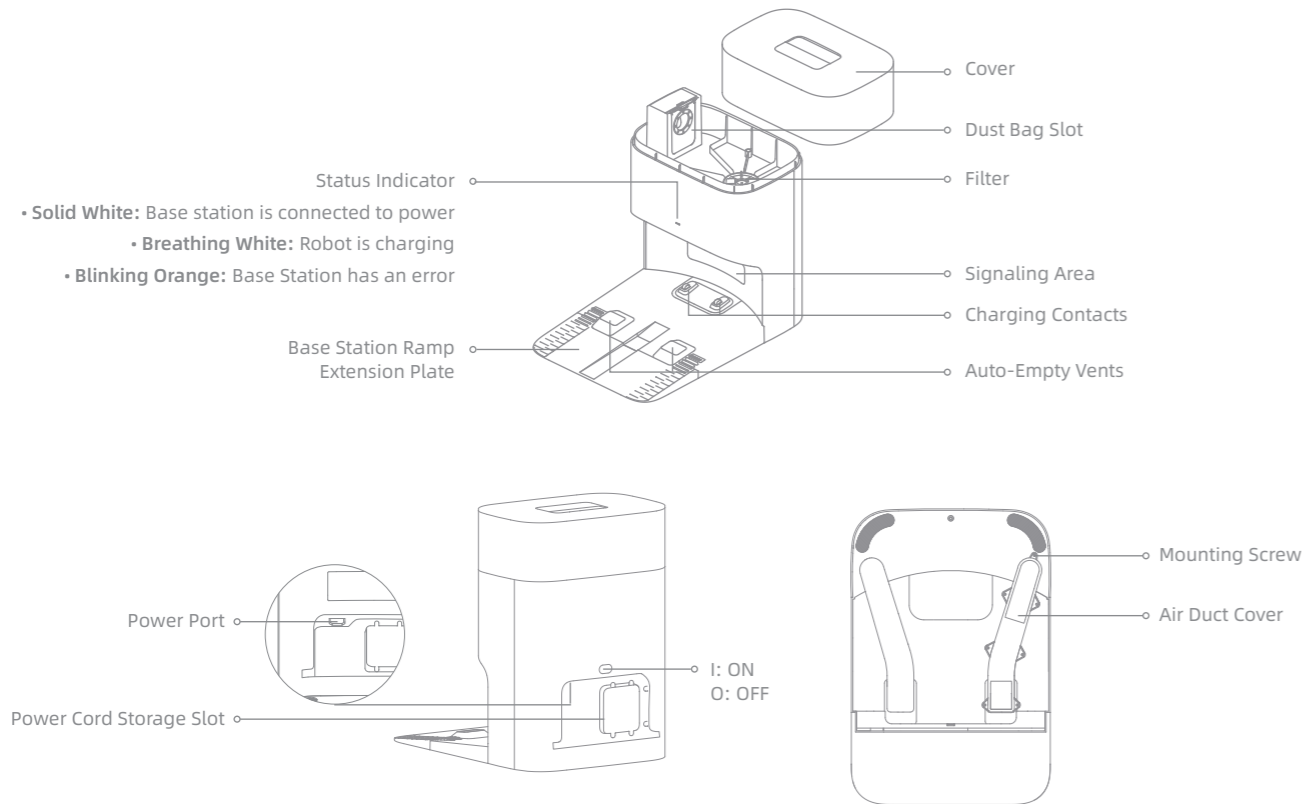

Preparing Your Home



Before cleaning, please move away unstable, fragile, valuable or dangerous items, and clean up cables, cloths, toys, hard objects and sharp objects on the ground to avoid being entangled, scratched or knocked over by the robot and causing losses.

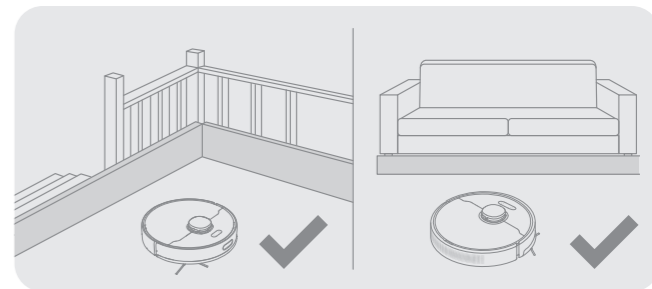

Before cleaning, place a physical barrier at the edge of the stairs and sofa to ensure the secure and smooth operations of the robot.

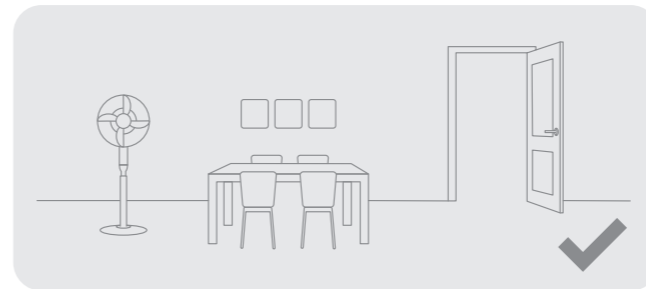

Open the door of the room to be cleaned, and put the furniture in its proper place to leave more space.

Note:

- When operating the robot for the first time, follow it around while cleaning to remove any potential obstacles in time.
- Do not vacuum hard objects like stones, steel balls and toy parts, or sharp objects like construction waste, broken glass and nails, otherwise the ground may be scratched.

Before Use

1. Place the Base Station and Connect to an Electrical Outlet

Place the base station on level ground against the wall. Insert the power cord into the base station and plug it into the socket.

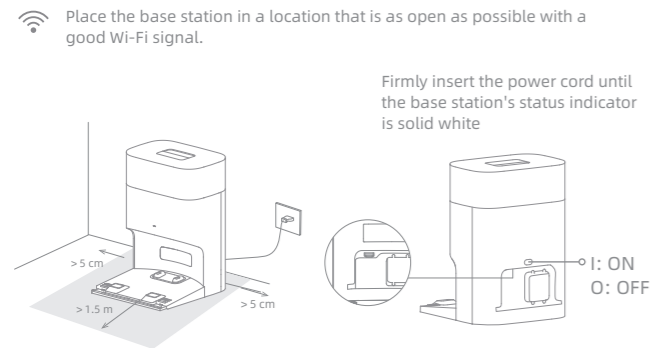

Note:

- Make sure that no objects might block the signaling area.
- Remove any objects that are closer than 1.5 m from the front and 5 cm from either side of the base station.

2. Install the Base Station Ramp Extension Plate

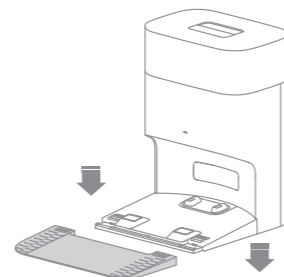

3. Remove the Protections

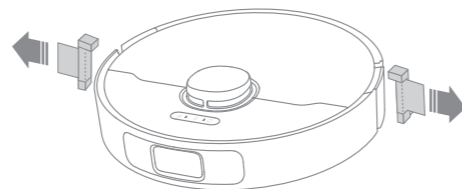

Before Use

4. Install the Side Brush and the Mopping Assembly

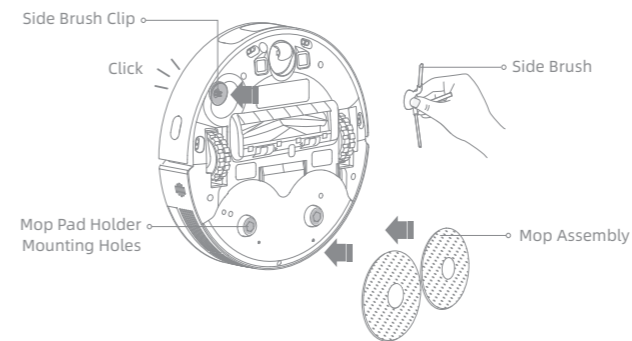

Note: Install the side brush until it clicks into place.

5. Charge the Robot

When placing the robot, align the charging contacts at the bottom of the robot with the charging contacts of the base station, and the robot will automatically turn on and start charging.

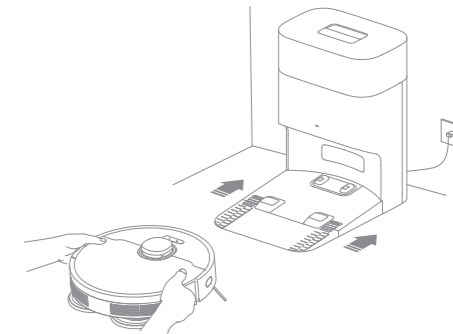

Note: It is recommended to fully charge your robot before first time use.

Connecting with Dreamehome App

1. Download Dreamehome App

Scan the QR code on the robot, or search "Dreamehome" in the app store to download and install the app.

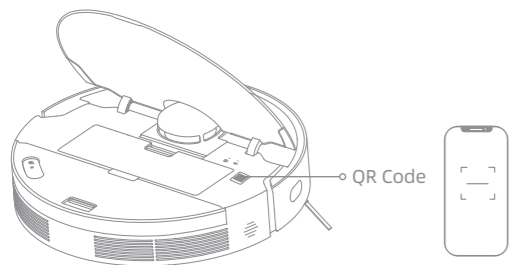

Note:

- Only 2.4GHz Wi-Fi is supported.
- Due to upgrades in the app software, the actual operations may differ from the directions in this manual. Please follow the instructions based on the current app version.

2. Add Device

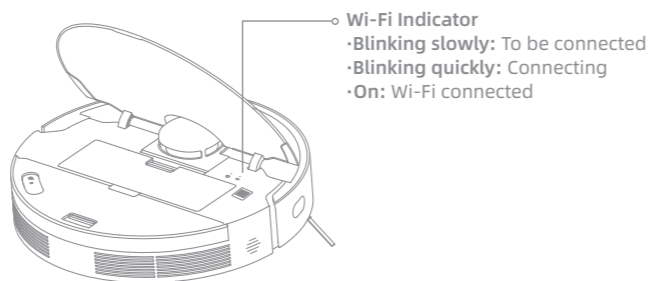

Open the Dreamehome app, tap  in the upper right corner, and scan the same QR code on the robot again to add the device. Please follow the prompts to finish the Wi-Fi connection.

Note: If you want to reset Wi-Fi, repeat step 2 and then follow the prompts to finish the Wi-Fi connection.



How to Use

Turn On/Off

Press and hold the button  for 3 seconds to turn on the robot. The power indicator should be illuminated. Place the robot onto the base station, the robot should turn on automatically and begin charging. To turn off the robot, move the robot away from the base station and press and hold the button  for 3 seconds.

Fast Mapping

After configuring the network for the first time, follow the instructions in the app to quickly create a map. The robot will start mapping without cleaning. When the robot returns to the base station, the mapping process has been completed and the map will be saved automatically.

Start Cleaning

Press the button  to start cleaning after the robot is turned on. The robot will accurately map out a route, methodically clean along the edges and walls, then finish by cleaning each room in an S-shaped pattern to ensure a thorough job.

Note:

- It is recommended that the robot set out from the base station before cleaning. Do not move the base station while the robot is cleaning. This ensures that the robot returns to base station smoothly.
- After the robot completes the cleaning task and automatically returns to the base station, the base station will start auto-empty. More settings can be operated on the app.

Pause/Sleep

When the robot is running, press any button to pause it. If the robot is paused for more than 10 minutes, it automatically enters sleep mode. All indicators on the robot will turn off. Press any button on the robot or base station, or use the app to wake up the robot.

Note: If the robot is paused and placed onto the base station, the current cleaning process will end.

Auto Resume Cleaning

If the battery is too low, the robot will automatically return to the base station to charge. After charging to the appropriate battery level, it will resume unfinished cleaning tasks.

Note: To use this function, please open it in the App.

Do Not Disturb (DND) Mode

When the robot is set to Do Not Disturb (DND) mode, the robot will be prevented from resuming cleaning and the power indicator will turn off. DND mode is disabled by default at the factory. You can use the app to enable DND mode or modify the DND period. The DND period is 22:00-8:00 by default.

Note:



- The scheduled cleaning tasks will be performed as usual during the DND period.
- The robot will resume cleanup where it left off after the DND period expires.

How to Use

Spot Cleaning

When the robot is on standby, press the button  to enable the spot cleaning mode. In this mode, the robot cleans a square-shaped area of 1.5 × 1.5 meters around it and returns to its starting point once the spot cleaning is completed.

Robot Restarting

If the robot stops responding or cannot be turned off, press and hold the button  for 10 seconds to forcefully turn it off. Then, press and hold the button  for 3 seconds to turn the robot on.

Use Mopping Function

It is recommended that all floors are vacuumed at least three times before the first mopping session to achieve a better cleaning effect.

1. Dampen the mop pads and wring out excess water. Install and attach the mop pads onto the mop pad holder in place. Lastly, install the mop assembly onto the bottom of the robot.

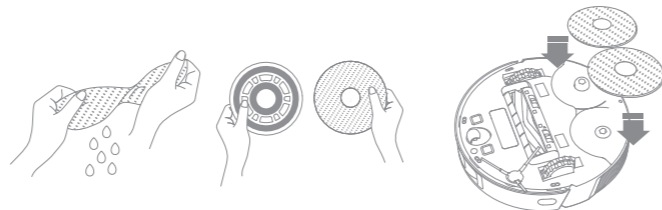

2. Open the cover of the robot and take the water tank out. Fill the water tank with clean water and then reinstall it.

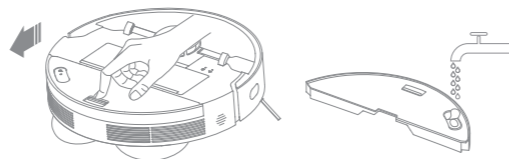

Note:

- Do not use detergent or disinfectant.
- Do not fill the water tank with hot water as this may cause the water tank to warp.

How to Use

3. Press the button  or use Dreamehome app to start cleaning.

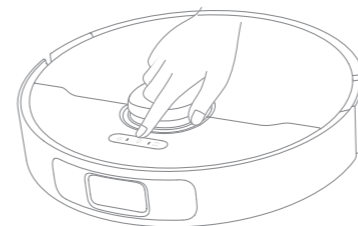

Note:

- It is not recommended to use the mopping function on carpets.
- Use the app to adjust the water flow as required.

4. When the robot finishes a cleaning task and returns to the base station, remove the mop assembly and wash the mop pads in time.

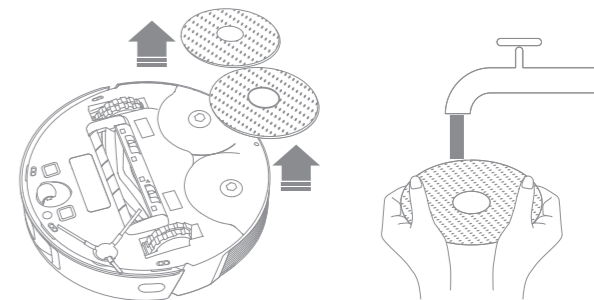

Note: When the robot is charging or not in use, remove the mopping module, pour out all the remaining water in the water tank, and clean the mop pads to prevent mildew or odors.

Routine Maintenance

Parts

To keep the robot in good condition, it is recommended to refer to the accessory usage in the app or the following table for routine maintenance.

Part	Maintenance Frequency	Replacement Period	Part	Maintenance Frequency	Replacement Period
Mop pad	After each use	Every 1 to 3 months	Robot's charging contacts	Once every month	/
Main brush	Once every 2 weeks	Every 6 to 12 months	Robot's auto-empty vents		
Side brush		Every 3 to 6 months	Line laser sensor		
Mop pad holder		/	Edge sensor		
Dust box's filter		Every 3 to 6 months	Bumper		
Base station's signaling area	Once every month	/	Omnidirectional wheel		
Base station's charging contacts			Carpet sensor		
Base station's auto-empty vents			Cliff sensors		
Laser Distance Sensor (LDS)			Bottom of the robot		
			Dust box	Clean it as needed	
	Dust bag	/	90 days		

Note: The replacement frequency will depend on your usage of the robot. If an exception occurs due to special circumstances, the parts should be replaced.

Routine Maintenance

Mopping Moudle

1. Open the robot's cover and press the clip to remove the water tank. Pour out the water in the tank. Clean the tank with water only and leave to air dry before use.

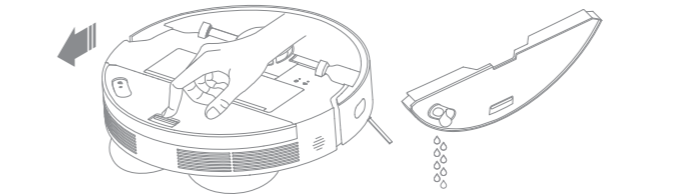

Note: Do not directly expose the water tank to sunlight.

2. Remove the mop pads from the mop pad holder. Clean the mop pads with water only and leave it to air dry before use.

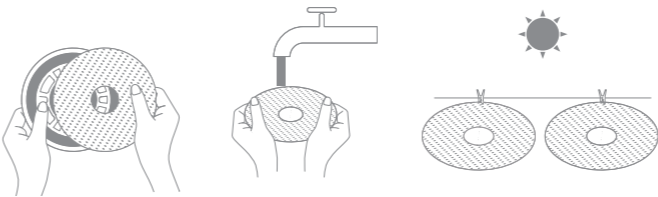

3. If slow water flow occurs, or the water volume is not well-distributed, clean the air hole in the cover of the water tank.

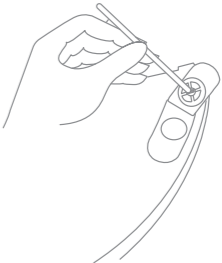

Main Brush

1. Press the brush guard clips inwards to remove the brush guard and lift the brush out of the robot.

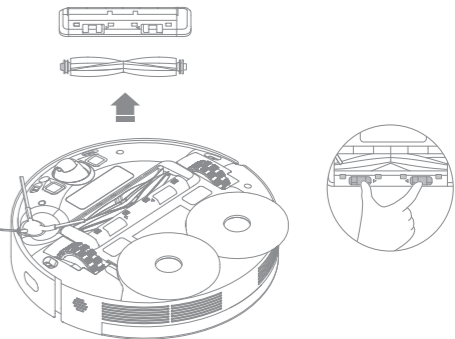

2. Pull out the brush covers at both ends of the brush as shown in the diagram. Use a proper cleaning tool to remove any hair tangled in the brush. Reinstall the brush covers on both ends of the brush, and then reinstall the brush. Press on the brush guard to lock it in place.

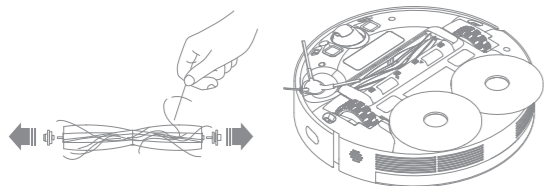

Side Brush & Mop Pad Holder

Remove and clean the side brush and mop pad holder.

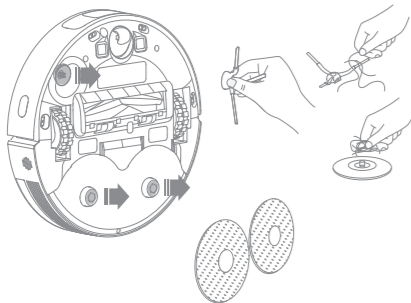

Omnidirectional Wheel

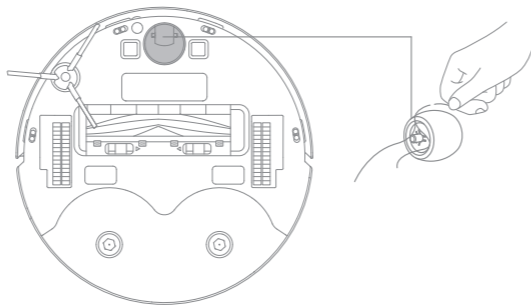

Note:

- Use a tool such as a small screwdriver to separate the axle and tire of the omnidirectional wheel. Do not use excessive force.
- Rinse the omnidirectional wheel under the running water and put it back after drying it completely.

Routine Maintenance

Dust Box

1. Open the robot's cover and press the clip to remove the dust box.

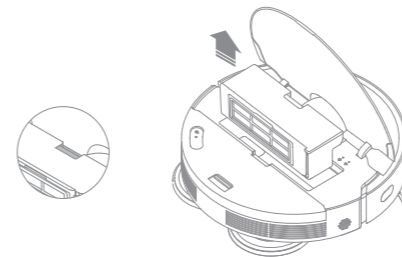

2. Open the dust box cover and empty the dust box as shown in the diagram.

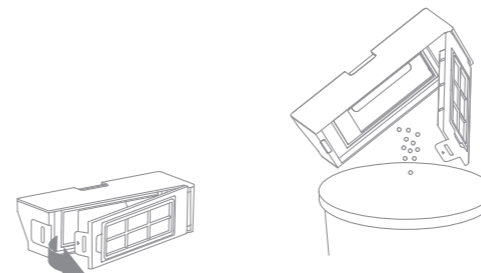

Filter

1. Remove the filter and tap its basket gently.

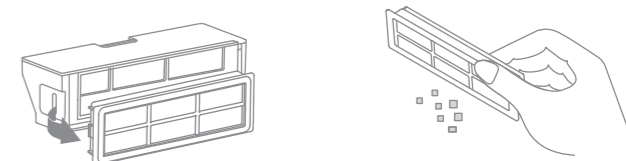

Note: Do not attempt to clean the filter with a brush, a finger or sharp objects to prevent damage.

2. Rinse the dust box and filter with water and dry them completely before reinstalling.

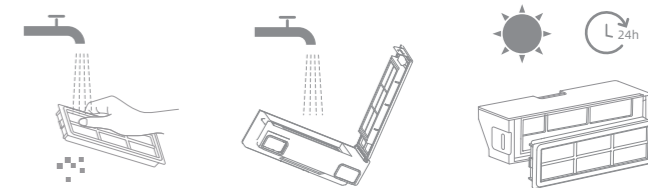

Note:

- Rinse the dust box and filter with clean water only. Do not use any detergent.
- Use the dust box and filter only when they are completely dry.

Dust Bag

1. Remove and discard the dust bag.

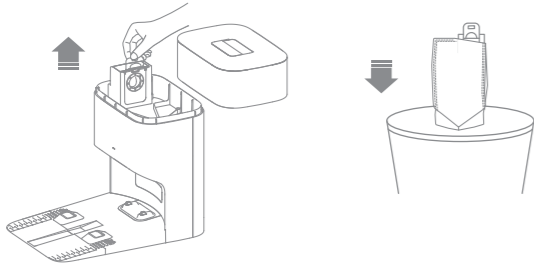

Note: Pulling outwards on the handle will seal the dust bag to prevent the dust and debris from accidentally falling out.

2. Remove the dust and debris from the filter with a dry cloth.

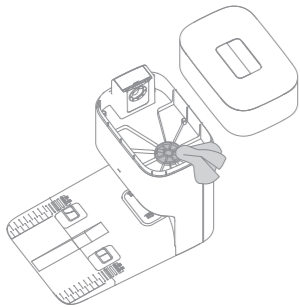

3. Install a new dust bag.

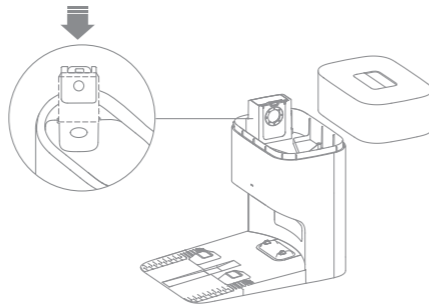

4. Put back the cover of the dust tank.



Robot Sensors and Charging Contacts

Wipe sensors and charging contacts of the robot by using a soft and dry cloth, as shown in the below figure:

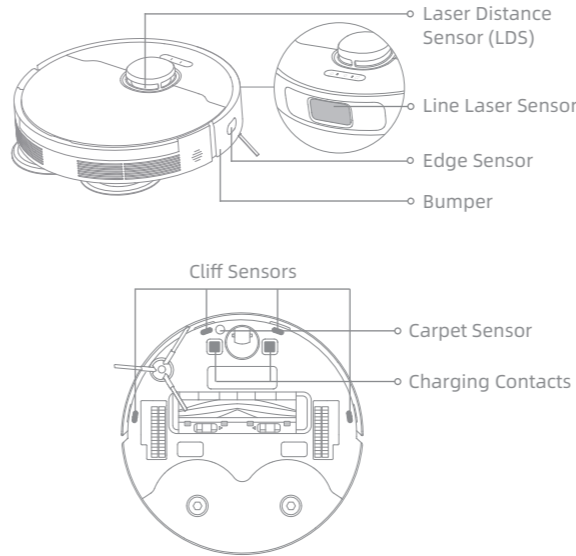

Note: A wet cloth can damage sensitive elements within the robot and the base station. Please use a dry cloth for cleaning.

Charging Contacts

Clean the charging contacts and the signaling area of the base station with a soft and dry cloth.

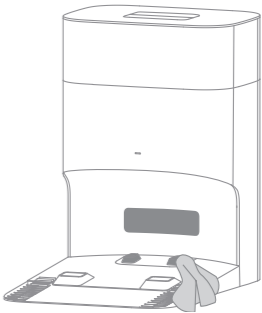

Auto-empty Vents

Clean the auto-empty vents of the robot and the base station with a soft and dry cloth.

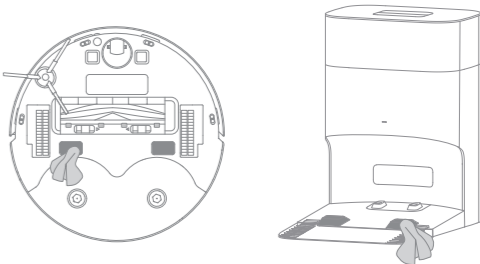

Air Duct

If the air duct is blocked, please clean it according to the following steps.

- 1. Unscrew mounting screws on the air duct cover and remove the cover.

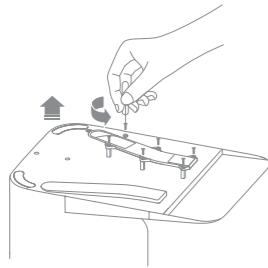

- 2. Check whether the air duct is blocked by foreign objects. If any, clean them.

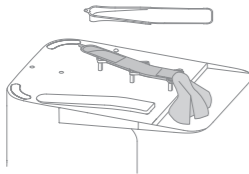

- 3. Reinstall the air duct cover.

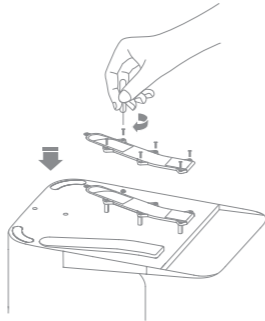



Battery

The robot contains a high-performance lithium-ion battery pack. Make sure that the battery remains well-charged for daily use to maintain optimal battery performance.

Troubleshooting

Problem	Solution
The robot will not turn on.	The battery is low. Recharge the robot on the base station and try again. The temperature of the battery is too low or too high. It is recommended to operate the appliance at a temperature between 32 °F (0° C) and 104 °F (40° C).
The robot will not charge.	The base station is not connected to power, please make sure both ends of its power cord are correctly plugged in. The contact between the charging contacts on the base station and the robot is poor, please clean the charging contacts.
The robot fails to connect to Wi-Fi.	The Wi-Fi network password is incorrect. Make sure the password used to connect to your Wi-Fi network is correct. The robot does not support a 5 GHz Wi-Fi connection. Make sure the robot is connected to a 2.4 GHz Wi-Fi connection. The Wi-Fi signal is weak. Make sure the robot is in an area with good Wi-Fi coverage. The robot may not be ready to be configured. Please exit and re-enter the app, and then try again as instructed.
The robot cannot find and return to the base station.	The base station is disconnected from power or moved when the robot is not on it. Please connect the base station to the power supply or place the robot onto the base station to charge. There are too many obstructions around the base station. Place the base station in a more open area. Moving the robot may cause it to re-position itself, and it will recreate a map if re-positioning fails. If the robot is too far from the base station, it might not be able to automatically return on its own, in which case you will need to manually place the robot onto the base station. Wipe the signaling area on the base station to remove dust or debris. The robot gets stuck in front of the base station and cannot return to it. Clear any obstruction within 5 cm on the left and right sides or within 1.5 m in front of the base station to prevent the robot from being blocked. The route for returning to charge is blocked, e.g. the door is closed. It is recommended to move the base station to a different place and try again.

Troubleshooting

Problem	Solution
The robot will not turn off.	<p>The robot cannot be turned off when it is charging. It is recommended to move the robot from the base station, and then press and hold the button  for 3 seconds to turn it off.</p> <p>If the robot cannot be turned off by performing step 1, press and hold the button  for 10 seconds to forcibly turn off the robot. If the problem persists, please contact after-sales service.</p>
The charging speed is slow.	<p>It takes about 6 hours to fully charge the robot when its battery is low.</p> <p>If you operate the robot at temperatures outside of the specified range, the charging speed will automatically slow down to extend the battery life.</p> <p>The charging contacts on both the robot and the base station may be dirty, please wipe them with a dry cloth.</p>
The noise increases while the robot is operating.	<p>Check whether the dust box's filter is clogged. If so, clean it or replace it.</p> <p>A hard object may be caught in the main brush or the dust box. Check and remove any hard object.</p> <p>The main brush or the side brush may become tangled. Check and remove any foreign objects.</p> <p>Switch the suction mode to Standard or Quiet.</p>
The robot moves without following the set route.	<p>Objects such as power cords and slippers should be organized before using the robot.</p> <p>Working on wet slippery surfaces may cause the main wheel to slip. It is recommended to dry any wet areas before using the robot.</p> <p>Wipe the line laser sensor on the robot with a clean, soft, and dry cloth to keep them clean and unobstructed.</p>
The robot misses the rooms to be cleaned.	<p>Make sure that the doors of the rooms to be cleaned are open.</p> <p>Check whether there is a threshold higher than 2 cm at the door of the robot. The robot cannot climb over high thresholds or steps.</p> <p>The place in front of the room to be cleaned may be wet and slippery, causing the robot to slip and work abnormally. Please try drying the floor before using the robot.</p>

Troubleshooting

Problem	Solution
The robot will not resume cleaning after charging.	<p>Make sure that the robot is not set to the Do Not Disturb (DND) mode, which will prevent it from resuming cleaning.</p> <p>The robot will not resume cleaning after you manually place the robot on the base station or send the robot to charge via the app or the button .</p>
The base station cannot automatically empty the dust box.	<p>Check whether the dust bag in the dust tank is full.</p> <p>If the dust bag is not full, check whether there is any obstruction at the auto-empty vents of the robot, the base station, or the dust box. If any, clean the blocked part in time.</p>
The mop pad holder is raised abnormally.	Please remove the mop pad holder to check if there is any foreign object stuck in it, and try to restart the robot. If the problem persists, please contact the after-sales service team.
No water comes out of the water tank, or only a little bit comes out.	<p>Check whether there is water inside the water tank.</p> <p>Clean the blowhole on the top of the water tank.</p> <p>Clean the mop pads if it becomes dirty.</p> <p>Make sure the mop assembly is installed correctly according to the user manual.</p>
Robot returns to the base station without performing auto-empty tasks.	DND mode prevents the robot from performing auto-empty tasks.

For more support, contact us via <https://global.dreametech.com>.

Robot

Model	RLL42SD
Charging Time	Approx. 6 hours
Rated Voltage	XX.XV
Rated Power	XX W
Operation Frequency	2400-2483.5 MHz
Maximum Output Power	< 20 dBm

Under normal use of condition, this equipment should be kept a separation distance of at least 20cm between the antenna and the body of the user.

Base Station with Auto-Empty

Model	RCLD1
Rated Input	XXX-XXX V ~ XX-XX Hz
Rated Output	XX.X V X A
Rated Power (during dust emptying)	XXX W

Battery Disposal and Removal

EN

The built-in lithium-ion battery contains substances that are hazardous to the environment. Before disposing of the battery, make sure the battery is removed by qualified technicians and discarded at an appropriate recycling facility.

- the battery must be removed from the appliance before it is scrapped;
- the appliance must be disconnected from the supply mains when removing the battery;
- the battery is to be disposed of safely.

CAUTION:

Before removing the battery, disconnect the power and run out the battery as much as possible.

Unneeded batteries should be discarded at an appropriate recycling facility.

Do not expose to high temperature environment to avoid risks of explosion.

Under abusive conditions, liquid may be ejected from the battery. If contact occurs, flush with water and seek medical help.

Removal Guide:

1. Turn over the robot, use a proper tool to remove the screws on the back of the robot, and then remove the cover.
2. Unplug the terminals between the battery and PCB board to remove the battery.

WEEE Information



All products bearing this symbol are waste electrical and electronic equipment (WEEE as in directive 2012/19/EU) which should not be mixed with unsorted household waste. Instead, you should protect human health and the environment by handing over your waste equipment to a designated collection point for the recycling of waste electrical and electronic equipment, appointed by the government or local authorities. Correct disposal and recycling will help prevent potential negative consequences to the environment and human health. Please contact the installer or local authorities for more information about the location as well as terms and conditions of such collection points.