

Instructions for use



CKWLP-E01

Whirlpool is a registered trademark of Whirlpool, USA
© Copyright Whirlpool Europe s.r.l. 2006. All rights reserved.



INSTRUCTIONS FOR USE

PRODUCT DESCRIPTION

BEFORE USING THE APPLIANCE

SAFEGUARDING THE ENVIRONMENT

PRECAUTIONS AND GENERAL RECOMMENDATIONS

INSTALLATION

CHANGING THE REVERSIBLE DOOR

HOW TO OPERATE THE REFRIGERATOR COMPARTMENT

HOW TO OPERATE THE LOW TEMPERATURE COMPARTMENT

HOW TO DEFROST AND CLEAN THE REFRIGERATOR

CARE AND MAINTENANCE

TROUBLESHOOTING GUIDE

AFTER-SALES SERVICE



PRODUCT DESCRIPTION

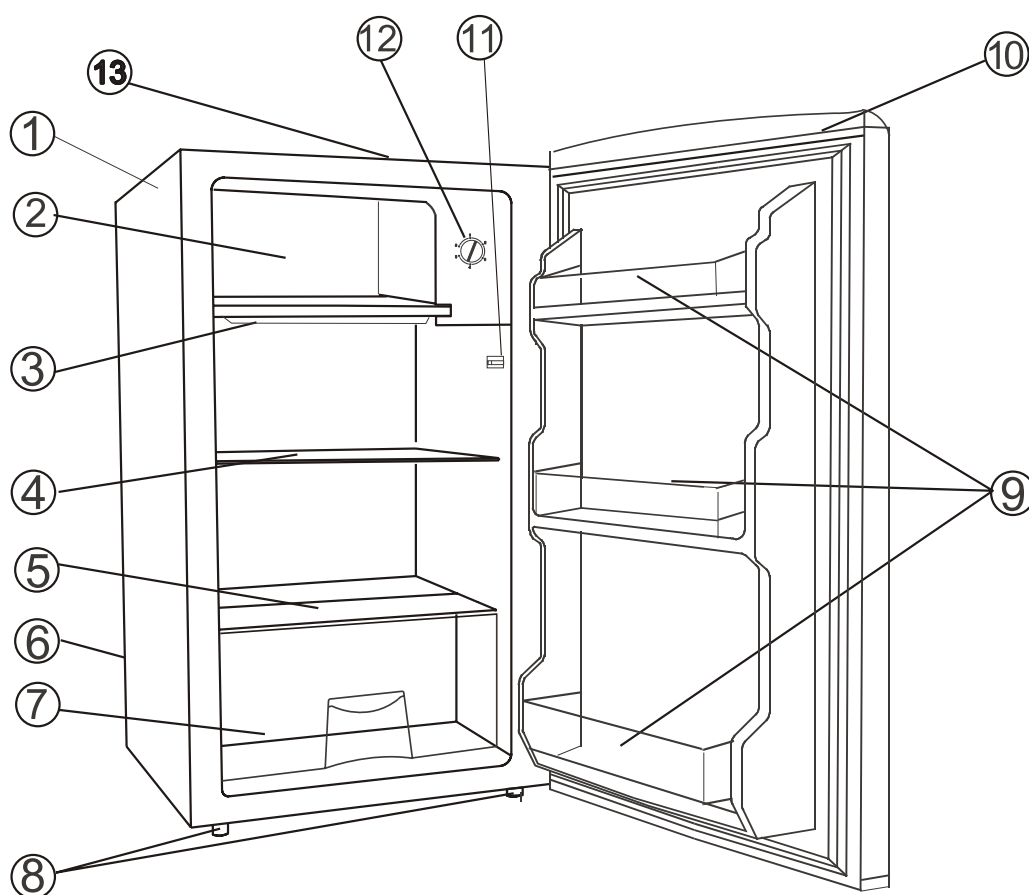

- 1. Cabinet
- 2. Ice maker Compartment Door
- 3. Drip Tray
- 4. Shelves
- 5. Glass cover
- 6. Compressor(back)
- 7. Crisper box

- 8. Leveling feet
- 9. Bottle Racks
- 10. Integrated Handle
- 11. Door switch
- 12. Temperature Control Knob
- 13. Top Cover

BEFORE USING THE APPLIANCE

- Your new appliance is designed exclusively for domestic use

To get the most out of your new appliance, read the user handbook thoroughly. The handbook contains a description of the appliance and useful tips for storing food. Keep this handbook for future consultation.

1. After unpacking, make sure that the appliance is undamaged and that the door closes properly. Any damage must be reported to your dealer within 24 hours after delivery of the appliance.
2. Wait at least two hours before switching the appliance on in order to ensure the refrigerant circuit is fully efficient.
3. Installation of the appliance and electrical connections must be carried out by a qualified electrician, in accordance with the manufacturer's instructions and local safety regulations
4. Clean the inside of the appliance before using it.

SAFEGUARDING THE ENVIRONMENT

1. Packing

The packaging material is entirely recyclable, and marked with the recycling symbol. Follow local regulations for scrapping. Keep the packaging materials (plastic bags, polystyrene parts, etc.) out of reach of children, as they are potentially dangerous.

2. Scrapping

The appliance is manufactured using recyclable material.

This appliance is marked according to the European directive 2002/96/EC on Waste Electrical and Electronic Equipment (WEEE). By ensuring this product is disposed of correctly, you will help prevent potential negative consequences for the environment and human health, which could otherwise be caused by inappropriate waste handling of this product.

The symbol  on the product, or on the documents accompanying the product, indicates that this appliance may not be treated as household waste. Instead it shall be handed over to the applicable collection point for the recycling of electrical and electronic equipment. Before scrapping, make the appliance unusable by cutting off the power cable and removing the doors and shelves so that children cannot easily climb inside the appliance.

Disposal must be carried out in accordance with local environmental regulations for waste disposal. Deliver the appliance immediately to an authorized dump; do not leave it unattended even for a few days, since it is potentially dangerous for children. For more detailed information about treatment, recovery and recycling of this product, please contact your local city office, your household waste disposal service or the shop where you purchased the product.

Information:

This appliance does not contain CFCs. The refrigerant circuit contains R134a (HFCs) or R600a (HCs), see the rating plate inside the appliance.

Appliances with isobutane (R600a): Isobutane is a natural gas of low environmental impact. Caution is required, however, since isobutane is flammable. Therefore, ensure that refrigerant circuit pipelines are not damaged

Declaration of conformity

- This product has been designed for preserving food and is manufactured in compliance with Regulation (CE) No. 1935/2004.



- This product has been designed, manufactured and marketed in compliance with:
 - the safety objectives prescribed in the Low Voltage Directive 2006/95/CE (which replaced Directive 73/23/CEE as amended).
 - the protection requirements of the "EMC" 89/336/CEE directive, amended by Directive 93/68/CEE.
- Electrical safety of the appliance can only be guaranteed if it is correctly connected to an approved earthing system.



PRECAUTIONS AND GENERAL RECOMMENDATIONS

- During installation, make sure the appliance does not damage the power cable.
- Make sure the appliance is not placed near a heat source.
- To guarantee adequate ventilation, leave a space on both sides and above the appliance and follow the installation instructions.
- Keep the appliance ventilation openings free.
- Power cable modification or replacement must only be carried out by qualified personnel.
- It must be possible to disconnect the appliance from the power supply by unplugging it or by means of a mains two-pole switch installed upstream of the socket.
- Make sure the voltage specified on the rating plate corresponds to that of your home
- Install and level the appliance on a floor strong enough to take its weight and in a place suitable for its size and use.
- The appliance must be handled and installed by two or more persons.
- Be careful not to damage the floors when you move the appliance (e.g. parquet flooring).
- Do not use single/multiple adapters or extension cords.
- Install the appliance in a dry, well-ventilated place. The appliance has been configured for operation in places where the temperature falls within the following ranges, and within the climatic class given on the rating plate. The appliance may not work properly if it is left for a long time at a temperature outside the specified range.
- Do not store or use petrol, flammable liquids or gas in the vicinity of this or other electrical appliances. The vapours may cause fire or explosion.
- Do not use mechanical, electric or chemical means other than those recommended by the Manufacturer to speed up the defrost process.
- Do not damage the appliance refrigerant circuit pipes.
- Do not use or place electrical appliances inside the product if they are not of the type expressly authorised by the Manufacturer.
- This appliance is not designed for use by young children or the infirm without supervision.
- To avoid the risk of children becoming trapped and suffocating, do not allow them to play or hide inside the appliance.
- Do not swallow the contents (non-toxic) of the ice packs (where provided).
- Use the refrigerator compartment to store fresh food only and the low temperature compartment exclusively for the production and storage of ice cubes.
- Do not store glass containers with liquids in the ice maker since they may burst.
- Do not eat ice cubes or ice lollies immediately after taking them out of the ice maker since they may cause cold burns.
- Before carrying out any maintenance or cleaning, unplug the appliance or disconnect it from the power supply.
- **The Manufacturer declines any liability if the above advice and precautions are not respected.**

Climatic Class	Amb. temp. (°C)	Amb. temp. (°F)
SN	From 10 to 32	From 50 to 90
N	From 16 to 32	From 61 to 90
ST	From 16 to 38	From 61 to 100
T	From 16 to 43	From 61 to 110

INSTALLATION

- Install the appliance away from heat sources. Installation in a hot environment, direct exposure to the sun or installation near heat sources (heaters, radiators, cookers) will increase power consumption and should therefore be avoided.
- **Keep at least 5 cm clearance at the rear of the appliance**
- Leave at least 5 cm clearance above the appliance and ensure any adjacent units allow sufficient space for air circulation.
- Install the appliance in a dry, well-ventilated place, and ensure it is level, using the front adjustment foot if necessary.
- Clean the interior and fit the accessories supplied.
- Fill the ice cube tray (if provided) with water and place it in the low temperature compartment.

Electrical Connection

- **Electrical connections must be made in accordance with local regulations.**
- Voltage and power consumption are indicated on the rating plate inside the appliance at the bottom left hand side, at the side of the crisper drawer.
- **Regulations require that the appliance is earthed. The manufacturer declines all liability for injury to persons or animals and for damage to property resulting from failure to observe the above procedures and reminders.**
- If the plug and socket are not of the same type, have the socket replaced by a qualified electrician.
- Do not use extension leads or adapters.



CHANGING THE REVERSIBLE DOOR

This refrigerator has been built with the door hinges on the right. If you wish to change the opening direction, follow the instructions below:

1. Remove the screws (6) which fix the worktop to disassembly the worktop (If applicable)
2. Remove the two screws (1) that hold the upper hinge (5) (right side) to the frame. Take away the upper hinge (5).
3. Lift the door and place it on a padded surface to prevent scratching it.
4. Remove the two screws (8) that hold the lower hinge (2) and Make sure to Remove the lower hinge (2).
5. Remove the left front leg (4) and transfer it to the right side.
6. Before placing this lower hinge (2), remove the bolt-pin (9) and reverse the direction of the lower hinge (2). Then install the lower hinge (2) onto the left side of the lower frame with two screws (8).
7. Insert the bolt-pin (9) to the lower hinge (2).
8. Set the door to its place making sure the door seat at the lower hinge (2)
9. While holding the door in the closed position secure the upper hinge (5) in the top frame of left side with two screws (1). Please remember that do not tighten the two screws (1) until the top of the door is levelled with the counter top.
10. Install the worktop onto the top of the cabinet with screws (6) (If applicable)

Figura 1

Represents position of components prior to door reversal.

Figura 2

Represents position of components after door reversal.



Figura 1



Figura 2

HOW TO OPERATE THE REFRIGERATOR COMPARTMENT

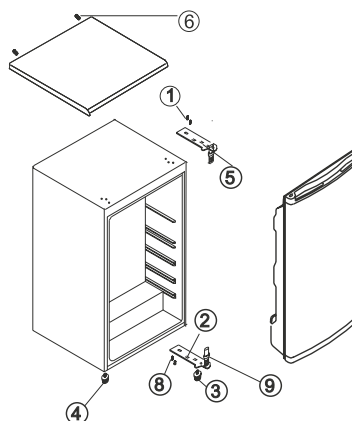
Switching on the appliance

Starting up the appliance

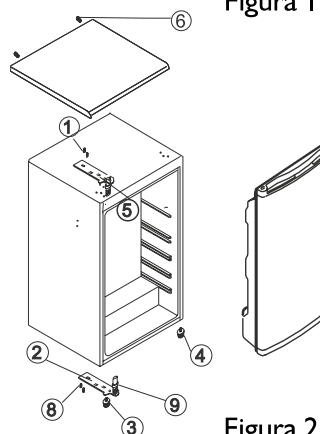
- Plug in the appliance.
- The inside light, where provided, switches on when the refrigerator door is opened.

Adjusting the temperature

Ensure the water collection tray, located below the low temperature compartment, touches the rear wall of the refrigerator unit.

The thermostat, located on the right hand side of the refrigerator compartment, is used to adjust the internal temperature.

To adjust the temperature in the refrigerator compartment, turn the thermostat control knob:

- lowest numbers **1 ÷ 2** for the **LEAST COLD** internal temperatures;
- numbers **3 ÷ 4** for a **MEDIUM** compartment temperature;
- number **5** for a **COLDEST** temperature.

Thermostat set to ●: the appliance is switched off although it remains connected to the mains power supply.

Note:

The ambient air temperature, frequency of door opening and the position of the appliance can affect internal temperatures. These factors must be taken into account when setting the thermostat.

Position of water collection tray:

When the room temperature is above 25°C, pull the water collection tray forwards (**Fig. 1**).

How to use the refrigerator compartment

Position food as follows:

- A. Cooked foods, cakes, soup/pasta**
- B. Fish, meat, cold cuts**
- C. Fruit and vegetables**
- D. Bottles, canned produce**

Notes:

- The space between the shelves and the rear wall of the refrigerator compartment must be unobstructed to allow circulation of air.
- Do not place food in direct contact with the rear wall of the refrigerator compartment.
- Do not place hot food in the refrigerator.
- Store liquids in closed containers.

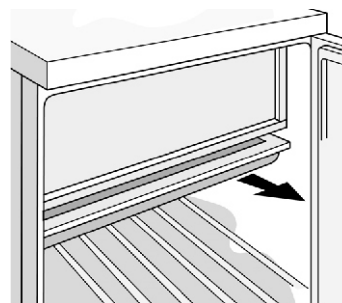

(Fig. 1)

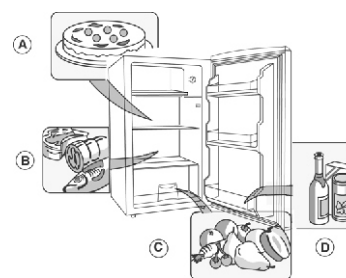

HOW TO OPERATE THE LOW TEMPERATURE COMPARTMENT

Defrosting in low temperature compartment is operated manually. Before defrosting, take the food, the ice tray and the shelf out into low temperature compartment temporarily then set the knob of the temperature regulator to position "0" (where the compressor will stop working) and leave the door open until ice and frost dissolve thoroughly deposited at the bottom of ice – maker, wipe off the water with soft cloth. In the case of speeding up the defrosting, you may put a bowl of warm water (about 50°C) into the low temperature compartment, and be sure to set the knob of the temperature regulator to original position after defrosting.

Do not use sharp objects or metal instruments to remove ice.

HOW TO DEFROST AND CLEAN THE REFRIGERATOR

Before any cleaning or maintenance operation, unplug the appliance from the mains or disconnect the electrical power supply.

Defrosting of the refrigerator compartment is completely automatic.

Droplets of water on the rear wall of the refrigerator compartment indicate that the periodic automatic defrost cycle is in progress.

The defrost water is automatically routed to a drain outlet and into a container from which it evaporates.

Regularly clean the inside of the defrost water drain hole in order to guarantee the constant and correct flow of defrost water.

Defrosting the low temperature compartment

Defrost the low temperature compartment once or twice a year or when the ice formation is excessive.

It is perfectly normal for ice to form. The amount of ice which forms and the rate at which it accumulates will depend on room temperature and humidity, and on the frequency with which the door is opened. Ice formation is concentrated at the top of the compartment and does not affect the efficiency of the appliance.

If possible, defrost the ice maker when it is nearly empty.

- Remove the food from the ice maker, wrap in newspaper and group together in a cool place or in a portable cooler.
- Leave the door open to allow the frost to melt.
- **Clean the interior with a sponge soaked in warm water and/or neutral detergent. Do not use abrasive substances.**
- Rinse the interior and dry thoroughly.
- Put the food back into the ice maker.
- Close the door.
- Plug in the appliance once again.
- Switch the appliance on.



CARE AND MAINTENANCE

Before any cleaning or maintenance operation, unplug the appliance from the mains or disconnect the electrical power supply.

- Clean the interior periodically with a sponge soaked in warm water and/or neutral detergent. Do not use abrasive substances.
- Rinse the interior and dry thoroughly.
- Clean the inside of the low temperature compartment when defrosting.
- Clean the outside with a damp cloth. Do not use abrasive products, scourers, stain-removers (e.g. acetone, trichloroethylene) or vinegar.
- Periodically clean air vents and the condenser at the rear of the appliance with a vacuum cleaner or a brush.

Prolonged disuse

1. Empty the refrigerator.
2. Disconnect the appliance from the power supply.
3. Defrost and clean the interior.
4. In the event of prolonged disuse, leave the door open to prevent the formation of mould, odours and oxidation.
5. Clean the appliance.

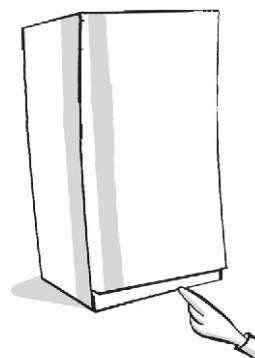

Clean the outside using a soft cloth.

- Clean the inside of the low temperature compartment (where fitted) when defrosting.
- Periodically clean the inside of the refrigerator compartment with a sponge dampened in warm water and/or neutral detergent. Rinse and dry with a soft cloth. Do not use abrasive products, scourers, stain-removers e.g. acetone, trichloroethylene) or vinegar.

Replace bulb.

1. Remove the water drip tray.
2. Hold the lamp cover and push toward inside of the cabinet.
3. Remove the lamp cover.
4. Unscrew the bulb and screw the new bulb.
5. Hold the lamp cover and put the hook of the lamp cover to click the thermostat box.
6. Pull the lamp cover to click the thermostat box.
7. Assemble the water tray.



TROUBLESHOOTING GUIDE

When you hear these noises

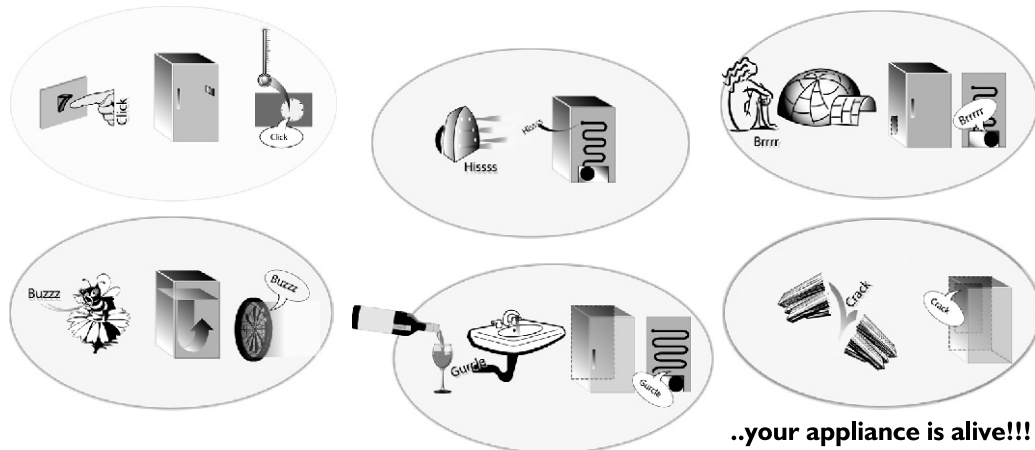

..your appliance is alive!!!

1. The appliance is not working.

- Is there a power failure?
- Is the power cord in perfect condition?
- Is the plug properly inserted in the socket?
- Is the thermostat set to ● (Stop) or ❄ (defrost)?

2. Temperature inside the compartments is not low enough.

- Is the door shut properly?
- Is there an excessive frost build-up in the low temperature compartment?
- Is the appliance installed near a heat source?
- Is the thermostat setting correct?
- Are the air circulation vents blocked?

3. Temperature inside the refrigerator compartment is too low.

- Is the thermostat setting correct?

4. The appliance is excessively noisy.

- Has the appliance been installed correctly?
- Are the pipes at the back touching or vibrating?

5. Water collects at the bottom of the refrigerator compartment.

- Is the thermostat setting correct?

6. The inside light is not working.

- Is there a power failure?
- If not, unplug the appliance from the mains, remove the cover and check the bulb has not come loose. If necessary, replace the bulb with a new one (max 10 W).

Notes:

Gurgling and hissing noises due to expansion in the refrigerant circuit are normal.



AFTER-SALES SERVICE

Before contacting After-Sales Service:

1. See if you can solve the problem yourself (see "Troubleshooting guide").
2. Switch the appliance on again to see if the problem has been solved. If it has not, disconnect the appliance from the power supply and wait for about an hour before switching on again.
3. If the problem persists after this course of action, contact After-sales Service.

Specify:

- The nature of the problem.
- The model.
- The Customer Service number (the number after the word SERVICE on the data plate on the inside of the appliance).

SERVICE XXXX XXX XXX



- Your full address.
- Your telephone number and area code.