

# nutribullet

## CRISPLITE™

6L AIR FRYER



# User guide



**WARNING!** To reduce the risk of serious injury, read the User Guide before operating your nutribullet CrispLite™ 6L Air Fryer. Save these instructions. Be sure anyone who uses the nutribullet® knows how to do so safely.

# Important safeguards and cautionary information.

**Warning! To avoid the risk of serious injury, carefully read all instructions before operating your nutriBullet® SuperCrisp™ Lite 6L Air Fryer.** When using any electrical appliance, basic safety precautions should always be observed, including the following **important information.**

**WARNING: To prevent risk of severe personal injury and/or property damage, use extreme caution when cooking.**

## PERSONAL SAFETY



**DO NOT TOUCH HOT SURFACES.** Never touch the sides of the drawers, crisper plates or inside of the appliance during or after operation. Always use insulated oven gloves or use the drawer handles when using the appliance.

During hot air frying, hot steam is released through air vents located on the sides and back of the unit. Keep your hands and face away from the steam and from the air vents. Use caution when removing the Cooking Drawers from the appliance as there may be hot steam.

Before moving or storing the unit, turn the unit **OFF, UNPLUG** the power cord, and wait for the appliance to cool.

Always turn the appliance **OFF** and **UNPLUG** from the outlet when not in use and before cleaning. Allow to cool down before assembling or

disassembling parts, and before cleaning the appliance.

**DO NOT** leave the appliance unattended when in use.

**DO NOT** attempt to remove the Cooking Drawers while the unit is in operation. Pause or turn the appliance off and ensure that the cooking action has completely stopped before removing the Cooking Drawers from the Base.

Removing the Cooking Drawer too quickly or forcefully may result in splattering of hot contents and may cause serious burns and injuries.

This appliance is not intended for use by persons (including children) with reduced physical, sensory, or mental capabilities, or lack of experience and knowledge, unless they are closely supervised and instructed concerning use of the appliance by a person responsible for their safety.

Close supervision is necessary when any appliance is used by or near children. Children should be supervised to ensure that they **DO NOT** play with the appliance.

The use of attachments not recommended or sold by nutriBullet® may cause personal injury or property damage.

**Never overfill ingredients. Leave at least 50mm of space between your food and the top of the Cooking Drawer. Keep all ingredients within the basket and prevent any direct contact with the heating element. Overfilling the unit may result in personal injury, property damage, or affect the safe use of the appliance.**

**Do not use the appliance for any other purpose than described in this manual. Misuse may cause injury.**

**Always use caution when operating the appliance with hot food. Improper use not in accordance with the safeguards contained in the user manual may result in serious personal injury or property damage.**

**Never store anything on top of the appliance.**

**DO NOT** immerse the appliance, or power cord in water or any other liquid. To prevent electric shock and short-circuit, avoid any liquid from entering the appliance.

**NEVER** pour oil into the Cooking Drawers as this could result in fire or personal injury.

## PRODUCT SAFETY

**FOR COUNTERTOP USE ONLY.** Make sure the surface is level, heat-resistant, stable, clean and dry. **DO NOT** place the unit near the edge of the countertop during use. Never use a power outlet below counter which can make the cord accessible to children.

We recommend placing a heat proof mat underneath your appliance when in use, to protect your benchtop from the risk of heat damage.

Any significant spillage onto the surface under or around the appliance, or onto the appliance itself, should be cleaned and dried before continuing to use the appliance.

Always ensure that the Cooking Drawer is thoroughly dried after cleaning and is positioned correctly before use.

**DO NOT** put any **NON**-food items into the Cooking Drawer for the purpose of frying or heating.

**DO NOT** use the appliance for deep frying with oil. **DO NOT** use the appliance for deep frying.

When using this appliance, provide adequate air space (at least 200mm) above, below, and on all sides for circulation.

**DO NOT** cover the air outlet vent, located on the back of the unit, while the unit is operating.

**DO NOT** place on or near a hot gas or electric burner, in a heated oven, or on a stovetop.

**DO NOT** place the appliance close to flammable materials such as curtains, and **DO NOT** place anything above or on top of the appliance when in use.

**DO NOT** use this appliance if any parts appear to be damaged. If you have any questions or concerns, please contact customer service (AU: 1300 285538 / NZ: 0800 232 633).

**WARNING!** This product is not intended for use outside of Australia and New Zealand. **DO NOT** use this product in locations with different electrical specifications or plug types. **DO NOT** operate with any type of plug adapter or voltage converter device, as these may cause electrical shorting, fire, electric shock, personal injury or product damage.

**DO NOT** modify the plug in any way.

To unplug, grasp the plug and pull from the outlet. Never pull from the power cord.

**DO NOT** let the power supply cord hang over the edge of a table or countertop.

**DO NOT** let the power supply cord touch hot surfaces, including stove, or become knotted or tangled.

Regularly inspect the power cord, plug, and appliance for any damage. **DO NOT operate any appliance with a damaged cord or plug or if the appliance malfunctions, or is dropped or damaged in any manner. If the supply cord is damaged, it must be replaced by a qualified electrician in order to avoid a hazard.**

The appliance is not intended to be operated by means of an external timer or separate remote-control system.

Remove and safely discard any packaging material or promotional labels before using the appliance for the first time.

If your nutribullet® malfunctions in any way, immediately discontinue use and contact Customer Service. You may purchase new nutribullet® attachments or other parts at **bulletbrands.com.au/bulletbrands.co.nz** or by contacting customer service (AU: 1300 285538 / NZ: 0800 232 633).

Any maintenance other than cleaning should be performed by a qualified electrician. **DO NOT** attempt to repair or service this appliance yourself.

This appliance is for household use only. Do not use this appliance for anything other than its intended use. Do not use in moving vehicle or boats. Do not use outdoors.

This appliance is intended to be used in household and similar applications such as:

- staff kitchen areas in shops, offices and other working environments;
- farm houses;
- by clients in hotels, motels and other residential type environments;
- bed and breakfast type environments

If you have any questions or comments or if some aspect of this user guide is not clear, please contact customer service for assistance at **bulletbrands.com.au/bulletbrands.co.nz**.

## ! Save these instructions!

# Contents



- 08 What's included**
- 09 Assembly guide**
- 10 Control panel**
- 12 Usage instructions**
  - 12 Before first use
  - 13 Assembly
  - 13 Using the Air Fryer
- 16 Care & maintenance**
  - 16 Replacement parts
- 17 nutribullet® CrispLite™ 6L Air Fryer**  
**One-year limited warranty**

Thank you for purchasing the nutribullet CrispLite™ 6L Air Fryer.

# What's included

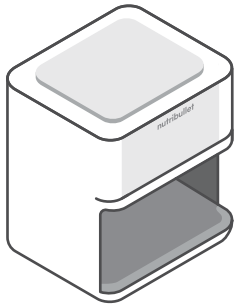

**1700 watt  
air fryer base**

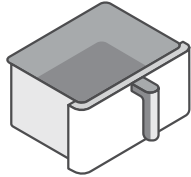

**6 L cooking  
basket**



**3-in-1 reversible  
grill, pizza, &  
crisping plate**

# Assembly guide

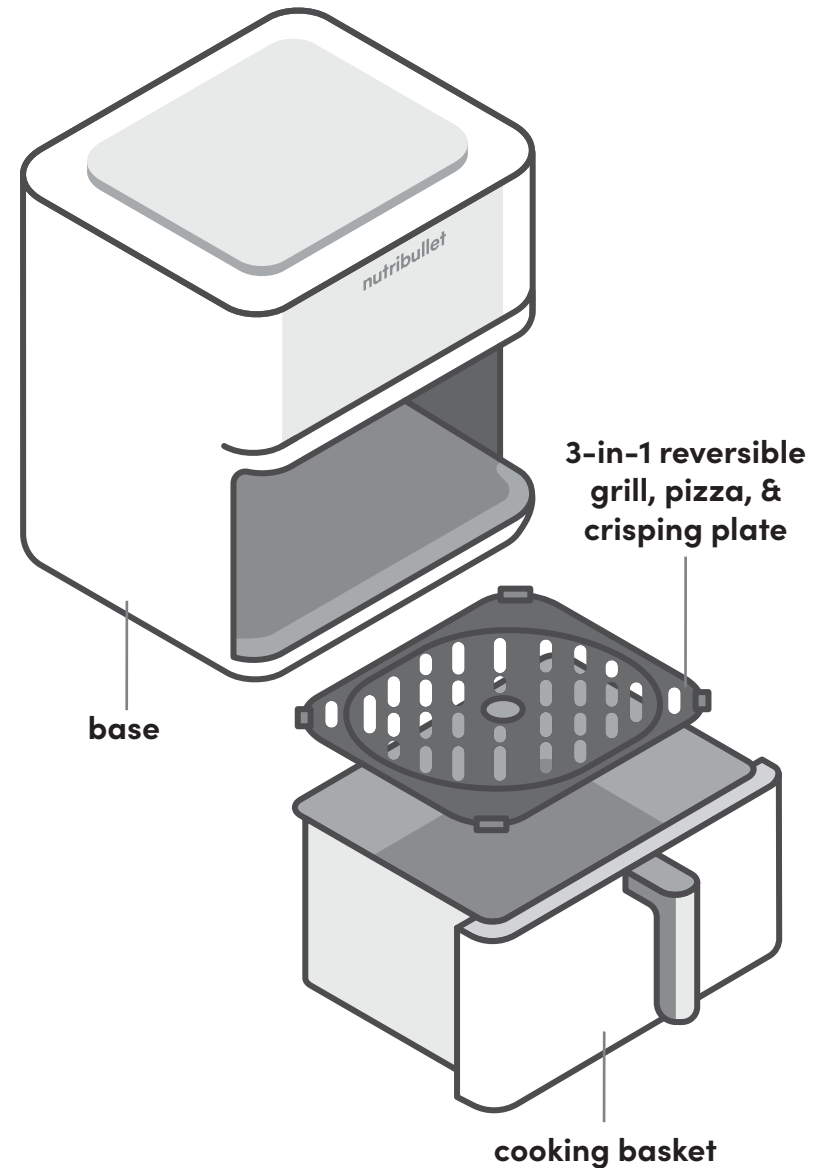

# Control panel

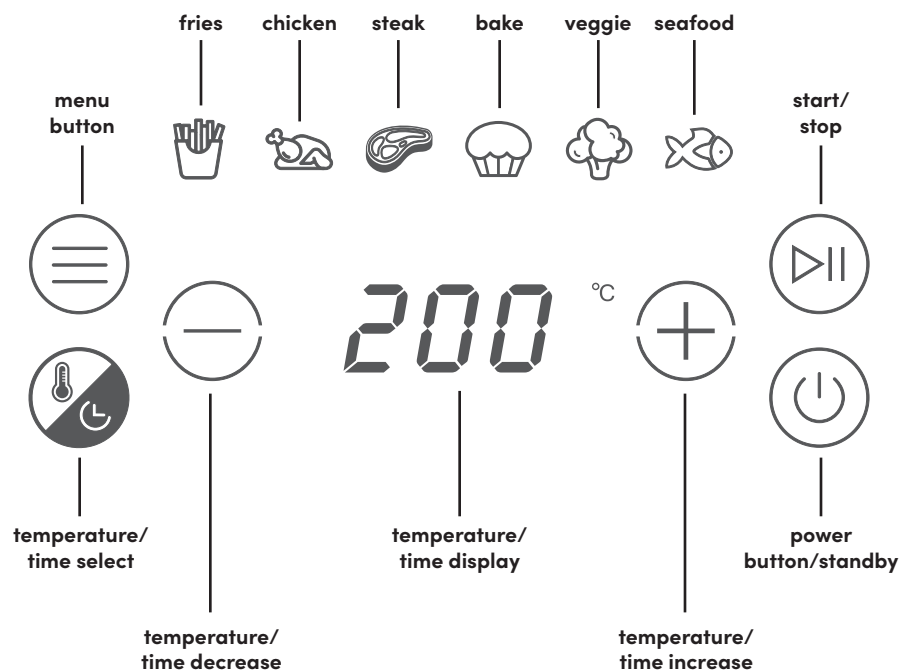

To select a cooking program, press the Menu button until your desired cooking program is flashing. The program will load with its default time and temperature, as noted in the table below. To begin cooking, press the Start/Stop button.

Icon	Program	Default Temperature	Default Cooking Time
	Fries	200°C	20 minutes
	Chicken	180°C	30 minutes
	Steak	200°C	16 minutes
	Bake	160°C	16 minutes
	Vegetable	180°C	16 minutes
	Seafood	180°C	16 minutes

- Press **Temp/Time** and use the **+/-** buttons to manually set cooking temperature or cooking time. Each press of the **+/-** buttons will adjust by increments of 1 minute for time or 5 degrees for temperature. Press **Start/Pause** to start cooking. You can adjust your Air Fryer's time or temperature at any time.
- Press **Start/Pause** when cooking to pause Air Fryer activity. Press **Start/Pause** again to resume. The Air Fryer will power off after 10 minutes of inactivity if in the Pause state.
- Press and hold power button for 5 seconds to reset the air fryer's settings while cooking.
- The Air Fryer will power off after 5 minutes of inactivity if the basket is in, and will power off after 10 minutes of inactivity if the basket is out.

# Usage instructions

## Before first use

Before using your nutribullet CrispLite™ 6L Air Fryer for the first time, please take a moment to perform the steps below.

### 1. UNPACK

Open the box and remove the **Air Fryer Base with Cooking Basket** and **3-in-1 Reversible Grill, Pizza, & Crisping Tray**, placing all parts on a flat, level, and dry surface.

### 2. CLEAN

Rinse **Cooking Basket** and **3-in-1 Reversible Grill, Pizza, & Crisping Tray** with hot soapy water. Wipe exterior of **Air Fryer Base** with a clean, damp cloth.

### 3. PREPARE COOKING AREA, ENSURE PROPER VENTILATION

Ensure the **Air Fryer** is used on a clean, dry, flat surface. Do not use the unit outdoors. The **Air Fryer** should be at least 20cm away from the wall when in operation, to ensure proper air ventilation behind the unit.

**NOTE:** To eliminate any new-machine odors that may be present or to thoroughly clean the inside of the Air Fryer, you can run the Air Fryer at its highest temperature about 5 minutes without putting any food inside.

**NOTE:** We suggest placing the unit on top of a heat proof mat to prevent risks of heat damage to surface of benchtop.

⚠ **NEVER** overfill the Cooking Basket. Leave at least 50mm of space between at the top of the Cooking Basket. Overfilling the Cooking Basket prevents the hot air from circulating, which may cause smoke and possible fire hazard. Overfilling may also cause the food to come into contact with the heating element, which may cause smoke and or possible fire. To prevent possible injury or damage, it is recommend to to break up the food into smaller portions.

⚠ **CAUTION.** Thoroughly clean the Cooking Basket after each use to prevent the accumulation of oil and food debris that can create smoke and a potential fire hazard. For optimal results, apply oil directly onto the food before placing in the Cooking Basket.

## Assembly

Review all warning and caution statements in the Important Safeguards section (pages 2-5) and in the section above before proceeding to Step 1.

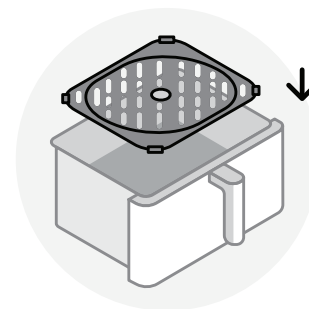

- 1 **Insert the 3-in-1 Tray into the bottom of the Cooking Basket.** Make sure the **3-in-1 Tray** is seated securely and is level with the bottom of the **Cooking Basket**.

## Using the Air Fryer

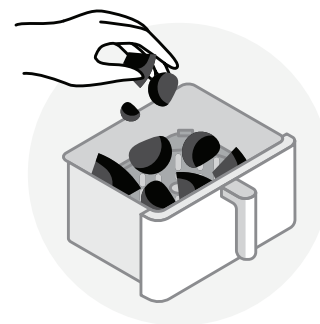

- 1 **Place food into the Cooking Basket, being careful not to overfill.** For best cooking results, leave at least 50mm of space between your food and the top of the **Cooking Basket**.

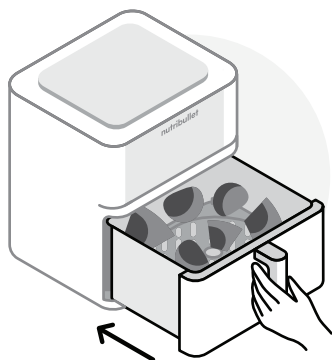

- 2 Holding the Cooking Basket by the handle, place it into the Base.** Ensure the Air Fryer is properly assembled with the **Cooking Basket** fully seated inside of the **Base**. Plug the unit in and press the Power button to turn the Air Fryer on.

**NOTE:** The Air Fryer will not operate unless the **Cooking Basket** is installed correctly.



- 3 TO USE A COOKING PROGRAM:** Press the **Menu** button until your desired cooking program flashes. The default time and temperature for the flashing program will load on the **Control Panel**. Press the **Start/Stop** button to begin cooking.

**TO CHANGE TEMPERATURE/ TIME SETTING:** To change a setting or to adjust a program's cooking temperature or time after it has been selected, press the **Time/Temperature** button and use the **+/-** buttons to first adjust the temperature. Once you've reached your desired temperature, press the **Time/Temperature** button again to set. Use the **+/-** buttons to adjust your cooking time. Once you've reached your desired time, press the **Start/Stop** button to set the time and begin cooking.

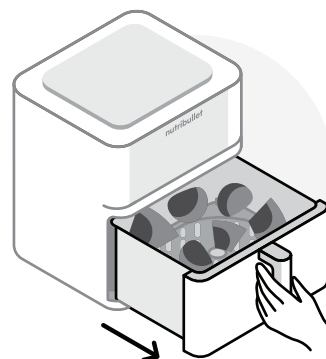

- 4 TURNING FOOD DURING COOKING:** Some recipes call for taking the **Cooking Basket** out during cooking and turning food. If so, first press the **Start/Stop** button to pause the Air Fryer. When the cooking has paused, remove the **Cooking Basket** from the **Base** using the handle. Turn your food using a utensil, and place the **Cooking Basket** securely back in the **Base**. Press the **Start/Stop** button to resume cooking.

**! WARNING:** CONTENTS may be very hot. Use caution when removing the **Cooking Basket** as there may be hot steam. Keep your hands and face away from the steam and from the air vents.

**! WARNING:** Food, **Cooking Basket**, and Tray are hot. Always use oven gloves when handling.



- 5 Once the Air Fryer has reached the end of its cooking time, you will hear 3 beeps to alert you that the cooking has completed.** Wait a few seconds so the cooking action comes to a stop.

**! CAUTION:** Removing the **Cooking Basket** too quickly may result in splattering and could potentially be dangerous.

**! CAUTION:** Be careful when opening the **Cooking Basket** as there may be hot steam.

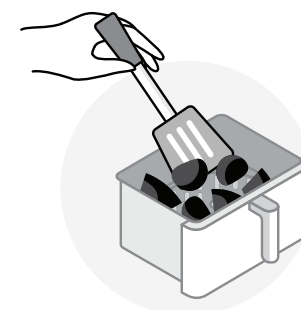

- 6 Remove the food from the Cooking Basket using a utensil – NEVER use your hands. Turn off Air Fryer by pressing and holding Power Button until the unit powers off. Enjoy!**



# Care & maintenance

Cleaning the nutribullet CrispLite™ 6L Air Fryer is quick and easy. We recommend cleaning all removable parts after each use to reduce the buildup of residue.

## STEP 1:

Turn the Air Fryer **OFF**, unplug the unit, and allow it to cool down thoroughly after use.

## STEP 2:

Remove the **Cooking Basket** and **3-in-1 Tray**. The **Cooking Basket** and **Tray** are **TOP RACK** dishwasher safe, or can be cleaned by rinsing in warm soapy water. **DO NOT** place the **Air Fryer Base** in the dishwasher.

 **WARNING: NEVER** use the sanitise cycle – heat this high can warp the plastic.

 **CAUTION: DO NOT** use an abrasive or metal cleaning tool or any kind of oven cleaner to clean the **Cooking Basket** or **Crisping Tray**. Doing so can damage the ceramic non-stick coating on the surface of these items.

## STEP 3:

Clean the inner wall of the **Air Fryer Base** by gently wiping off any residue with a warm cotton cloth, then dry it with a dry cloth. The interior and exterior of the **Base** should only be cleaned by wiping it with a damp cloth.

 **CAUTION: NEVER** submerge the **Base** in water or any other liquid.

If required, brush the heating element with a soft-medium bristle brush to remove food particles.

## STEP 4:

Once all parts have been cleaned and thoroughly dried, store the Air Fryer fully assembled in a safe, dry location.

# Replacement parts

Use of incompatible parts or aftermarket parts may result in damage to your nutribullet CrispLite™ 6L Air Fryer or create safety hazards that may cause personal injury or damage. When ordering replacement parts always use genuine nutribullet® parts and accessories from [bulletbrands.com.au/bulletbrands.co.nz](https://bulletbrands.com.au/bulletbrands.co.nz).

# CDB GOLDAIR one (1) year limited replacement warranty statement.

**If your product becomes defective due to faulty material or workmanship within a period of One (1) Year from the date of purchase, we warrant to do the following:**

- **For New Zealand Consumers:**  
We will replace the defective product with a new product, free of charge, or repair the product at our cost, at our discretion.
- **For Australian Consumers:**  
Our goods come with guarantees that cannot be excluded under the Australian Consumer Law. You are entitled to a replacement or refund for a major failure and for compensation for any other reasonably foreseeable loss or damage. You are also entitled to have the goods repaired or replaced if the goods fail to be of acceptable quality and the failure does not amount to a major failure.

**YOUR WARRANTY IS SUBJECT TO THE FOLLOWING CONDITIONS:**

- **DO NOT** operate the appliance with a damaged plug or cord, or if the unit has been dropped, damaged or dropped in water. To avoid the risk of electric shock, do not disassemble or attempt to repair the appliance on your own. If the supply cord is damaged, it must be replaced by a qualified electrician in order to avoid a hazard. Incorrect re-assembly or repair can cause a risk of electric shock or injury to persons when the appliance is used.
- The item has not been misused, abused, neglected, altered, modified or repaired by anyone.
- The item has been subjected to fair wear and tear.
- The item has not been used for trade, professional or hire purposes.

- The item has not sustained damage through foreign objects, substances or accident.

**YOUR WARRANTY  
DOES NOT COVER:**

- Components that are subject to natural wear and tear caused by normal use in accordance with operating instructions.
- Unauthorised/improper maintenance/handling or overload is excluded from this warranty.
- For guarantee claims, you will need to submit a proof of purchase in the form of a valid receipt that displays date and place of purchase.

**This warranty does not replace but is in addition to your statutory rights.**

**This warranty does not apply to accessories supplied with the item.**

**This warranty applies only to the original purchaser and may not be transferred.**

**Replacement items will be covered by the limited warranty for the balance of the warranty period from the date of the original purchase.**

**PLEASE NOTE:**

Only the defective product or parts returned to place of purchase will be replaced under this warranty.

---

**CDB**  **GOLDAIR**

**NEW ZEALAND**

PO Box 100-707  
NSMC  
Auckland 0745  
0800 232633  
bulletbrands.co.nz

**AUSTRALIA**

PO Box 574  
South Morang  
Victoria 3752  
1300 285538  
bulletbrands.com.au

**220-240VAC 50-60Hz 1700W**

**Capital Brands Distribution, LLC | All rights reserved.**

nutribullet® and the nutribullet logo are trademarks of CapBran Holdings, LLC registered in the U.S.A. and worldwide.

Illustrations may differ from the actual product. We are constantly striving to improve our products, therefore the specifications contained herein are subject to change without notice.

**250310\_NBA07300 (NBA-300)**