

Your washing machine

Congratulations – You have opted for a modern, high-quality domestic appliance manufactured by Bosch. The washing machine is distinguished by its economical energy consumption.

Each appliance which leaves our factory is inspected thoroughly to ensure that it functions properly and is in perfect condition.

For further information and a selection of our products go to our web site: www.bosch-home.com

Environmental disposal

Dispose of packaging in an environmentally friendly manner.

This appliance has been identified in accordance with the European Directive 2002/96/EG on Waste Electrical and Electronic Equipment (WEEE).

The Directive specifies the framework for an EU-wide valid return and recycling of waste appliances.

Contents

	Page
■ Intended use	1
■ Programmes	1
■ Setting programme	3
■ Washing	3/4
■ After washing	4
■ Individual settings	5
■ Important information	6
■ Overview of programmes	7
■ Safety instructions	8
■ Consumption values	8
■ Care	9
■ Information on the display panel	9
■ Maintenance	10
■ What to do if ...	11

Intended use

- for use in the household only,
- for the washing of machine-washable textiles in a detergent solution,
- to be operated with cold drinking water and commercially available detergents and care products which are suitable for use in frontloading-washing machines.

- ⚠ Do not leave children unattended near the washing machine!
- The appliance is not intended for use by young children or infirm persons without supervision.
- Keep pets away from the washing machine!

Programmes

For detailed overview of programmes → Page 7.

Temperature and spin speed can be selected individually.

Cottons	hard-wearing textiles
Cottons Stains	
Cottons Eco	
Skin Care	
Easy-Care	easy-care textiles
Delicate/Silk	delicate washable textiles
Wool	hand/machine-washable textiles
Drain	the rinsing water if occurs
Spin	washing washed by hand
Gentle spin	washing washed by hand at reduced spin speed
Rinse/Freshen Up	with subsequent spin cycle; for hand-washed items, starching or "freshen up" items, → Page 6.
Sports Light	textiles made of microfibres
Express 15'	short programme
Mixed Load	different types of washing
Dark Load	dark textiles

Preparation

⚠ Correct installation according to separate installation instructions.

Checking the machine

- Never switch on a damaged machine!
- Inform your customer service!

Turn on water tap

Insert mains plug

- ⚠ With dry hands only! Take hold of the plug only!

Sorting and inserting the washing

Follow manufacturer's care information! According to the information on the care labels. According to type, colour, soiling and temperature. Do not exceed maximum load → Page 7.

Follow important instructions! → page 6!
Insert large and small items of washing! Close the washing machine door. Take care not to trap any items of clothing between the loading door and rubber seal.

Add detergent and care product

Meter accordingly: Washing amount, soiling, water hardness (ask your water supply company) and manufacturer's instructions. Pour liquid detergent into the appropriate dispenser and place in the drum.

- Dispenser I: Detergent for prewash
- Dispenser II: Fabric softener, starch
- Dispenser III: Detergent for main wash, fabric softener, bleaching agent, stain remover

ⓘ Dilute viscous fabric softener and fabric conditioner with water. Prevents blockage of the overflow.

Set and adjust programme

For additional functions and option buttons see individual settings, page 5.

ⓘ All buttons are sensitive, they only need to be touched gently! If the option buttons are touched for longer, the setting options run automatically!

ⓘ Programme selector for switching the machine on and off and for selecting the programme. Can be rotated in either direction.

Select Start/Pause

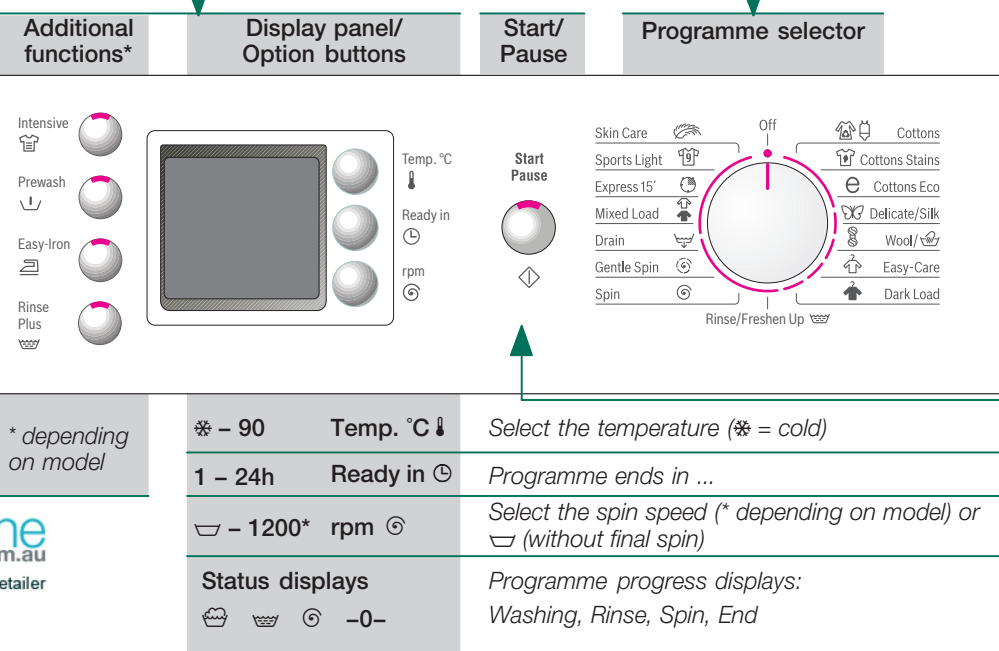

Before washing for the first time, wash once without any washing. → page 6

Wash

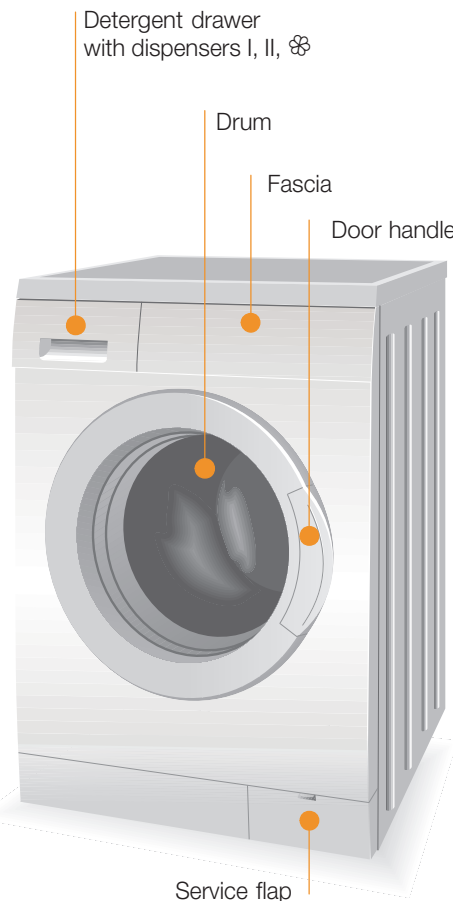

Removing washing

Open washing machine door and remove washing. If (without final spin) active: Set programme selector to **Drain** or select spin speed. Select **Start/Pause**. Remove any foreign objects – risk of rusting.

Turn off the tap

Switch off

Set programme selector to **Off**.

End of programme when ...

... **Start/Pause** flashes and **-0-** is indicated on the display panel.

Change programme ...

If you have mistakenly selected a wrong programme:
– Reselect programme.
– Select **Start/Pause**.

... or terminate

Programmes with high temperature, first:
– Cool washing: Select **Rinse/Freshen Up**.
– Washing machine door remains locked.
– Select **Off**.
– Select **Spin** or **Drain**.
– Select **Start/Pause**.

Individual settings

Option buttons

You can change the spin speed and temperature beforehand and while the selected programme is running. Effects dependent on the programme progress.

Temp. °C

You can change the indicated washing temperature. The maximum washing temperature which can be selected depends on the set programme.

Ready in

The respective programme duration is displayed by selecting the programme. The programme start can be delayed before the programme begins. The **Ready in**-time can be set in hour-steps up to maximum 24h. Keep pressing the **Ready in** button until the required number of hours is indicated (h=hour). Select **Start/Pause**.

rpm

You can change the indicated spin speed. The maximum spin speed which can be selected depends on the set programme.

Additional functions

Intensive	see also programme overview Extension of the washing time for a more intensive washing of highly soiled washing or 6.5 kg of cottons and coloureds.
Prewash	For heavily soiled, hard-wearing washing, e.g. made of cotton or linen. Prewash at 30 °C.
Easy -Iron (depending on model)	Special spin sequence with subsequent fluffing. Gentle final spin – residual moisture in the washing increased slightly.
Rinse Plus (depending on model)	Additional rinse cycle. For areas with very soft water or for further improvement of the rinsing result.

Start/Pause

For starting or interrupting the programme.

Signal

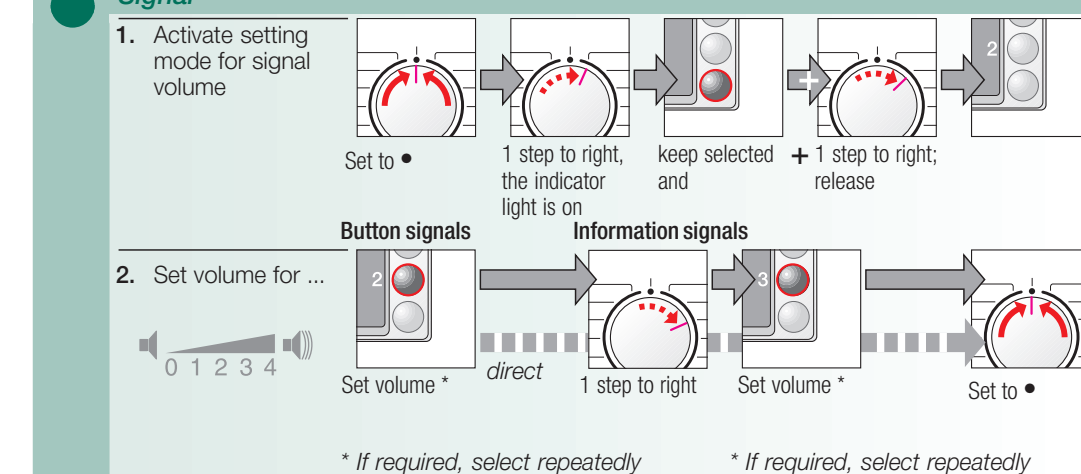

Important information

Protecting the washing and the machine

- Empty pockets.
- Remove metal parts (paper clips, etc.).
- Wash delicates in the net/bag (tights, curtains, underwired bras).
- Close zips, button up covers.
- Brush sand out of pockets and collars.
- Remove curtain fittings or include in the net/bag.

Before washing for the first time

Do not put any washing in the washing machine! Turn on the tap, fill approx. 1 litre of water and then pour ½ measuring cup of detergent into dispenser II. Set programme selector to **Easy-Care 60 °C** and select **Start/Pause**. At the end of the programme set the programme selector to **Off**.

Washing with different degrees of soiling

Light	Wash new items separately. Do not prewash.
Medium	If required, pretreat stains. Select Intensive additional function.
Heavy	Load less washing. Prewash.

Soaking

Load washing of the same colour
Pour soaking agent/detergent into dispenser II according to the manufacturer's instructions. Set programme selector to **Cottons 30 °C** and select **Start/Pause**. After approx. 10 minutes select **Start/Pause**. After the required soaking time reselect **Start/Pause** if the programme is to be continued or change the programme.

Starching

Washing should not be treated with fabric softener
Liquid starch can be used in all wash programmes. Meter starch into the fabric softener dispenser according to manufacturer's specifications.

Dyeing/Bleaching

Dye in small quantities only. Salt can corrode stainless steel. Observe the dye manufacturer's specification. Do not bleach laundry in the washing machine.

Freshen up

Use programme **Rinse/Freshen Up**
For items, that have been tucked away or stored for a period of time, to remove creases caused by folding and storage and to eliminate odours. Use fabric conditioner for "fresh" smell.

Protection of the environment/conservation tips

- Utilise the maximum amount of washing for the particular programme.
- Wash normally soiled washing without prewash.
- Instead of **Cottons 90 °C** select **Cottons Eco 60 °C** programme. Comparable cleaning result with significantly lower energy consumption.
- Meter detergent according to the manufacturer's instructions and water hardness.
- If the washing is then dried in the tumble dryer, select spin speed according to the instructions of the dryer manufacturer.

Your washing machine

Congratulations – You have opted for a modern, high-quality domestic appliance manufactured by Bosch. The washing machine is distinguished by its economical energy consumption.

Each appliance which leaves our factory is inspected thoroughly to ensure that it functions properly and is in perfect condition.

For further information and a selection of our products go to our web site: www.bosch-home.com

Environmental disposal

Dispose of packaging in an environmentally friendly manner.

This appliance has been identified in accordance with the European Directive 2002/96/EG on Waste Electrical and Electronic Equipment (WEEE).

The Directive specifies the framework for an EU-wide valid return and recycling of waste appliances.



Contents

Page

Intended use	1
Programmes	1
Setting programme	3
Washing	3/4
After washing	4
Individual settings	5
Important information	6
Overview of programmes	7
Safety instructions	8
Consumption values	8
Care	9
Information on the display panel	9
Maintenance	10
What to do if ...	11

Intended use

- for use in the household only,
 - for the washing of machine-washable textiles in a detergent solution,
 - to be operated with cold drinking water and commercially available detergents and care products which are suitable for use in frontloading-washing machines.
- !**
- Do not leave children unattended near the washing machine!
 - The appliance is not intended for use by young children or infirm persons without supervision.
 - Keep pets away from the washing machine!

Preparation



Correct installation according to separate installation instructions.



Checking the machine

- Never switch on a damaged machine!
- Inform your customer service!



Turn on water tap



Insert mains plug



With dry hands only!
Take hold of the plug only!



Dilute viscous
the overflow.

Programmes

For detailed overview of programmes → Page 7.

Temperature and spin speed can be selected individually.

Cottons	hard-wearing textiles
Cottons Stains	
Cottons Eco	
Skin Care	
Easy-Care	easy-care textiles
Delicate/Silk	delicate washable textiles
Wool	hand/machine-washable textiles
Drain	the rinsing water if occurs
Spin	washing washed by hand
Gentle spin	washing washed by hand at reduced spin speed
Rinse/Freshen Up	with subsequent spin cycle; for hand-washed items, starching or "freshen up" items, → Page 6.
Sports Light	textiles made of microfibres
Express 15'	short programme
Mixed Load	different types of washing
Dark Load	dark textiles

Additional functions*

Intensive
Prewash
Easy-Iron
Rinse Plus

Display panel/Option buttons

Temp. °C
Ready in
rpm

Start/Pause

Program

Skin Care
Sports Light
Express 15'
Mixed Load
Drain
Gentle Spin
Spin

* depending on model

– 90 Temp. °C
1 – 24h Ready in
– 1200* rpm

Status displays

–0–

Select the temperature
Programme ends in ...
Select the spin speed (without final spin)
Programme progress
Washing, Rinse, Spin, ...

Before washing for the first time,
wash once without any washing. -> page 6

Sorting and inserting the washing

Follow manufacturer's care information!
According to the information on the care labels.
According to type, colour, soiling and temperature.
Do not exceed maximum load -> Page 7.

Follow important instructions! -> page 6!

Insert large and small items of washing! Close the washing machine door. Take care not to trap any items of clothing between the loading door and rubber seal.

Add detergent and care product

Meter accordingly:
Washing amount, soiling, water hardness (ask your water supply company) and manufacturer's instructions. Pour liquid detergent into the appropriate dispenser and place in the drum.

Dispenser I: Detergent for prewash

Dispenser II: Fabric softener, starch

Dispenser III: Detergent for main wash, fabric softener, bleaching agent, stain remover

Do not mix fabric softener and fabric conditioner with water. Prevents blockage of

Set and adjust programme

For additional functions and option buttons see individual settings, page 5.

i All buttons are sensitive, they only need to be touched gently!
If the option buttons are touched for longer, the setting options run automatically!

i Programme selector for switching the machine on and off and for selecting the programme. Can be rotated in either direction.

Select Start/Pause ◀▶

(* = cold)

* depending on model) or

displays:

End

Wash

Detergent drawer
with dispensers I, II, III

Drum

Fascia

Door handle

Service flap

Wash

Removing washing

Open washing machine door and remove washing.
If ◀ (without final spin) active: Set programme selector to **Drain** or select spin speed.
Select **Start/Pause** ◀▶.
Remove any foreign objects – risk of rusting.

Turn off the tap

Switch off

Set programme selector to **Off**.

End of programme when ...

... **Start/Pause** ◀▶ flashes and **-0-** is indicated on the display panel.

Change programme ...

If you have mistakenly selected a wrong programme:

- Reselect programme.
- Select **Start/Pause** ◀▶.

... or terminate

Programmes with high temperature, first:

- Cool washing: Select **Rinse/Freshen Up** or **Spin** or **Drain**.
- Select **Off**.
- Select **Spin** or **Drain**.
- Select **Start/Pause** ◀▶.

Individual settings

Option buttons

You can change the spin speed and temperature beforehand and while the selected programme is running. Effects dependent on the programme progress.

Temp. °C

You can change the indicated washing temperature. The maximum washing temperature which can be selected depends on the set programme.

Ready in

The respective programme duration is displayed by selecting the programme. The programme start can be delayed before the programme begins. The **Ready in** -time can be set in hour-steps up to maximum 24h. Keep pressing the **Ready in** button until the required number of hours is indicated (h=hour). Select **Start/Pause**.

rpm

You can change the indicated spin speed. The maximum spin speed which can be selected depends on the set programme.

Additional functions *see also programme overview*

Intensive	Extension of the washing time for a more intensive washing of highly soiled washing or 6.5 kg of cottons and coloureds.
Prewash	For heavily soiled, hard-wearing washing, e.g. made of cotton or linen. Prewash at 30 °C.
Easy -Iron (depending on model)	Special spin sequence with subsequent fluffing. Gentle final spin – residual moisture in the washing increased slightly.
Rinse Plus (depending on model)	Additional rinse cycle. For areas with very soft water or for further improvement of the rinsing result.

Start/Pause

For starting or interrupting the programme.

Signal

1. Activate setting mode for signal volume

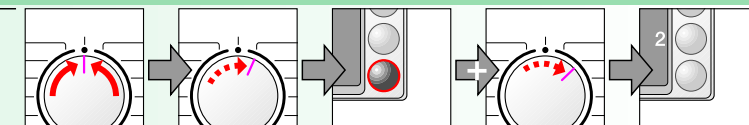

2. Set volume for ...

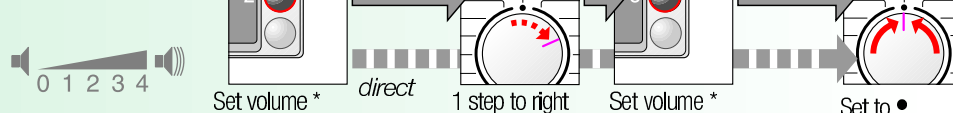

* If required, select repeatedly

* If required, select repeatedly



Important information



Protecting the washing and the machine

- Empty pockets.
- Remove metal parts (paper clips, etc.).
- Wash delicates in the net/bag (tights, curtains, underwired bras).
- Close zips, button up covers.
- Brush sand out of pockets and collars.
- Remove curtain fittings or include in the net/bag.



Before washing for the first time

Do not put any washing in the washing machine! Turn on the tap, fill approx. 1 litre of water and then pour ½ measuring cup of detergent into dispenser II. Set programme selector to **Easy-Care 60 °C** and select **Start/Pause**.

At the end of the programme set the programme selector to **Off**.



Washing with different degrees of soiling

Light	Wash new items separately. Do not prewash.
Heavy	If required, pretreat stains. Select Intensive additional function. Load less washing. Prewash.



Soaking *Load washing of the same colour*

Pour soaking agent/detergent into dispenser II according to the manufacturer's instructions. Set programme selector to **Cottons 30 °C** and select **Start/Pause**. After approx. 10 minutes select **Start/Pause**. After the required soaking time reselect **Start/Pause** if the programme is to be continued or change the programme.



Starching *Washing should not be treated with fabric softener*

Liquid starch can be used in all wash programmes. Meter starch into the fabric softener dispenser according to manufacturer's specifications.



Dyeing/Bleaching

Dye in small quantities only. Salt can corrode stainless steel. Observe the dye manufacturer's specification. Do **not** bleach laundry in the washing machine.



Freshen up *Use programme Rinse/Freshen Up*

For items, that have been tucked away or stored for a period of time, to remove creases caused by folding and storage and to eliminate odours. Use fabric conditioner for "fresh" smell.



Protection of the environment/conservation tips

- Utilise the maximum amount of washing for the particular programme.
- Wash normally soiled washing without prewash.
- Instead of **Cottons 90 °C** select **Cottons Eco 60 °C** programme. Comparable cleaning result with significantly lower energy consumption.
- Meter detergent according to the manufacturer's instructions and water hardness.
- If the washing is then dried in the tumble dryer, select spin speed according to the instructions of the dryer manufacturer.

Programme overview → Pay attention to the Consumption values table on page 8 and the information on page 6

Programmes °C max. Type of washing



Additional functions; information



Cottons	☼-90 °C			Intensive , Prewash , Easy-Iron , Rinse Plus
Cottons Stains				
Cottons Eco	☼-60 °C	6.5* kg	Hard-wearing textiles, heat-resistant textiles made of cotton or linen	Intensive , Prewash , Easy-Iron , Rinse Plus , for particularly sensitive skin, prolonged washing at selected temperature, higher water level, additional rinse cycle
Skin Care				
Easy-Care	☼-60 °C		Easy-care textiles made of cotton, linen, synthetic fibres or blended fabrics	Intensive , Prewash , Easy-Iron , Rinse Plus
Mixed Load	☼-40 °C	3 kg*	Textiles made of cotton and easy-care textiles	Intensive , Prewash , Easy-Iron , Rinse Plus , Different types of washing can be washed together
Dark Load	☼-40 °C		Dark textiles made of cotton and dark easy-care textiles	Intensive , Prewash , Easy-Iron , Rinse Plus , reduced rinse and final spin cycle
Delicate/Silk	☼-30 °C		For delicate, washable textiles, e.g. made of silk, satin, synthetic fibres or blended fabrics (e.g. curtains)	Intensive , Prewash , Easy-Iron , Rinse Plus , no spin cycle between the rinse cycles
Wool/	☼-40 °C	2 kg	Hand or machine-washable wool or rich-wool textiles	Especially gentle wash programme to prevent shrinkage, prolonged programme pauses (textiles rest in the detergent solution).
Sports Light	☼-40 °C		Textiles made of microfibres	Intensive , Prewash , Easy-Iron , Rinse Plus
Express 15'	☼-40 °C		Easy-care textiles made of cotton, linen, synthetic fibres or blended fabrics	Short programme approx. 15 minutes, suitable for lightly soiled laundry
Additional programmes				
Rinse/Freshen Up , Spin , Drain , Gentle spin				

The programmes are time-controlled for lightly soiled textiles. If textiles are heavily soiled, reduce the load or select additional functions, e.g. **Intensive** . Programmes without prewash – pour detergent into dispenser **II**, programmes with prewash – divide detergent between dispensers **I** and **II**.

* When washing the maximum load for programmes marked with *, always select the **Intensive** additional function.

Regardless of the type of washing, **Easy-Care** 40 °C with maximum spin speed is the best short programme for the job.

** according to model

Robert Bosch Hausgeräte GmbH
Carl-Wery Str. 34
81739 München / Germany

WAE22461AU
WAE24461AU

9000 357 647
1009



Safety instructions

- Read and follow the operating and installation instructions and all other information enclosed with the washing machine.
- Retain documents for subsequent use.

Risk of electric shock

- Never pull out the mains plug by tugging the power cord!
- Never insert/pull out the mains plug with damp hands.

Risk of injury

- Washing machine door may become very hot.
- Caution when draining hot detergent solution.
- Do not climb on the washing machine.
- Do not lean on the open washing machine door.
- Do not touch the drum in case it is still spinning.

Risk of poisoning

Risk of suffocation

- Caution when opening the detergent drawer while washing machine is running!
- Keep detergents and care products out of the reach of children.
- Keep packaging, plastic film and packaging parts out of the reach of children.

Danger to life

On redundant appliances:

- Pull out the mains plug.
- Sever the power cord and discard together with the plug.
- Destroy the lock on the washing machine door. This will prevent children from locking themselves in and suffocating.
- Caused by detergents containing solvents, e.g. stain remover/items of washing pretreated with solvent naphtha may result in an explosion after being loaded into the washing machine. Beforehand thoroughly rinse items of washing by hand.

Risk of explosion

Consumption values

Programme	Additional function	Load	Current**	Water**	Programme duration**
Cottons 40 °C	Intensive	6.5 kg	0.65 kWh	56 l	3:04 h
Cottons Eco 60 °C *	Intensive	6.5 kg	1.19 kWh	47 l	2:36 h
Cottons 90 °C	Intensive	6.5 kg	2.00 kWh	66 l	2:51 h
Easy-Care 40 °C	Intensive	3 kg	0.55 kWh	50 l	1:24 h
Easy-Care 40 °C	–	3 kg	0.54 kWh	40 l	0:55 h
Mixed Load 30 °C	–	3 kg	0.32 kWh	35 l	0:44 h
Delicate/Silk 30 °C	–	2 kg	0.25 kWh	38 l	0:32 h
Wool/ 30 °C	–	2 kg	0.15 kWh	34 l	0:40 h

* Programme setting with maximum spin speed for testing according to or in accordance with AS/NZS 2040.2 and AS/NZS 6400.

Note on comparative tests: test the test programme with maximum load, **Intensive** additional function selected, maximum spin speed.
A **short programme** which can be used for coloured items is **Easy-Care** 40 °C, without the **Intensive** additional function selected and set to maximum spin speed.

** The values deviate from the indicated values depending on water pressure, water hardness, water inlet temperature, room temperature, type and amount of washing and degree of soiling, utilised detergent, fluctuations in the mains voltage and selected additional functions.

Care



- Risk of electric shock!
Pull out the mains plug!
- Risk of explosion! No solvents!



Machine housing, control panel

- Wipe with a soft, damp cloth.
- Do not use abrasive detergents.
- Immediately remove washing and cleaning agent residue.
- Do not clean the appliance with a water jet.



Clean the detergent drawer ...

... if it contains detergent or fabric softener residue.

1. Pull out, depress insert, completely remove.
2. Open the cover.
3. Clean with water and dry.
4. Close and lock the cover (place cylinder on guide pin).
5. Insert detergent drawer.

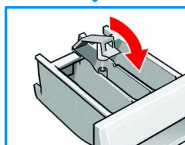
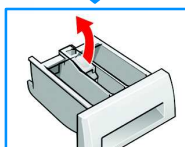
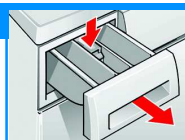

Leave detergent drawer open so that residual water can evaporate.



Drum

Leave washing machine door open so that the drum can dry out.
Rust stains – use chlorine-free cleaning agent, not steel wool.



Descaling No washing in the machine!

Descale according to the instructions of the descaling agent-manufacturer, not required for correct detergent dosage.

Information on the display panel depending on model

F:16 Close the washing machine door properly; washing may be caught.

F:17 Turn on the tap, supply hose kinked/jammed;
clean filter -> page 10, water pressure too low.

F:18 Detergent solution pump blocked; clean the detergent solution pump -> page 10.
Drainage hose / waste pipe blocked; clean the drainage hose at the siphon -> page 10.

F:21 Motor fault. Call customer service!

F:23 Water in the base pan, appliance leaking. Call customer service!

Maintenance



- Risk of scalding!
Allow detergent solution to cool down!
- Turn off the tap!



Detergent-solution pump

Set programme selector to **Off**, pull out the mains plug.

1. Open and remove service flap.
2. For models with drainage hose:
Take drainage hose out of the holder and pull out of the housing.
Remove sealing cap, allow detergent solution to flow out.
Press on sealing cap and insert drainage hose into the holder.
- 2* For models without drainage hose:
Carefully unscrew pump cover until the detergent solution begins to run out.
When the service flap is half full, screw back the pump cover and empty the service flap.
Repeat steps until all the detergent solution has run out.
3. Carefully unscrew the pump cover (residual water).
4. Clean the interior, pump cover thread and pump housing (fan impeller in the detergent-solution pump must rotate).
5. Reinsert and screw on pump cover.
6. Insert and close service flap.

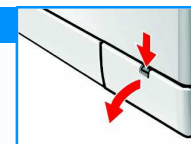

To prevent unused detergent from flowing into the outlet during the next wash:
Pour 1 litre of water into dispenser II and select the **Drain** (🌀) programme.



Drainage hose at the siphon

Set programme selector to **Off**, pull out the mains plug.

1. Loosen the hose clamp, carefully remove the drainage hose (residual water).
2. Clean the drainage hose and siphon connecting piece.
3. Reattach the drainage hose and secure the connection with the hose clamp.

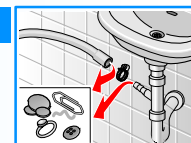

Filters in the water supply

Release water pressure in the supply hose:

1. Turn off the tap!
2. Select any programme (except **Spin** (🌀)/**Drain** (🌀)).
3. Press **Start/Pause** (⏸). Leave programme for approx. 40 seconds.
4. Set programme selector to **Off**.
5. Remove hose from tap.
6. Clean filter with small brush.
7. Depending on the model, remove hose from the rear of the appliance and clean the filter.
8. Connect the hose and check for leaks.

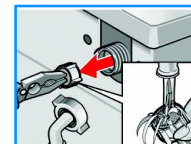

What to do if ...

- Water is running out.
 - Correctly attach/replace drainage hose.
 - Tighten screw-fitting on the supply hose.
- Water not flowing in.
Detergent not washed in.
 - **Start/Pause** ◀ not selected?
 - Tap not open?
 - Filter blocked? Clean filter → *page 10*.
 - Supply hose kinked or jammed?
- Washing machine door cannot be opened.
 - Safety function active. Wait approx. 2 minutes.
 - ☐ (without final spin) selected?
- Programme does not start.
 - **Start/Pause** ◀ selected?
 - Door closed?
- Detergent solution is not drained.
 - Clean detergent-solution pump → *page 10*.
 - Clean outlet pipe and/or drainage hose.
- Washing not spun correctly.
 - Distribute small and large items of washing in the drum.
- Spin cycle actuated several times.
 - Not a fault – unbalanced load detection system adjusts imbalance.
- Water not visible in the drum.
 - Not a fault – water below the visible area.
- Residual water in the dispenser for care product.
 - Not a fault – effect of the care product not impaired.
- Odour formation in the washing machine.
 - Run **Cottons 90 °C** programme without washing. Use standard detergent.
- Foam is coming out of the detergent drawer.
 - Too much detergent used?
Mix 1 tablespoon of fabric softener with ½ litre of water and pour into compartment II (*not with outdoor fabrics!*).
 - Reduce detergent dosage for the next wash cycle.
- Vibrations during spin cycle.
 - Appliance feet fixed?
Secure appliance feet → *Installation instructions*.
 - Transportation safety devices removed?
Remove transportation safety devices → *Installation instructions*.
- Spin result not satisfactory.
 - **Easy-Iron** ☐ selected ? → *page 5*.
- Display panel/indicator lights do not function while the appliance is running.
 - Power failure?
 - Fuse tripped? Switch on/replace fuse.
 - If the fault occurs repeatedly, call customer service.
- Programme progress longer than usual.
 - Not a fault – unbalanced load detection system adjusts imbalance by repeatedly distributing the washing.
 - Not a fault – Foam detection system active - a rinse cycle is started.
- Detergent residue on the washing.
 - Occasionally phosphate-free detergents contain water-insoluble residue.
 - Select **Rinse/Freshen Up** ☐ or brush the laundry after washing.
- If a fault cannot be rectified or a repair is required:
 - Set programme selector to **Off** and pull out the mains plug.
 - Turn off the tap and call customer service → *Installation instructions*.

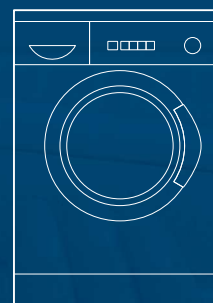

Washing machine en

Operating instructions



BOSCH



Read these instructions before switching on the washing machine!
Also follow the separate Installation instructions.
Follow the safety instructions on page 8 !